

HLIÐARVEGGUR

SNID $V_1 - V_1'$
M=1:20

SNID $V_1 - V_1'$
M=1:20

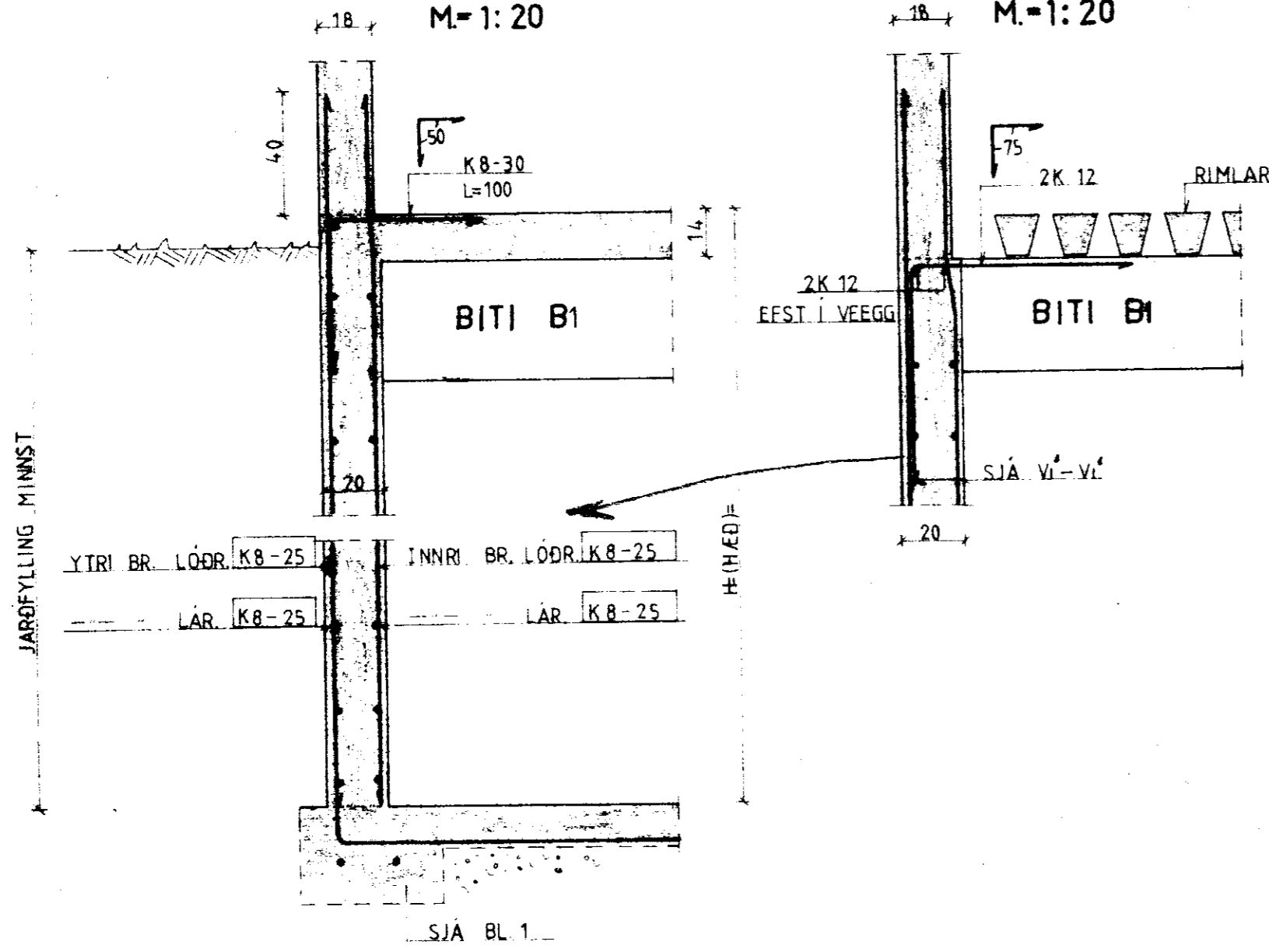

GÆL NÆST HLÖÐU

SNID $V_3 - V_3$
M=1:20

SNID $V - V$
M=1:20

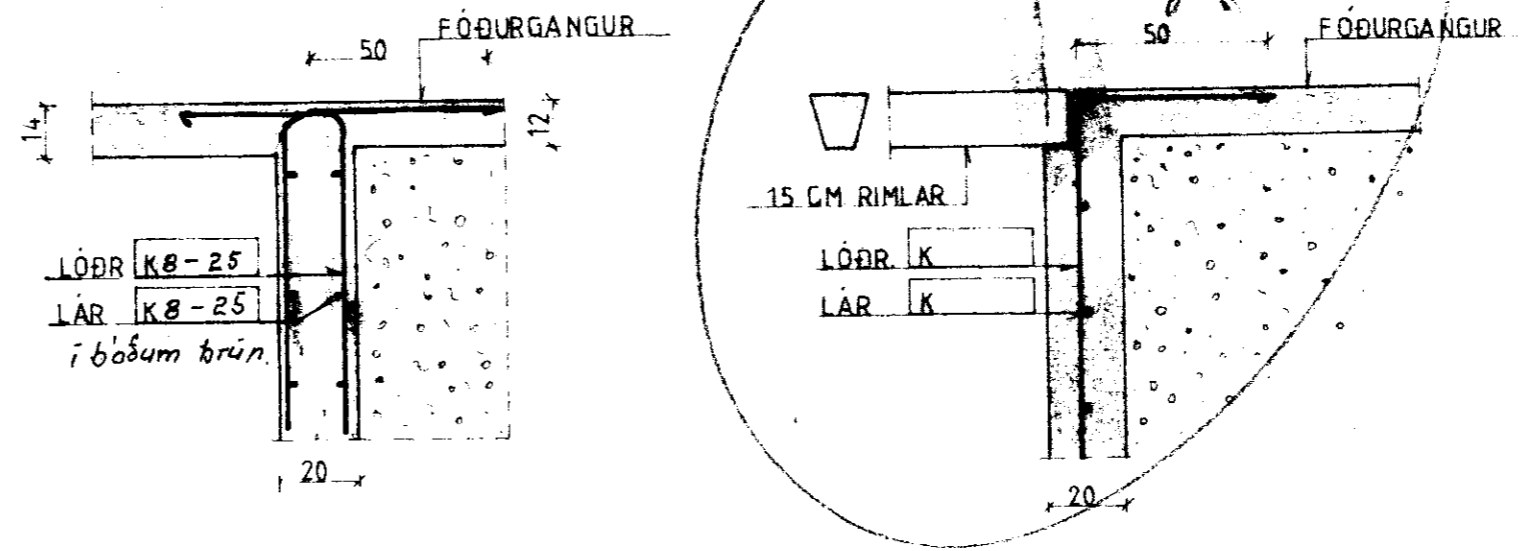

HORN

LÁRÉTT SNID
M=1:20

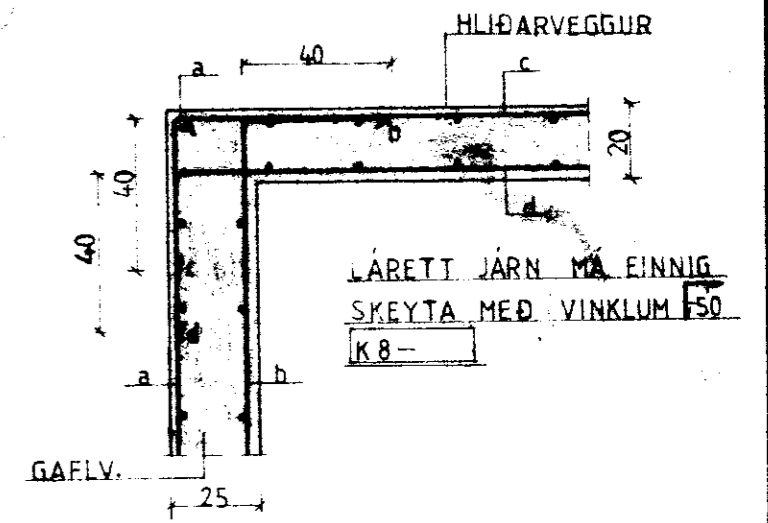

GÆLVVEGGUR

SNID $V - V$
M=1:20

SNID $V_3 - V_3$
M=1:20

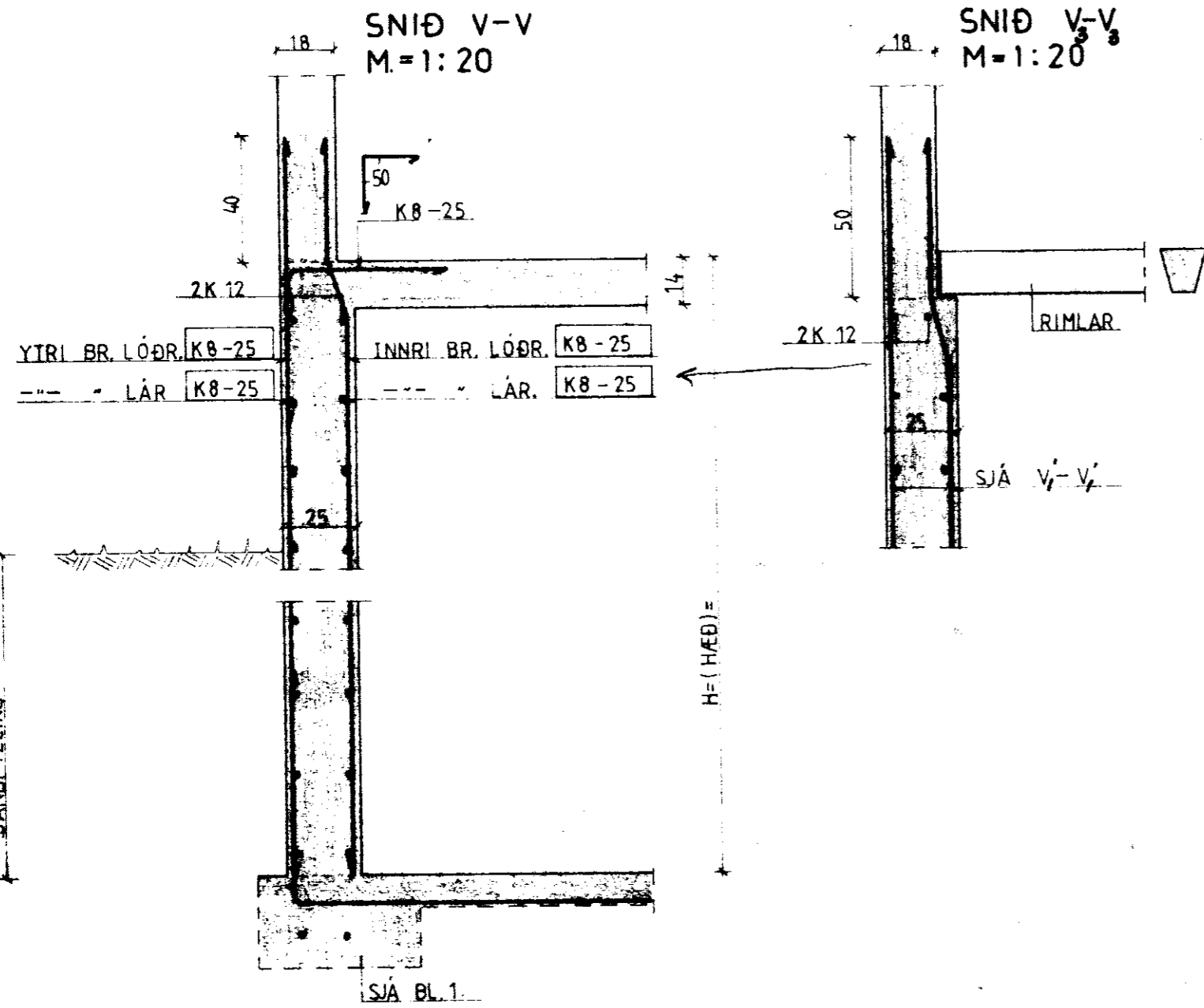

STEINSTEYPA S=200 (ÞLÖNDUN 1:35-1:4)
 STEYPUÞYKKT UTAN JÁRNA:
 PLÖTUR OG VEGGIR 20-25 mm
 BITAR 30
 STÖÐIR 50

BL 10- 5264 STÓRI NÚPUR, GNÚPVERJAHN. ÁRN.			
BL BYGGINGASTOFNUN LANDBÚNAÐARINS (S. 25444)			
HAUGHÚSVEGGIR		Mashtv.	Reikn.
JARÐF AD ÖLLUM VEGGJ.		1:20	Tolkn. G.N.
			Sandp.
Reykjavík, JÚNÍ, 1987.		Verkefni nr.	
<i>Sig. Sigvaldsson</i>		B3	
		Breytingar	