

Ásýnd langhlíð Mkv. 1:75

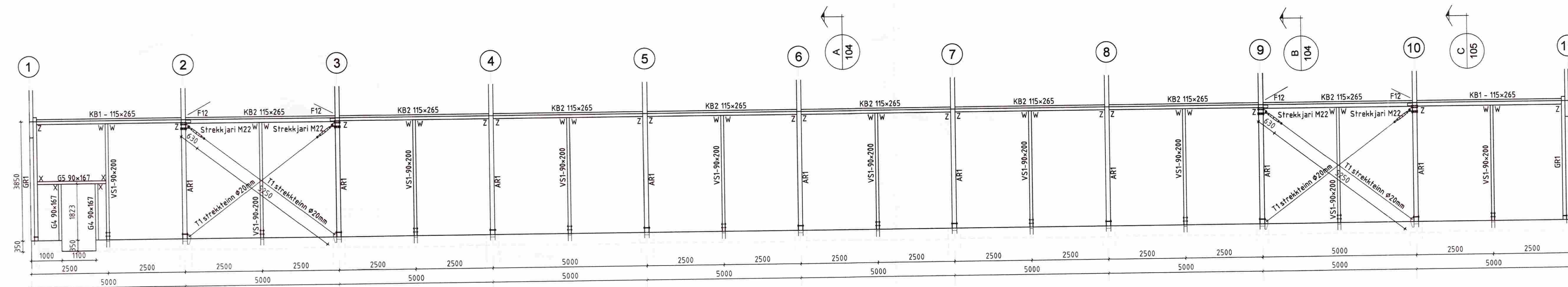

Ásýnd langhlíð Mkv. 1:75

Sérmynd 20 Mkv.: 1:10

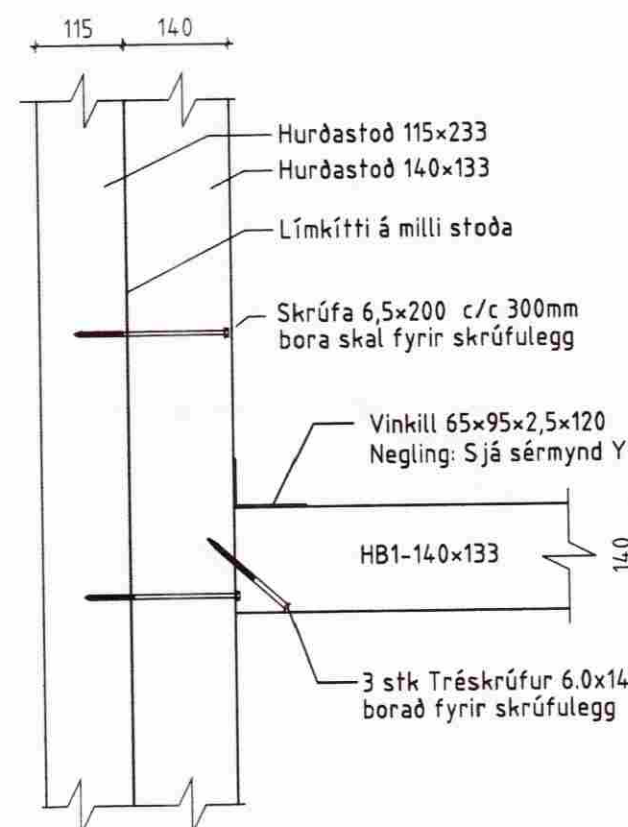

X - BMF-105 vinklar án st.

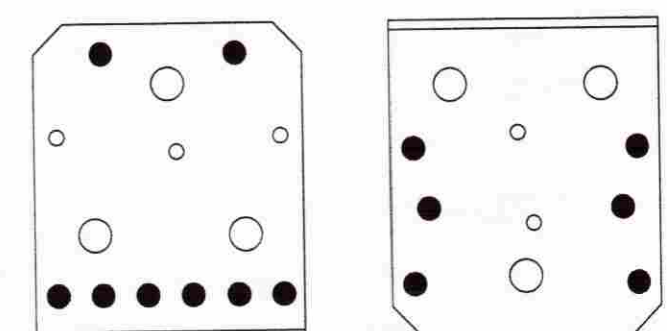

Negling í súlu/bita (fjarri enda) 8 stk 40/50 kamsaumur

Negling í súlu/bita (nærri enda) 6 stk 40/50 kamsaumur

Þar sem bit/stöð kemur að hurð eða glugga skal setja 2 stk tréskrúfur 6.0x14.0mm bora skal fyrir skrúfulegg

Sérmynd 21 Mkv.: 1:10

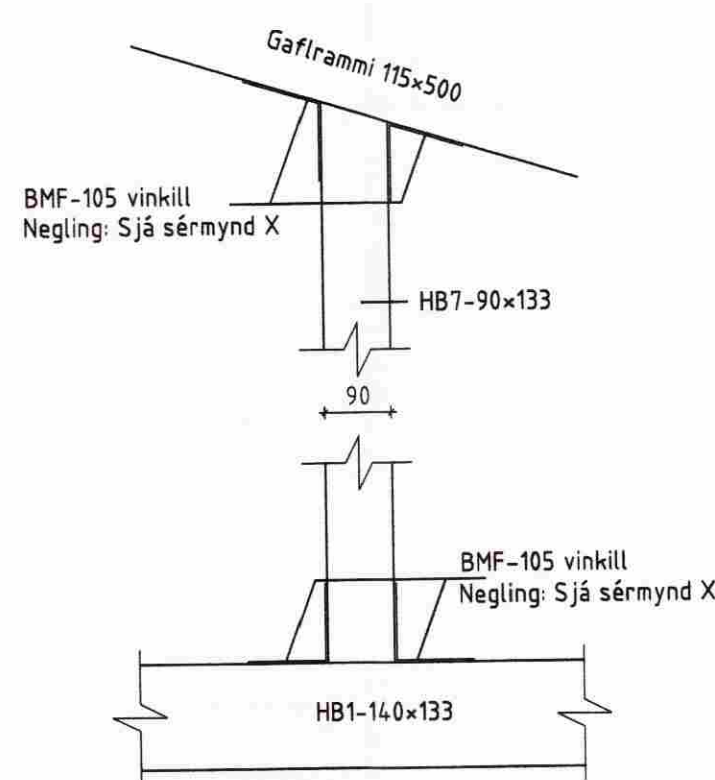

T - BMF-90 vinklar án st.

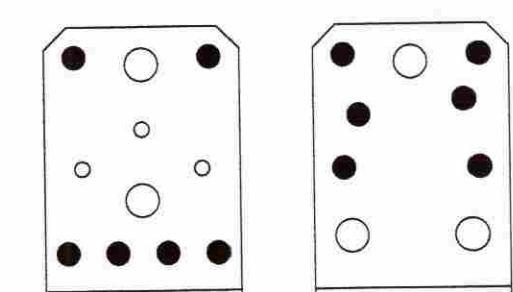

Negling í súlu/bita (fjarri enda) 6 stk 40/50 kamsaumur

Negling í súlu/bita (nærri enda) 6 stk 40/50 kamsaumur

Þar sem bit/stöð kemur að hurð eða glugga skal setja 2 stk tréskrúfur 6.0x14.0mm bora skal fyrir skrúfulegg

Sérmynd 22 Mkv.: 1:10

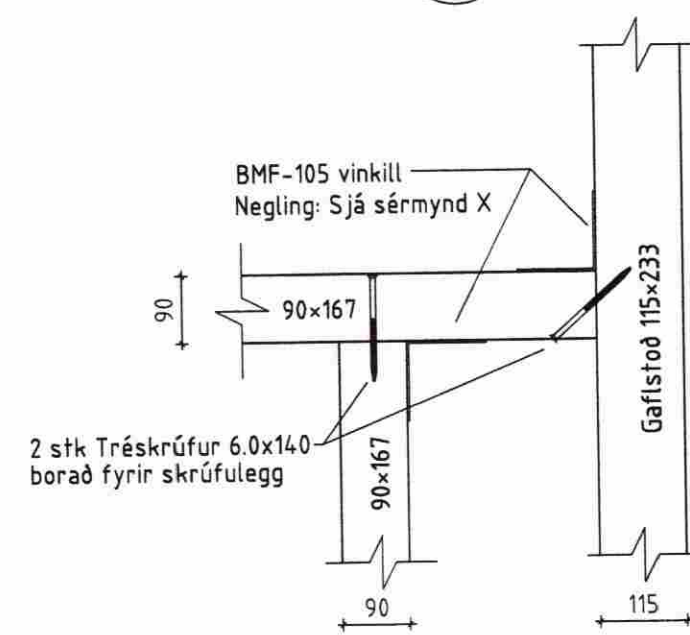

Sérmynd 23 Mkv.: 1:10

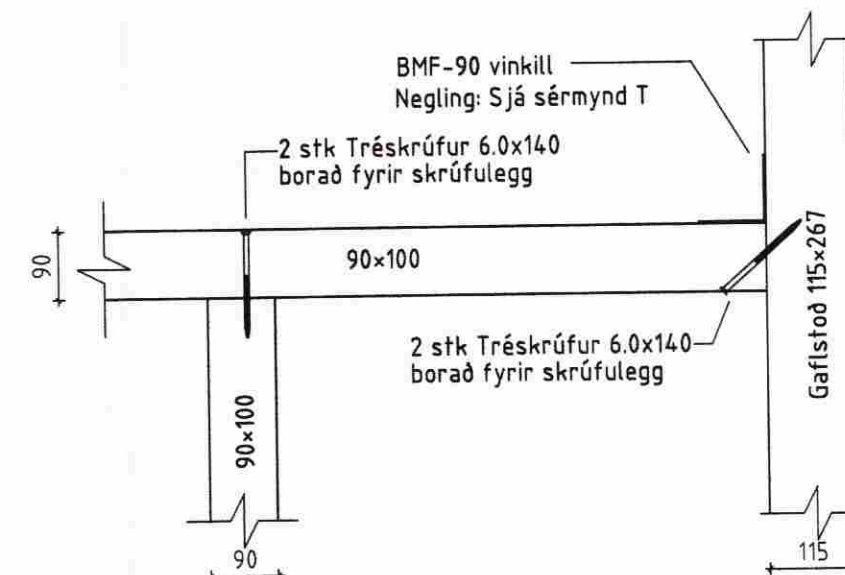

W - BMF-65x95x2,5x14.0 vinklar

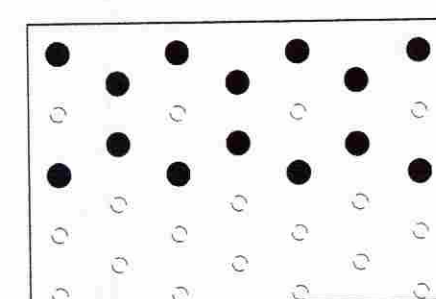

Negling í súlu/bita (nærri enda) 14 stk 40/50 kamsaumur

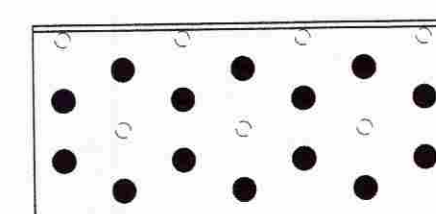

Negling í súlu/bita (fjarri enda) 14 stk 40/50 kamsaumur

Y - BMF-65x95x2,5x14.0 vinklar

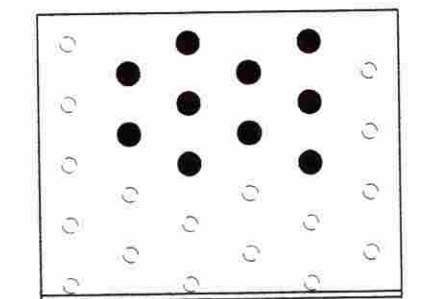

Negling í súlu/bita (nærri enda) 10 stk 40/50 kamsaumur

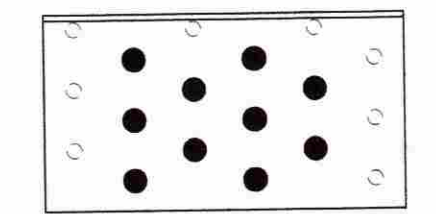

Negling í súlu/bita (fjarri enda) 10 stk 40/50 kamsaumur

Þar sem bit/stöð kemur að hurð eða glugga skal setja 3 stk tréskrúfur 6.0x14.0mm bora skal fyrir skrúfulegg

Sérmynd 24 Mkv.: 1:10

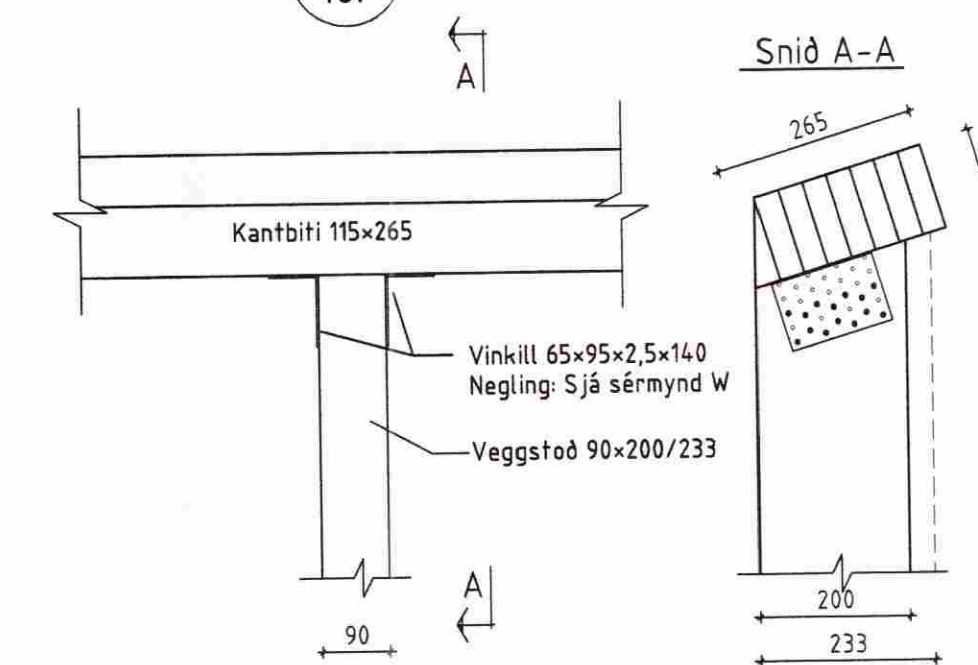

ÖLL AFNOT OG AFRITUN TEIKNINGAR AÐ HLUTA EÐA Í HEILD ER HÁÐ SKRIFLEGU LEYFI BM VALLÁ HF.

Númer	Dags	Skýring breytingar	Br. af
<p>Byggingasvið Stórhöfða 23, 110 Reykjavík kt. 530669-0179 Sími: 412 5000</p>			
MKV.	DAGS.	VERKNR.	ÚTGÁFA NR.
1:75, 1:10	28.01.2009	2008110005	1
TEIKN.	REIKN.	YFRF.	NR. TEIKNINGAR
KB	KB		107
<p>HEITI VERKS: Syðri-Gegnishólar, Selfossi</p>			
<p>HEITI TEIKNINGAR Reiðhöll Ásýnd langhlíða, sérmyndir</p>			
<p>ÁRITUN HÖNNUBAR Bjarni Ingibergsson byggingatæknifræðingur B.Sc. kt. 030861-2729</p>			<p>DAGS. ÁRITUNAR 17/2 09 19/2 09</p>
<p>ÁRITUN SAMHEM. HÖNNUBAR [Signature]</p>			
<p>REIÐHÖLL-S-GEGNISHÓLUM-101.dwg</p>			