

Koparvír tengist kopartein 120 sm sem rekinn er niður í mold

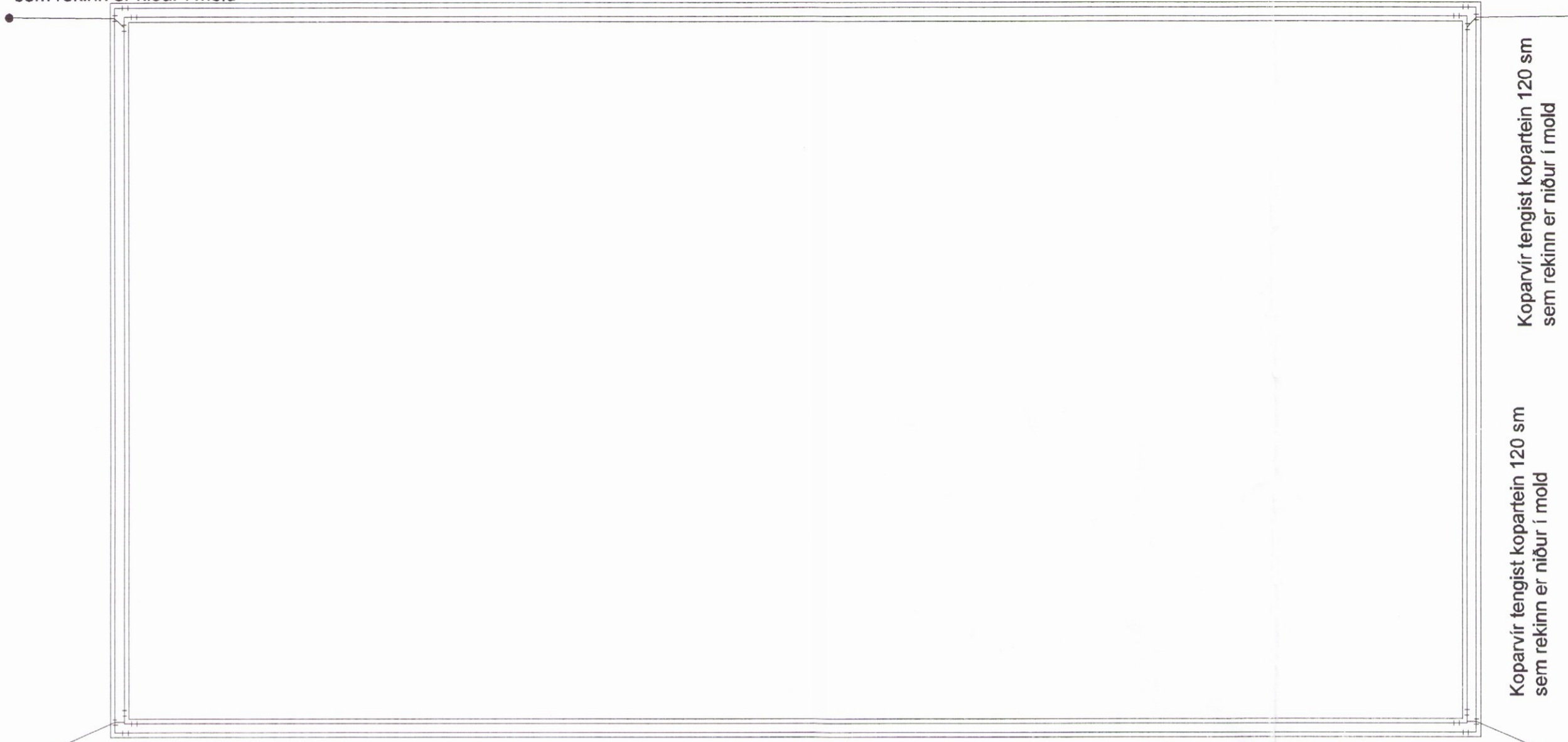

Koparvír tengist kopartein 120 sm sem rekinn er niður í mold

Grunnmynd sökkulvegga 1 : 50

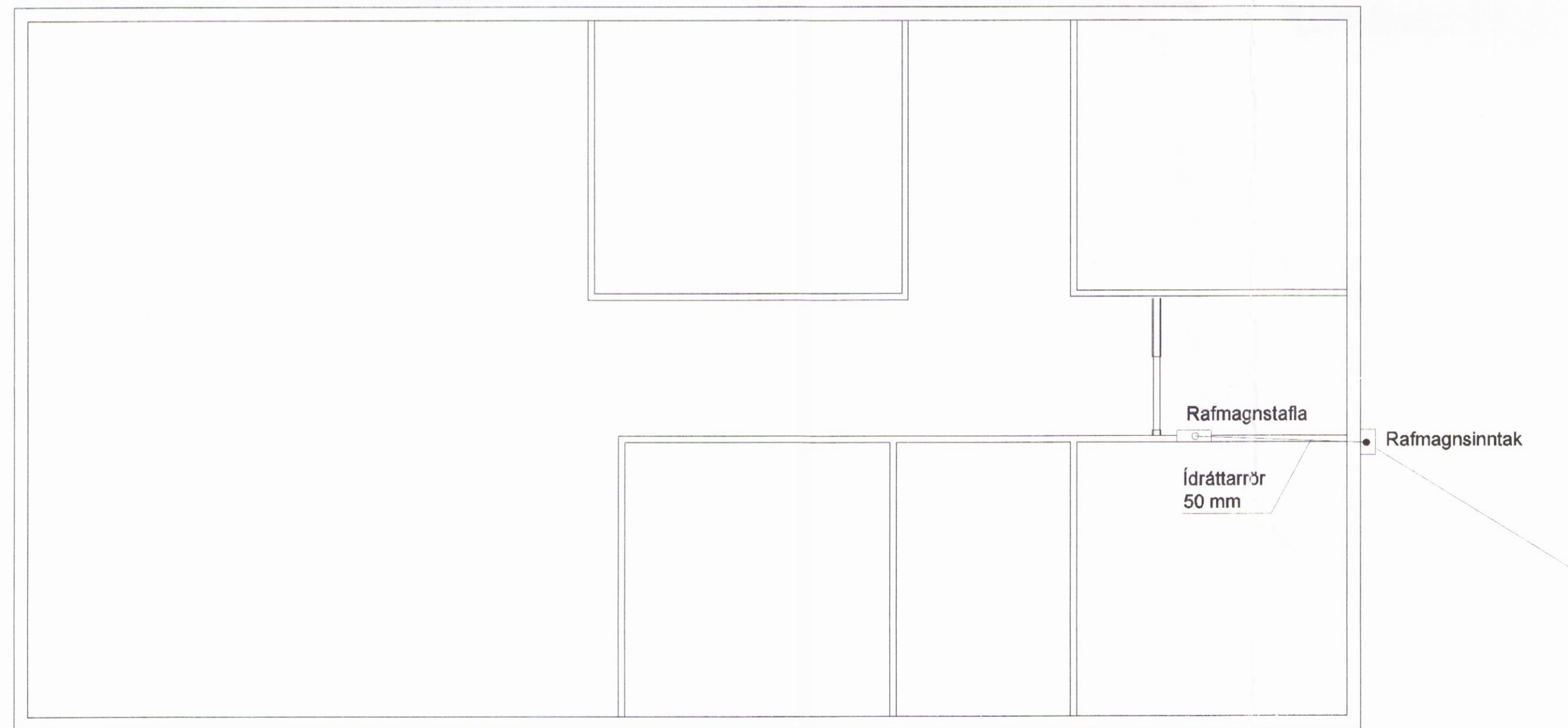

Grunnmynd hús, rafmagnsinntak og tafla 1 : 50

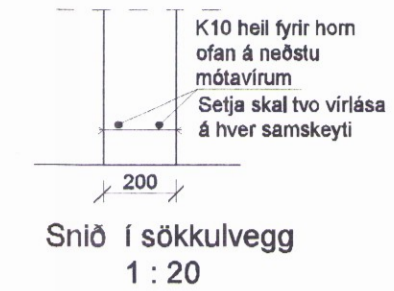

Skipulags- og byggingarfulltrúi Uppsveita bs.
Yfirfarið
06. feb. 2017
Byggingarfulltrúi

gr. 1	16 A	3x4q	20 mm	Eldavél / helluborð
gr. 2	16 A	3x2.5q	16 mm	Ofn
gr. 3	16 A	3x2.5q	16 mm	Uppþvottavél
gr. 4	16 A	3x2.5q	16 mm	Órbylgjuofn
gr. 5	16 A	3x2.5q	16 mm	Þvottavél
gr. 6	16 A	3x2.5q	16 mm	Purkari
gr. 7	10 A	3x1.5q	16 mm	Eldhús/stofa
gr. 8	10 A	3x1.5q	16 mm	Herbergi/gangur
gr. 9	10 A	3x1.5q	16 mm	Bað/þvottur
gr. 10	10 A		16 mm	Laust
gr. 11	10 A		16 mm	Laust
gr. 12	10 A		16 mm	Laust
gr. 13	10 A	3x1.5q	16 mm	Útljós
gr. 14	10 A	3x1.5q	16 mm	Útljós
gr. 15	16 A	3x2.5q	20 mm	Pottur
gr. 16	16 A	3x2.5q	16 mm	Útitengill
gr. 17	10 A	3x1.5q	16 mm	Dæla - gólfhiti
gr. 18	10 A		16 mm	Laust
gr. 19	10 A		16 mm	Laust
gr. 20	10 A		16 mm	Laust
gr. 21	16 A		16 mm	Laust
gr. 22	16 A		16 mm	Laust

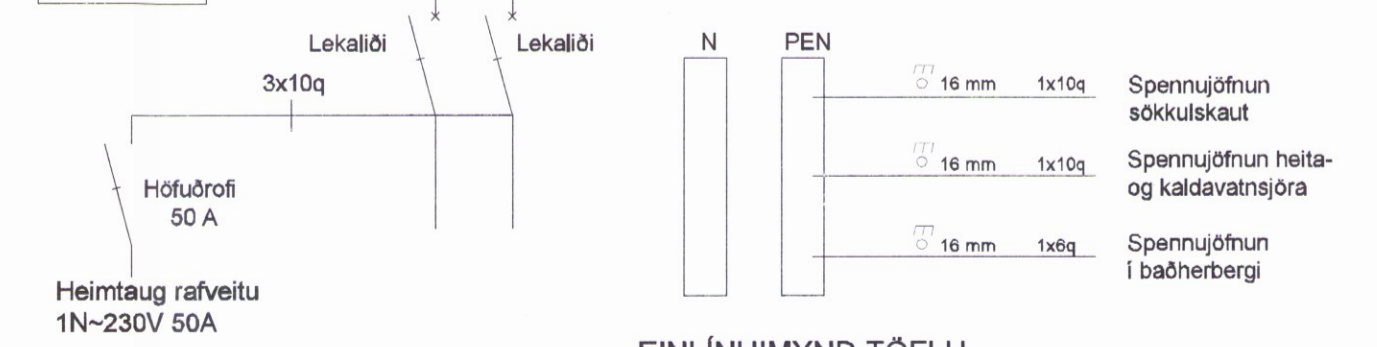
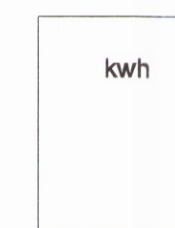

EINLÍNUMYND TÓFLU

Stekkatún 1, Bláskógabyggð	Blaðst A2
Landnr 194642, Matshl 3	7
Rafmagn, sökkjar, inntak og einlínunmynd	Dagsetn: júlí 2016
	Mælikvarði: 1 : 50