

Krossviður 9mm  
 Negling: GN 3.1/90 c/c150  
 Timburgrind 45x145

### Samsetning veggja

1 : 10

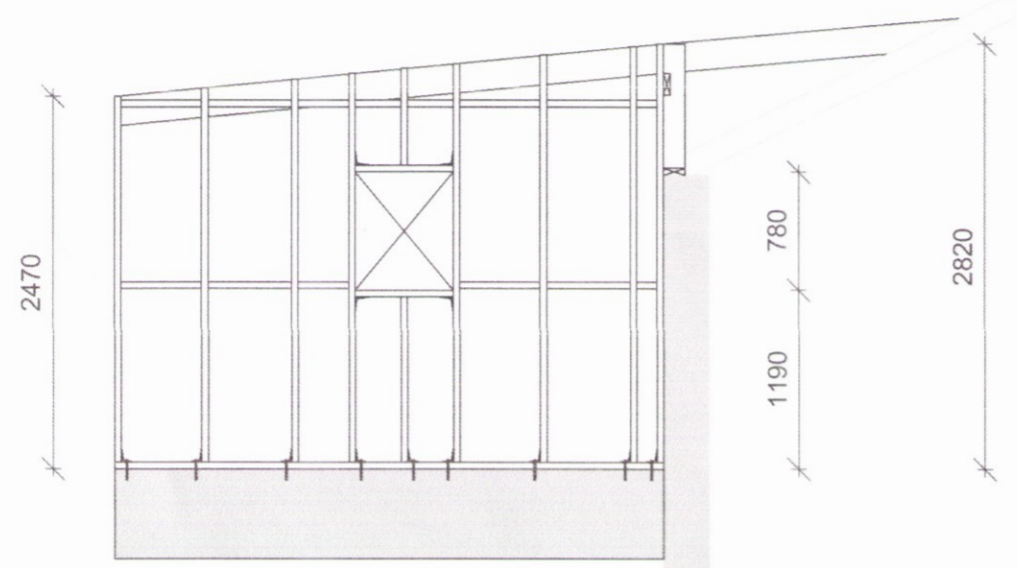

Borðaklæðning 25x150  
 Neglist með galv. c/c200

Festing  
 M10x120 í hverja stoð

45x195 c/c600

45x145  
 Felld inn í stoð

Festing  
 M10x120 í hverja stoð

Krossviður 9mm

Vinkill BMF 90 m/styrk  
 Negling: 2x6stk. K40/40

Fótstykki  
 Tjörupappi skal settur milli trés og steins.  
 Neglist með M10-130mm múrbolta c/c600

Gaffalankeri 45x320  
 Negling: 2x6stk. Ks40/40

### Festing þaksperra

1 : 10

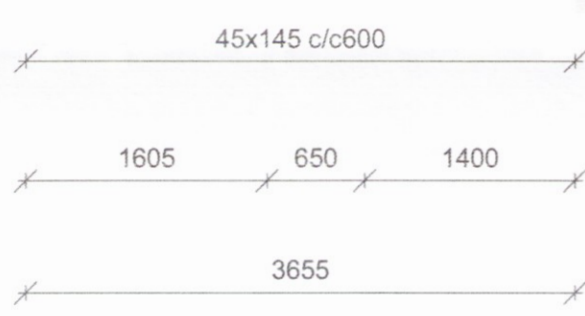

Vinkill BMF 90 m/styrk  
 Negling: 2x6stk. K40/40

Vinkill BMF 90 m/styrk  
 Negling: 2x6stk. K40/40  
 Innsteyptur bolti M12c/c600  
 skinna að tré 40x40x4

### Festingar

1 : 10

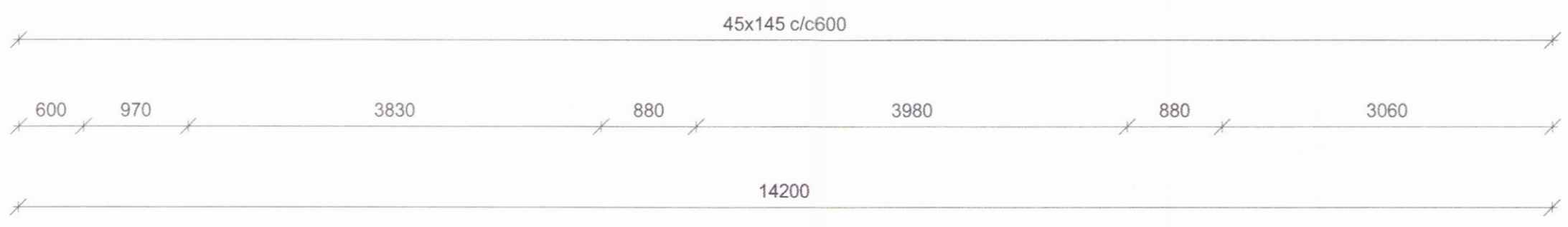
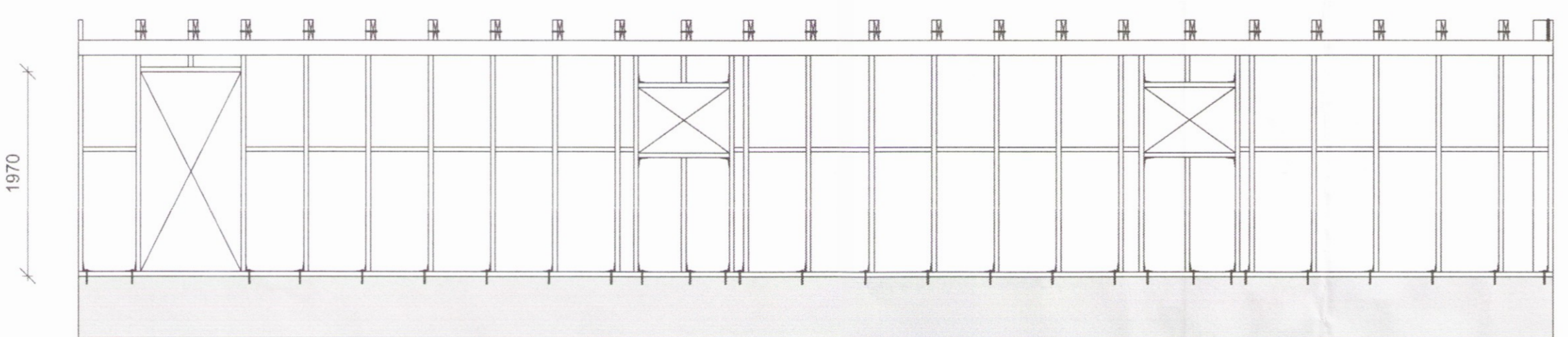

### Viðbygging- Útlit

1 : 50

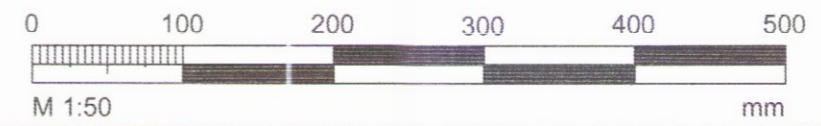

ADALHÖNNUÐUR

Útg.	Dags.	Skýring	Br.af:	Yfirf.
------	-------	---------	--------	--------



Sólheimar  
 845 Flúðir

Burðarvirki  
 Útlit og festingar

TEIKNINUMER	BLADSTÆRD	HANNAÐ:
5283-001	A2	TEIKNAD: JS
XX_1_30_02		YFIRFARID: GH
DAGS.	MÆLIKVARÐI	ÚTGÁFA
10.04.2017	1:50/1:10	A

SAMÞYKKT: *[Signature]*  
 KENNITALA: Guðmundur Hjaltason Kt: 070966-5579