

Skipulags- og byggingarfulltrúi Úppsveita bs.  
**Yfirfarið**  
 11. maí 2017  
*Ph. Steinhilf*  
 Byggingarfulltrúi

ADALHÖNNUÐUR

ÚTG. DAGS. ÚTGÁFUFRILL HANNAÐ TEIKN. YFIRF.

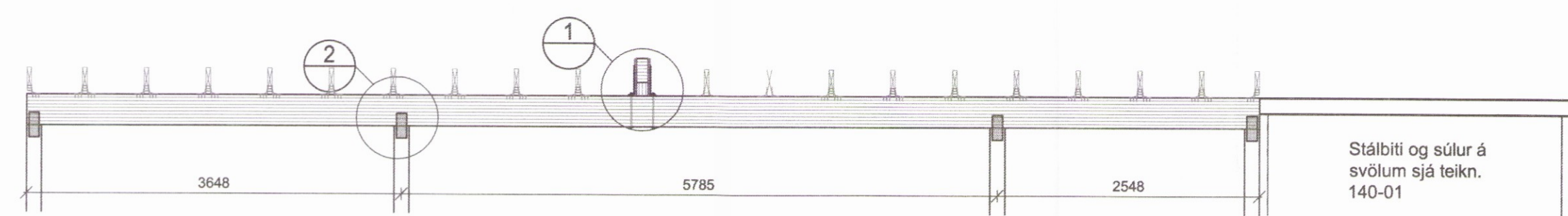

**Límtrébiti B1 og B2 115x267**  
M 1:50

Stálbiti og súlur á svólum sjá teikn. 140-01

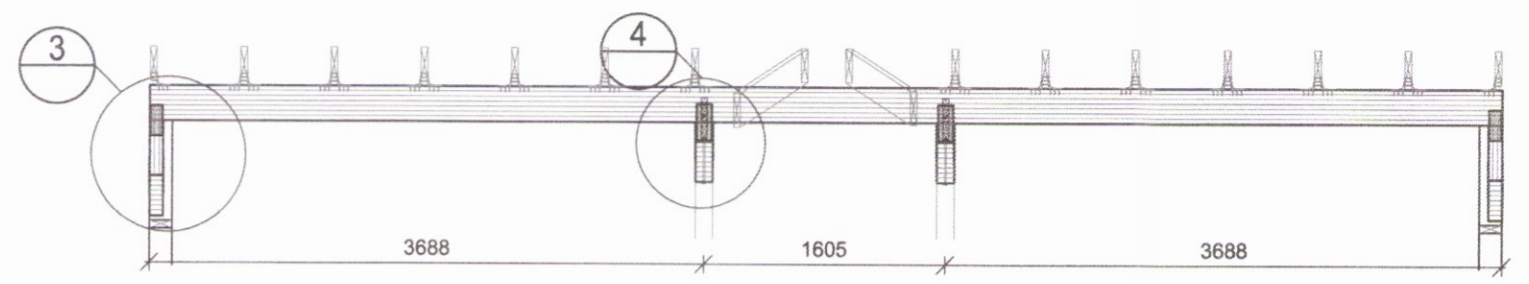

**Límtrébiti B3 115x233**  
M 1:50

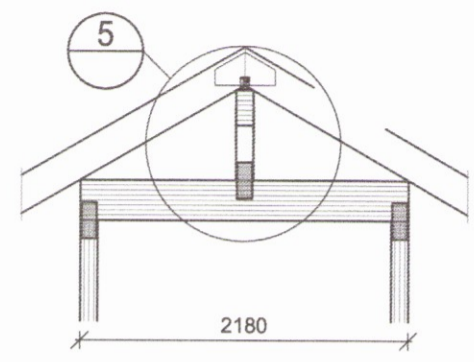

**Límtrébitar B4 og B5 90x267**  
M 1:50

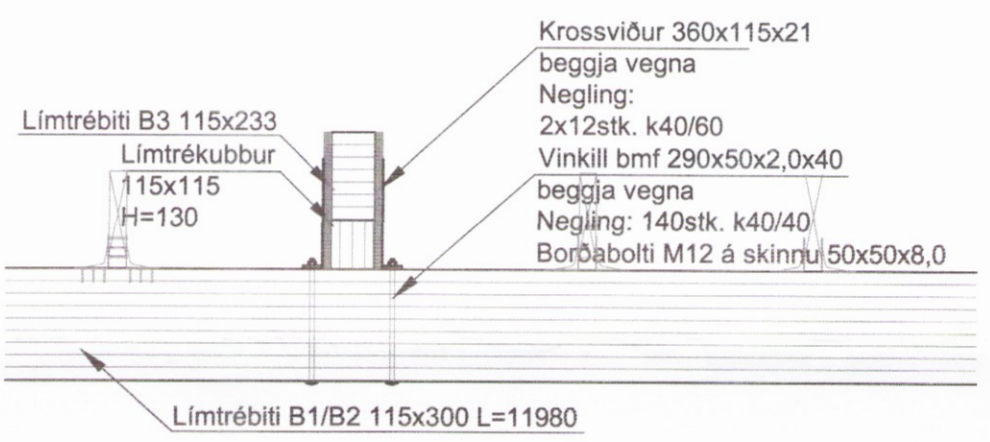

**1 Deili**  
M 1:20

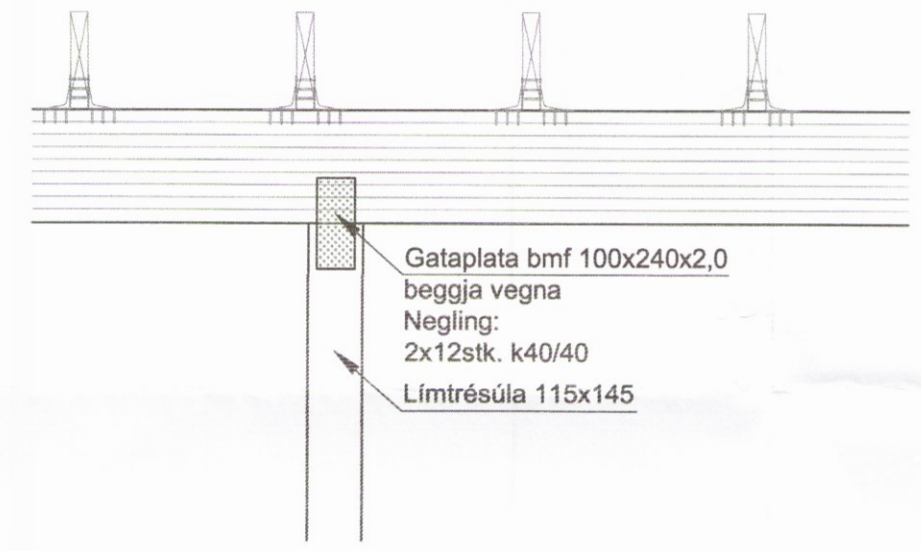

**2 Deili**  
M 1:20

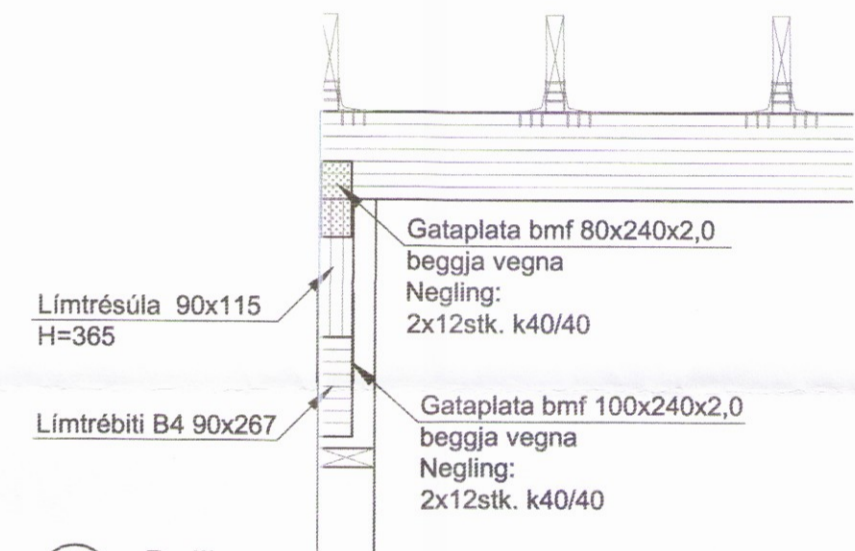

**3 Deili**  
M 1:20

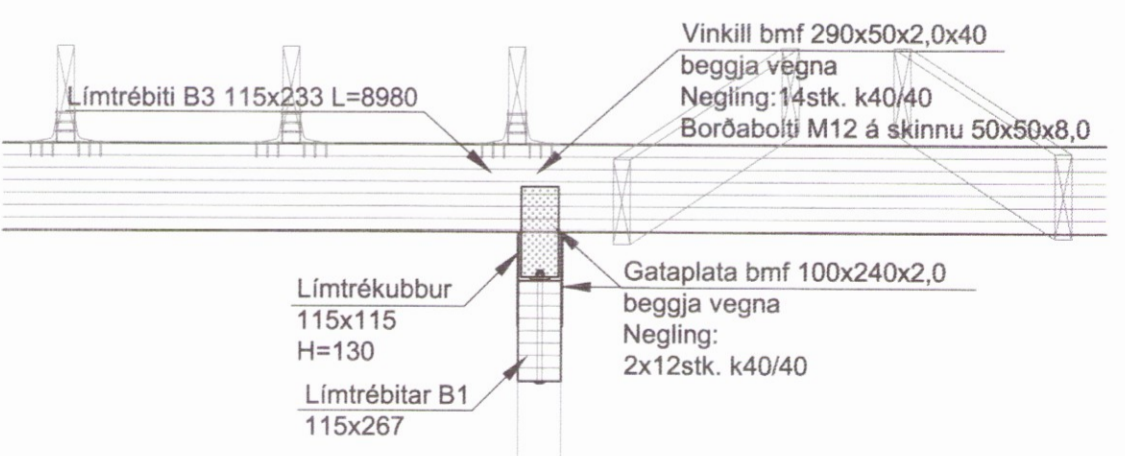

**4 Deili**  
M 1:20

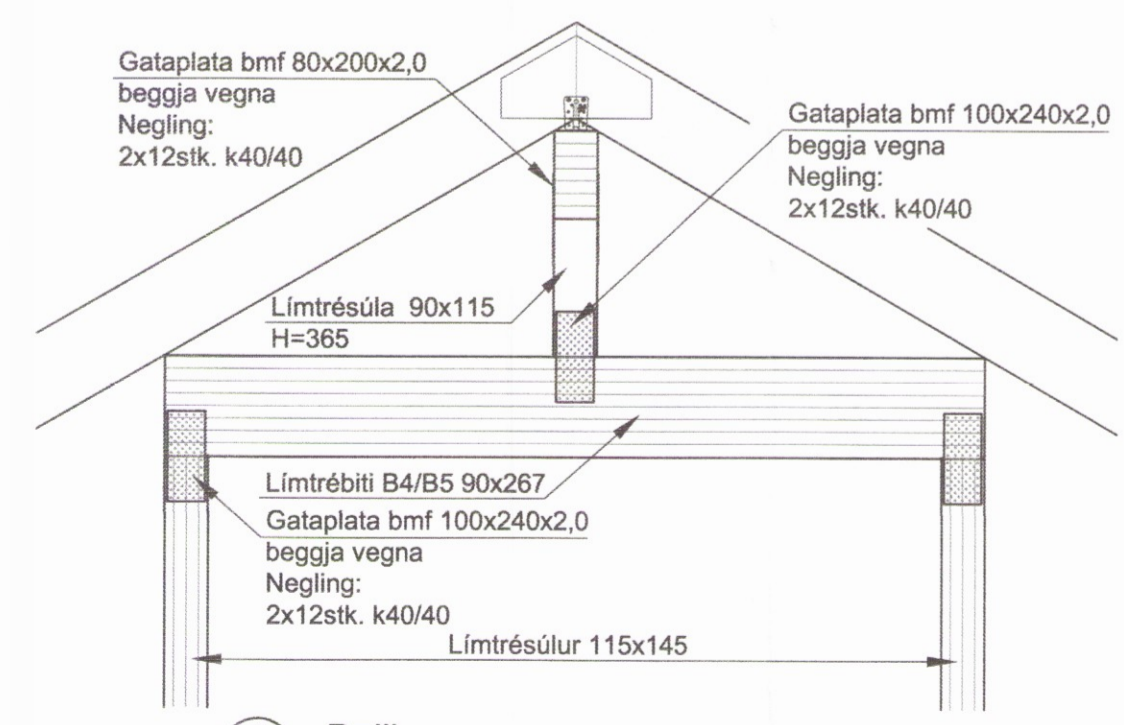

**5 Deili**  
M 1:20

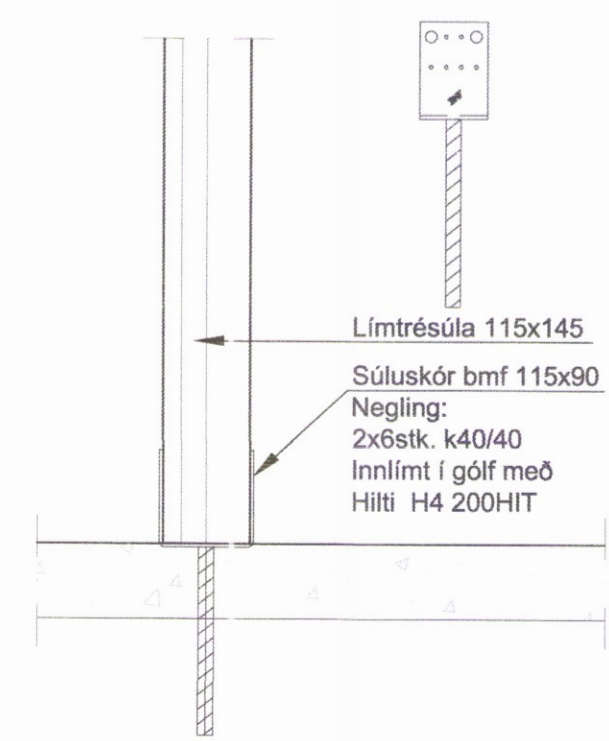

**Festing súlu við gólf**  
M 1:10

Ath.  
Öll mál athugist á staðnum.

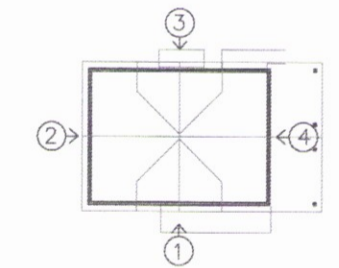

LYKILMYND

**EFLA**  
 VERKFRÆÐISTOFA  
 Sími: 412 6000 www.efla.is

**Skeiðhólt, 801 Selfoss**  
 Skeiða- og Gnúpverjahreppi  
 Íbúðarhús breyting

Burðarvirki - timbur

Límtrébitar  
 Snið og deili

TEIKNINÚMÉR	BLADSTÆRD	HANNAÐ	GH
6286-001	A2	TEIKNAD:	SST
- 130-03		YFIRFARIÐ:	GH

DAGS.	MELIKVARDI	ÚTGÁFA
24.11.2016	1:50/1:20	<b>A</b>

SAMBÝKKT *Guðmundur Hjaltason*  
 Kennitala: Guðmundur Hjaltason kt. 070966-5579