

Umhverfis- og tæknisvið Uppsveita
Yfirfarið
 21. JUNÍ 2019
David Sj
 Byggingarfulltrúi

ADALHÖNNUBUR

Útg.	Dags.	Skýring	Br.af:	Yfirf.
B1	10.05.2019	Timbursúlu breytt í stálsúlu	JS	GH

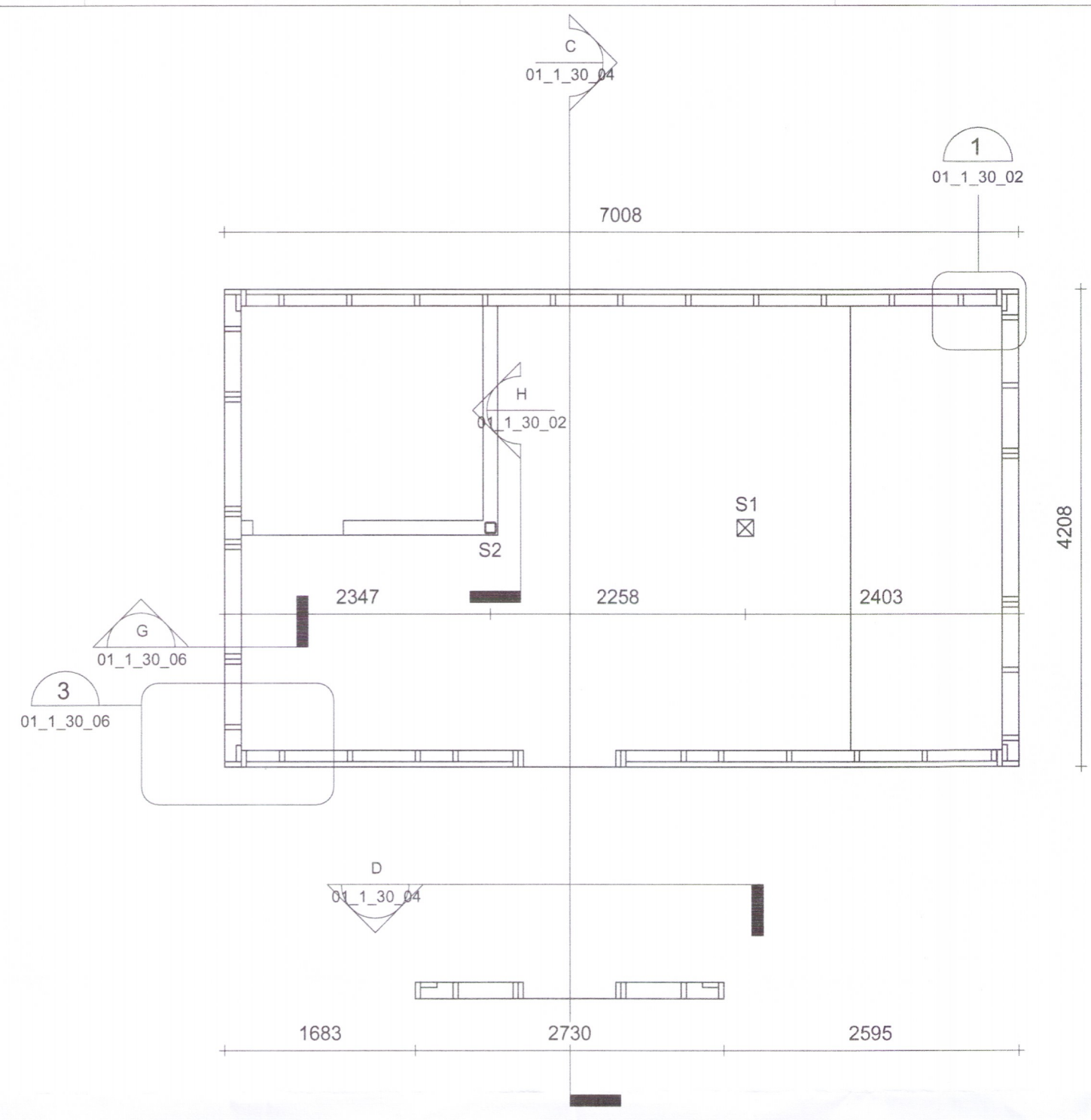

Grunnmynd veggjagrinda
 1 : 50

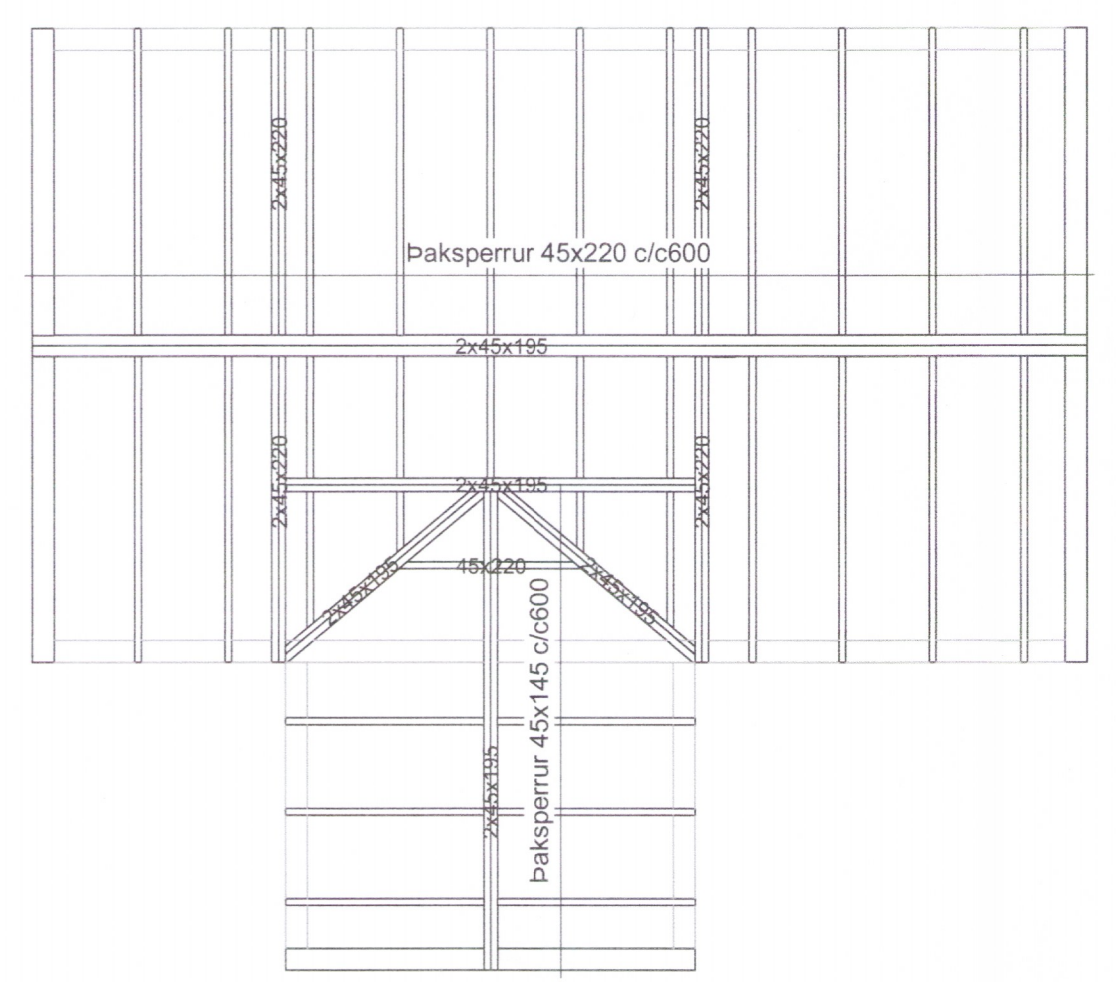

Þaksperruplan
 1 : 50

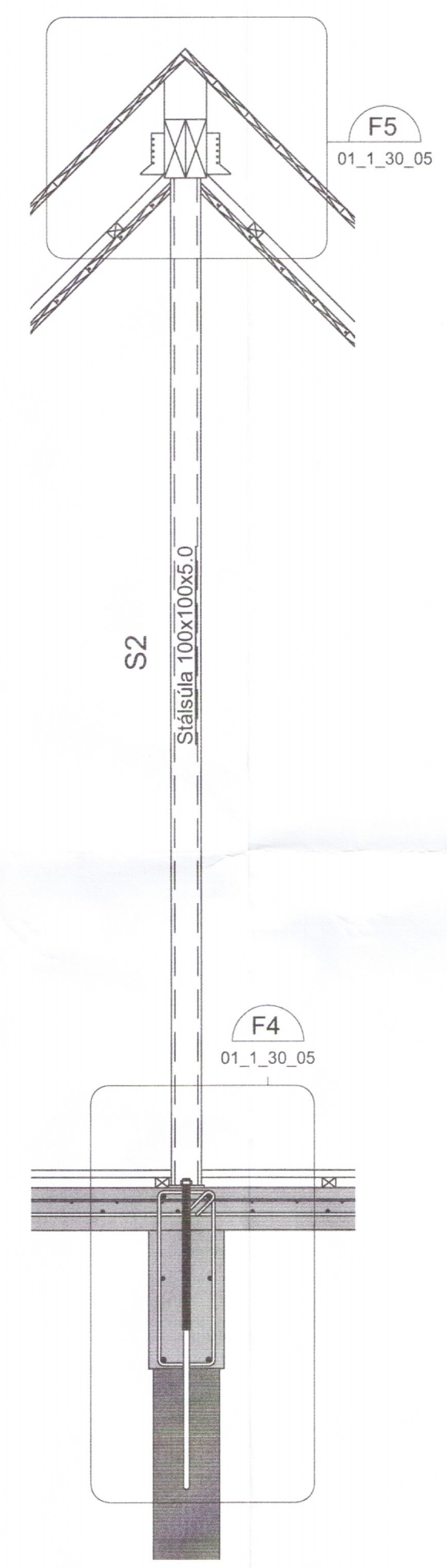

Snið H
 1 : 20

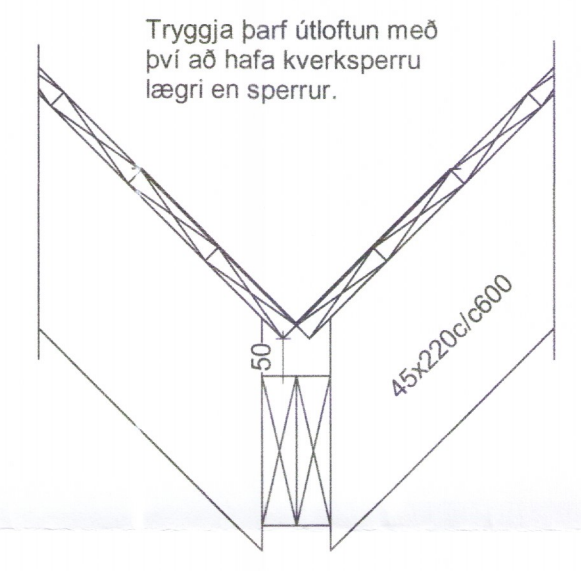

Kverkbiti
 1 : 10

Samsætning veggveinga
 Negling: GN 28/75 c/c150

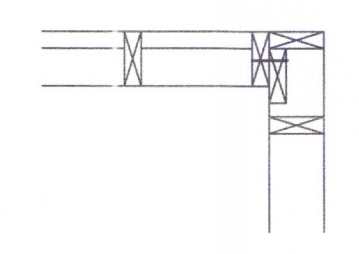

1 Deili 1
 01_1_30_02 1 : 20

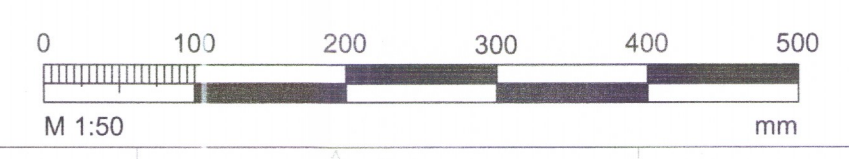

EFLA
 VERKFRÆÐISTOFA
 sími 412 6000 www.efla.is

Árvegur 50- Kringla II
 801 Selfoss

Burðarvirki - Timbur
 Veggjagrindur og deili

2283-19

TEIKNINÚMUR	BLAÐSTÆRD	HANNAD:	UTGÁFA
7022-001	A2	TEIKNAD: JS	B1
01_1_30_02		YFIRFARID: GH	
DAGS:	MÆLIKVARÐI		
02.11.2017	1:20/1:50		
SAMPYKKT:	<i>Guðmundur Hjaltason</i>		
KENNITALA:	Guðmundur Hjaltason Kt: 070966-5579		

T:\801\Árvegur 48- Kringla II\7022-001 Árvegur 50- Kringla II- 2019.dwg