

GÓLF M.K. 1/50

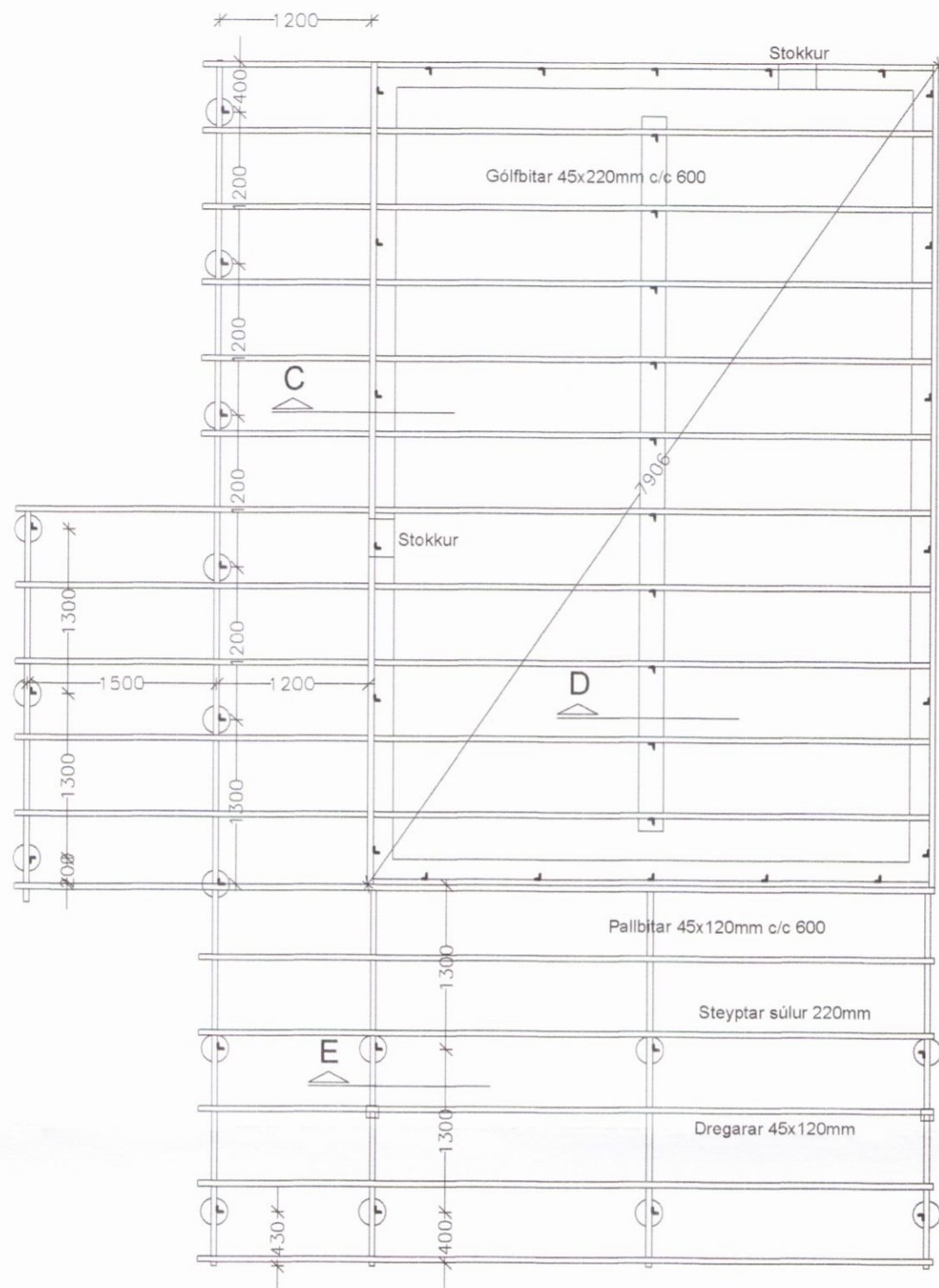

ÞAK M.K. 1/50

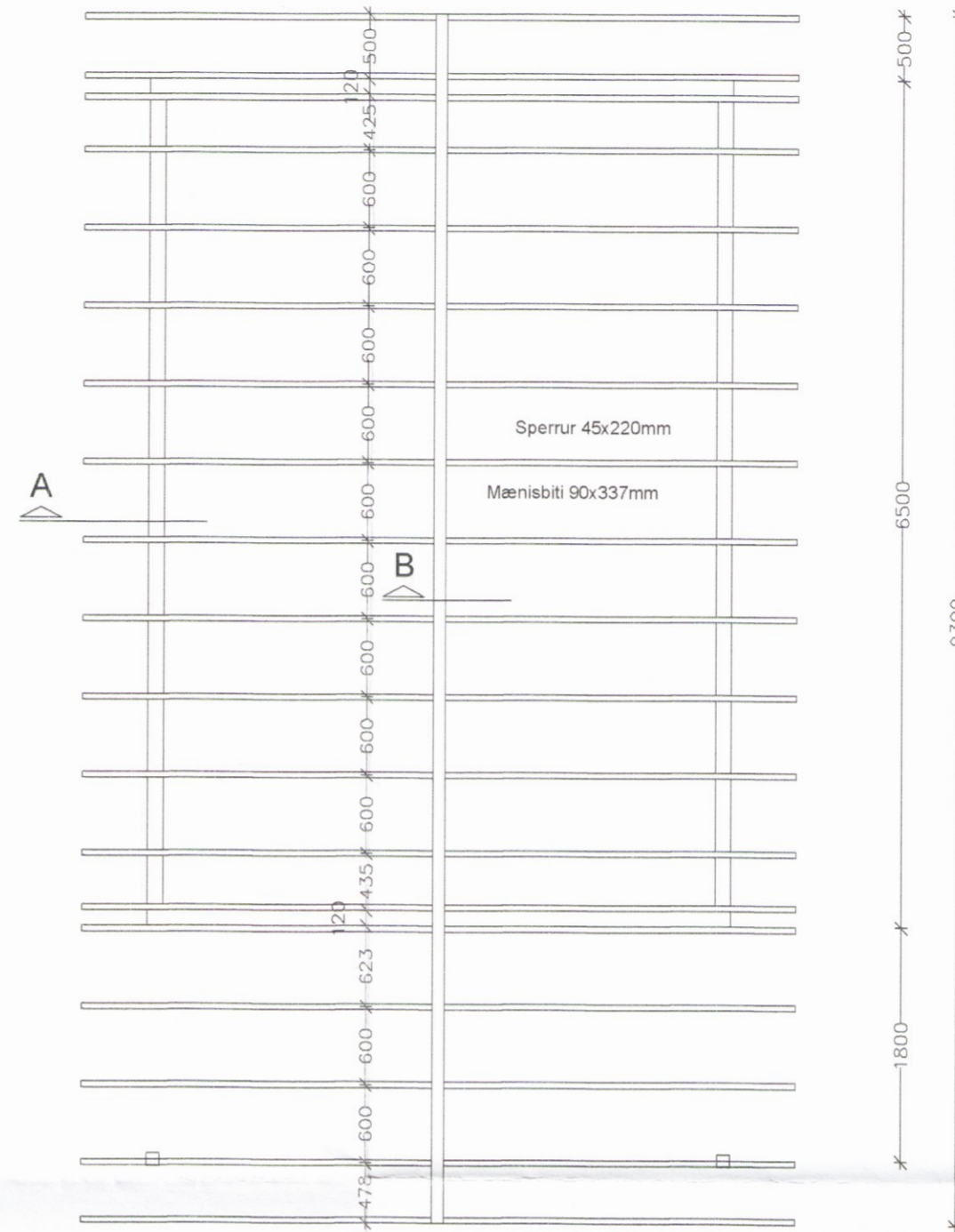

SNIÐ M.K. 1/50

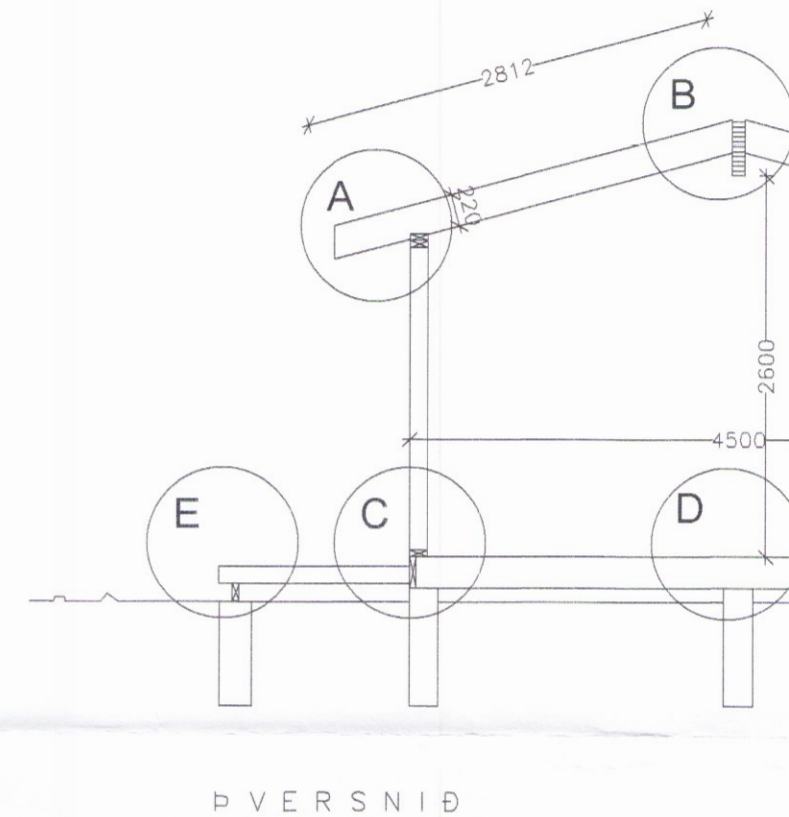

SNIÐ A-A  
sperrur við útv.

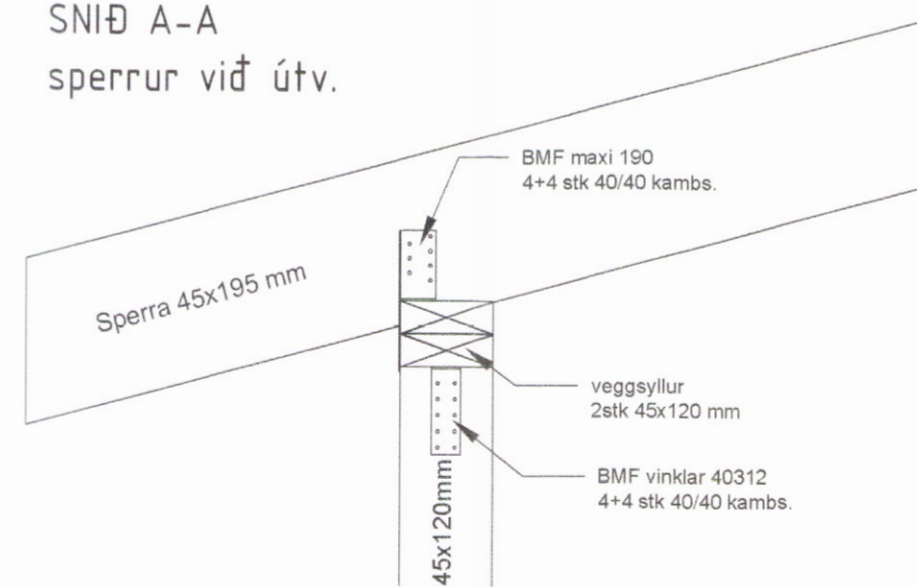

SNIÐ B-B  
mænisir

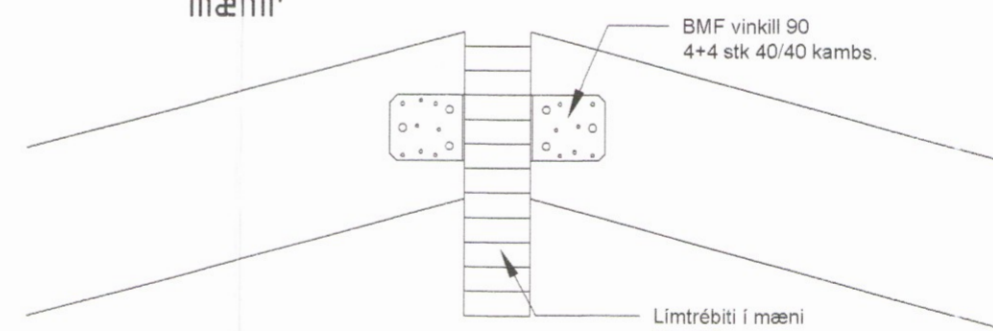

SNIÐ E-E  
súlur undir palli

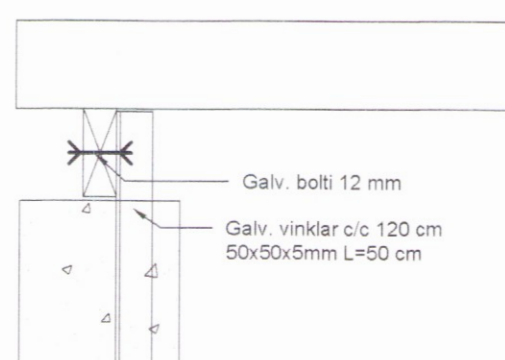

SNIÐ C-C  
gólf við útv.

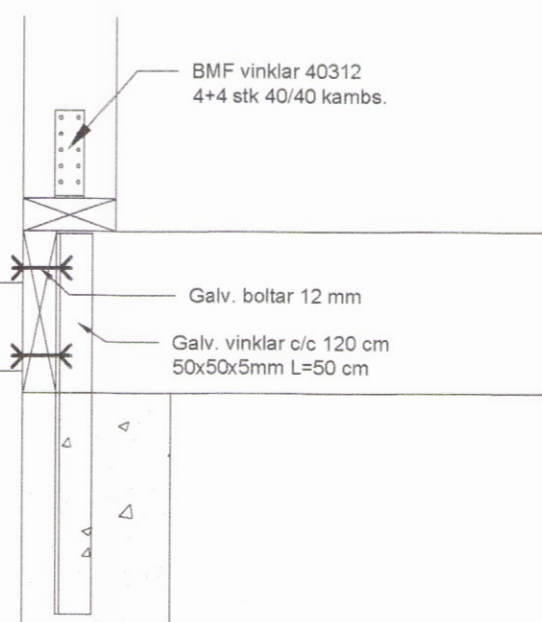

SNIÐ D-D  
gólf við millisökkul

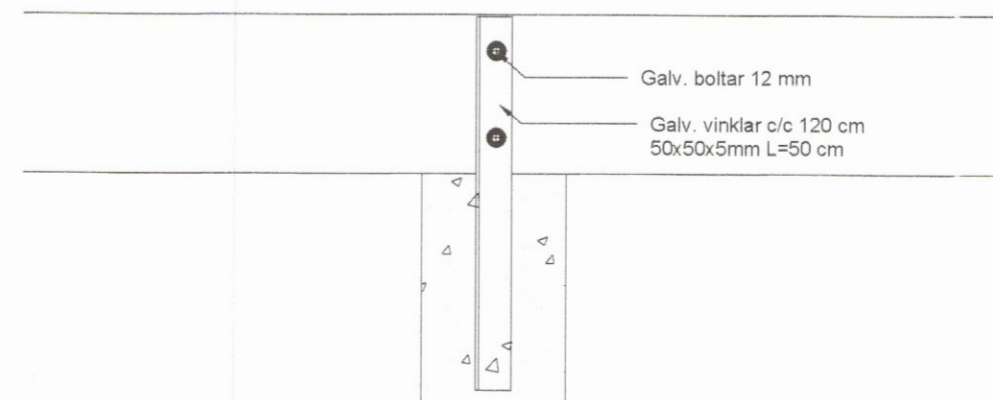

SKÝRINGAR:

Undirstöður eru steypar súlur (d=220mm) grafnar

Sökkjar járnbandist með grind K10 c/c 300. 2K12

Grindur skal klæða með 12 mm rakalímdum og fú skrúfað með 4/40 skrúfum c/c 150 á hornum c/c 2

Þaksperrur, mænisbitar og gólfbitar eru 45x195mm

Grindur útveggja eru 45x120mm og burðarveggur í gæðaflokki T1

Allur saumur og tengi sé galvanhúðað

**hagtækni**  
tækniþjónusta Refsholti 7, Sko

VERK  
Veitubraut 1, Vaðnesi

TEIKNING  
Gestahús  
Burðarvirki - Undirstöður, gólf og þak 1/50 og 1/

DAGS  
15. júní 2017  
TEIKNAD  
Ingólfur Margeirsson 070252-3099