

---	---	---	---
---	---	---	---
---	---	---	---
---	---	---	---
---	---	---	---
---	---	---	---
---	---	---	---
---	---	---	---
---	---	---	---
---	---	---	---

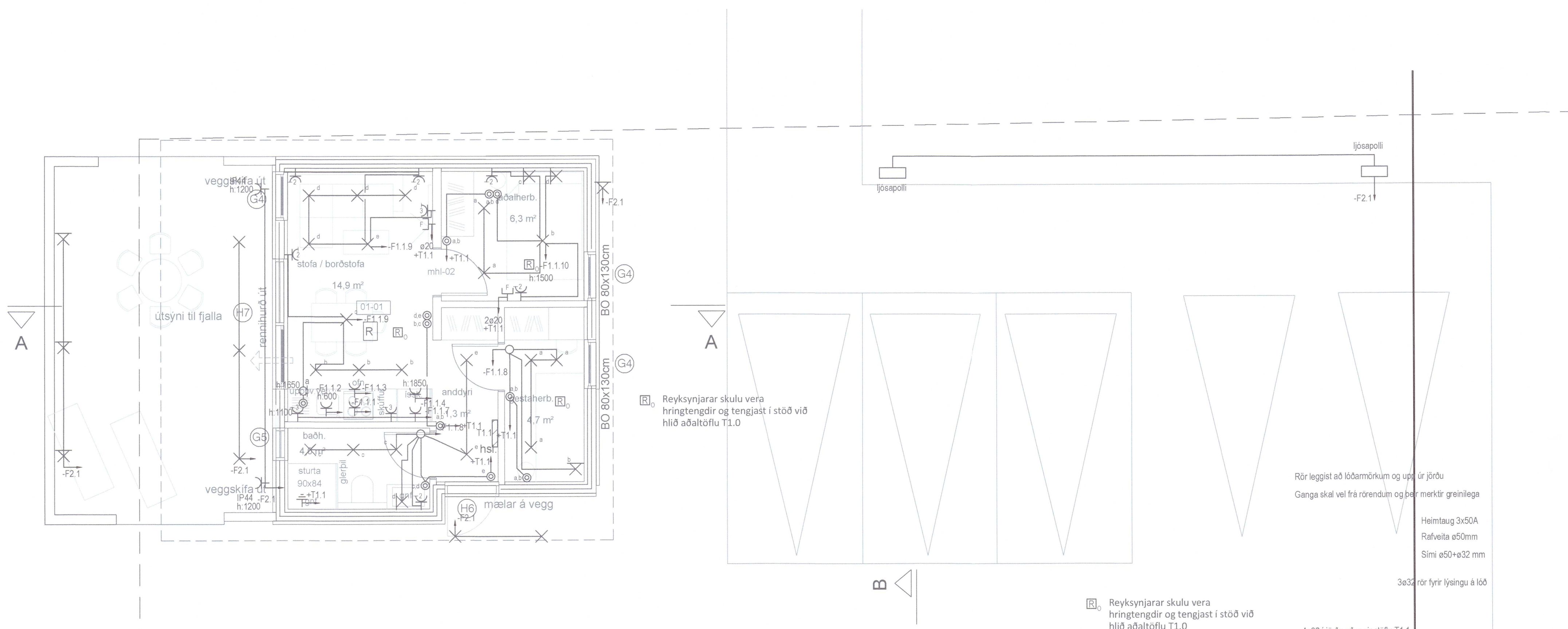

Reyksynjar skulu vera hringtengdir og tengjast í stöð við hlöð aðaltöflu T1.0

Reyksynjar skulu vera hringtengdir og tengjast í stöð við hlöð aðaltöflu T1.0

Rör leggist að lóðarmörkum og upp úr jörðu
 Ganga skal vel frá rörendum og þeim merktir greinilega

Heimtaug 3x50A
 Rafvetla ø50mm
 Sími ø50+ø32 mm

3ø32 rör fyrir lyeingu á lóð

4ø32 í jörðu að greinatöflu T1.1

NR.96
FM=5040 m²

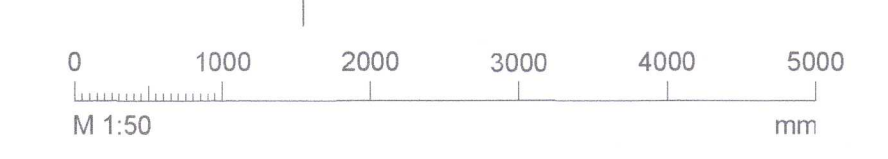
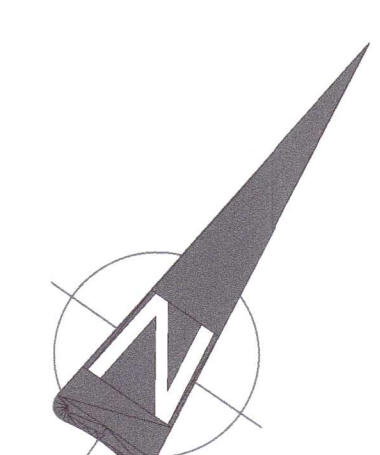
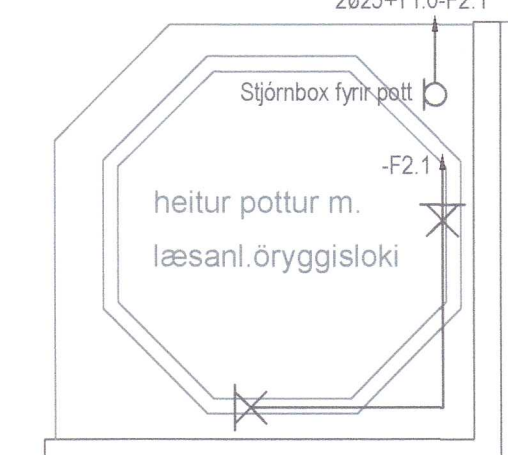
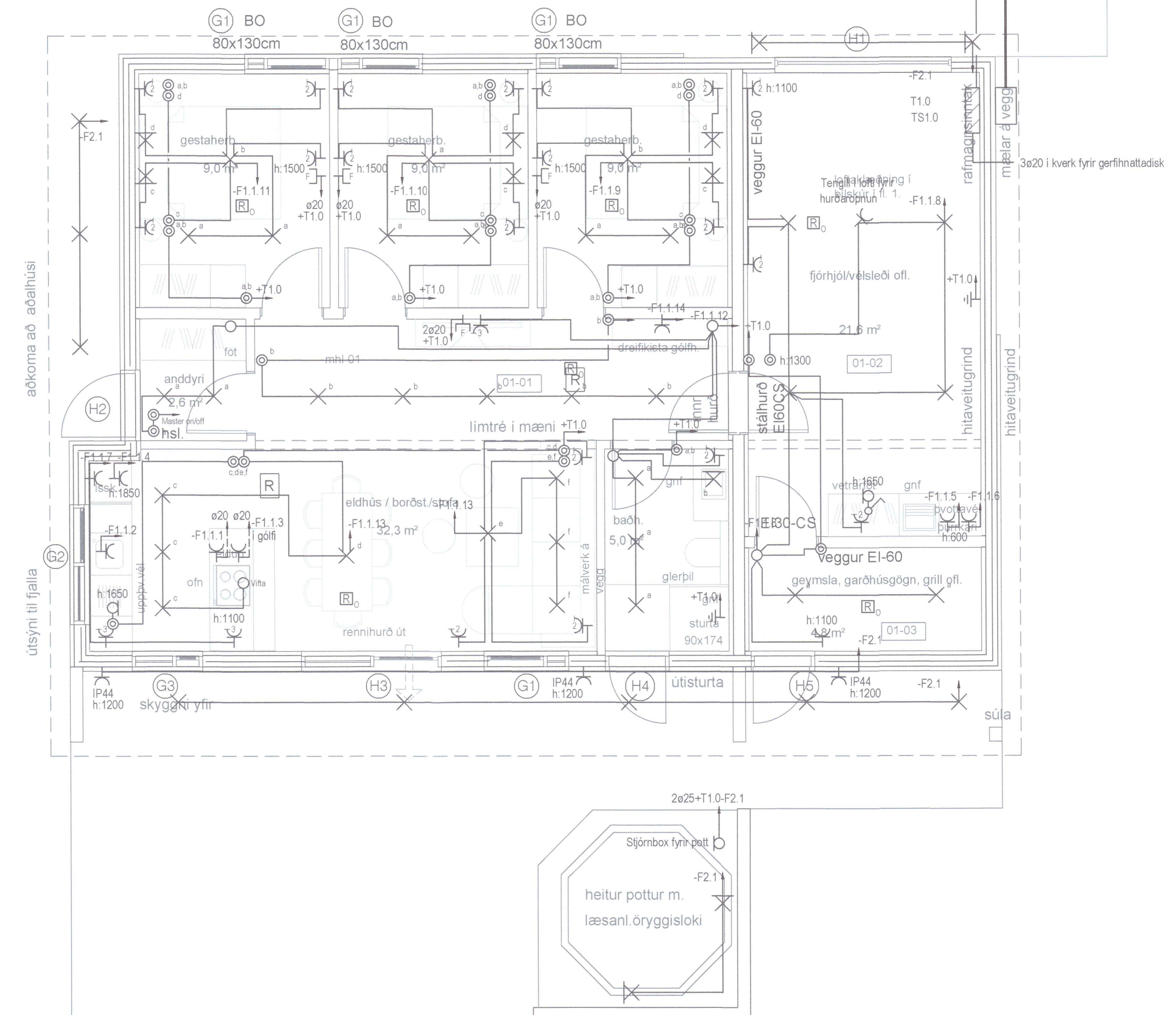

TESLA ehf
 Raflagna- og lýsingarhönnun
 Svanbjörn Einarsson, kt. 180265-3339
 698-2624, svanbjorn@teslaehf.is

Sumarhús Kerhraun 96
 Landnr. 173006, staðgr. 8719-1-46350960
 805 Selfossi

Raferki 20202537
 Almennar raflagnir
 Grunnmynd

TEKNI. NÚMÉR.	BLAÐSTÆRÐ	HANNAÐ.	SVE
20200311.1	A1	TEKNI. NÚMÉR.	HMH
01_40_01		YFIRFARIÐ.	SVE
DAGS.	MÆLIKVARIÐ	UTGAFA	
13.03.2020	1:50		B

Hönnuður: Svanbjörn Einarsson M. 180265-3339
 Hönnuð: *S.L. Sted*

T:\Virkisráðgjafi\2020.03.11 Kerhraun 96A_Vinnugögn\Teikningar\01_40 Almennar raflagnir.dwg