

GL-2
Fjöldi: 1 stk

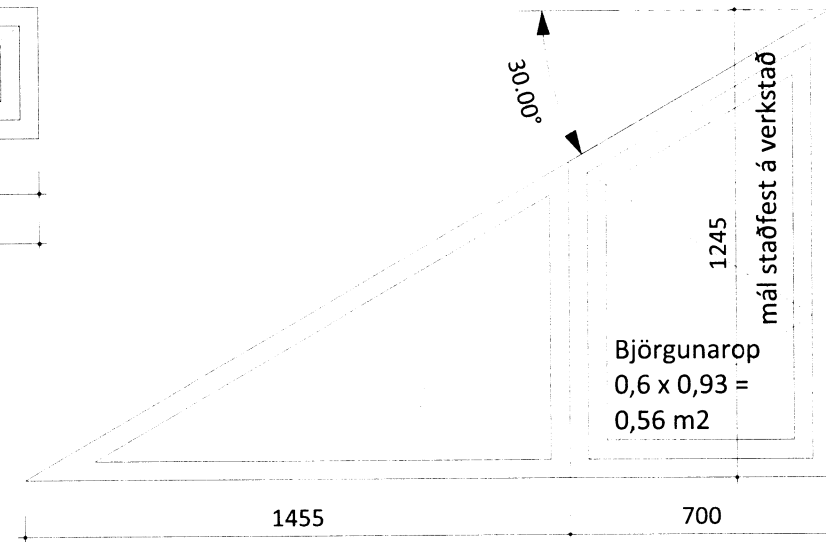

GL-4
Fjöldi: 1 stk

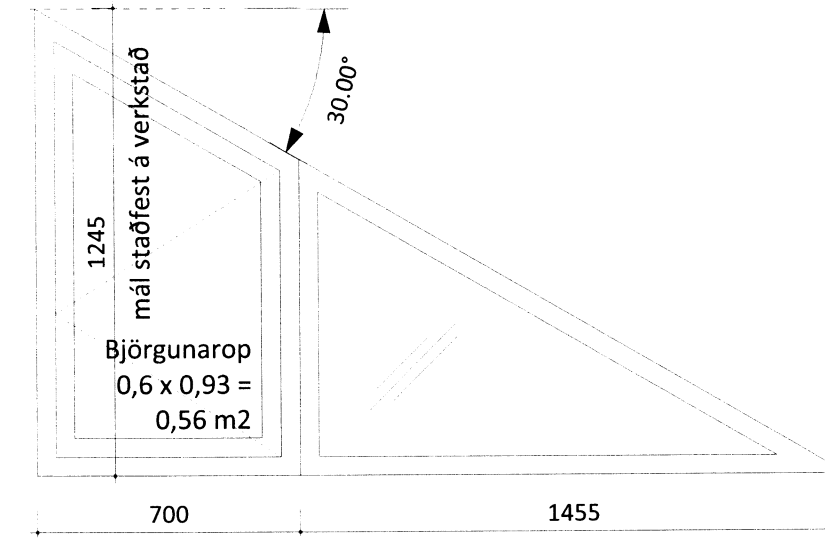

GL-5
Fjöldi: 1 stk

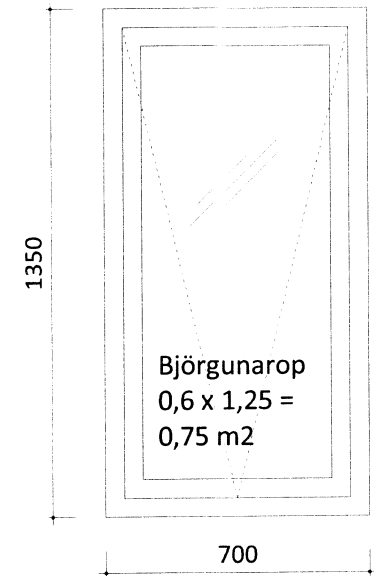

GL-3
Fjöldi: 3 stk

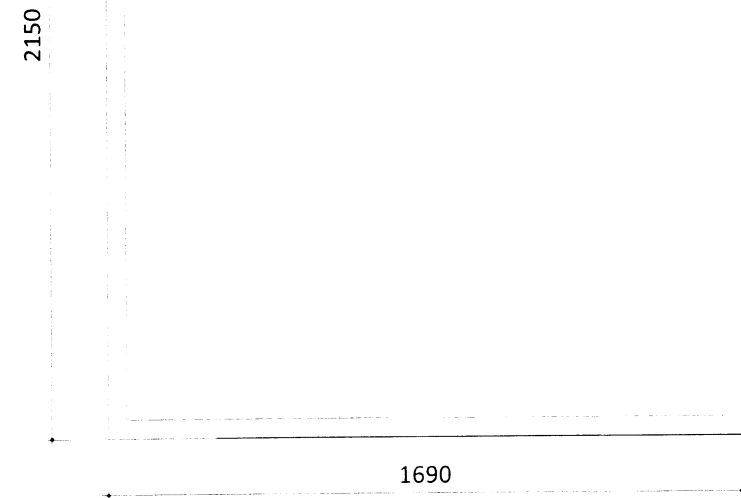

GL-1
Fjöldi: 1 stk

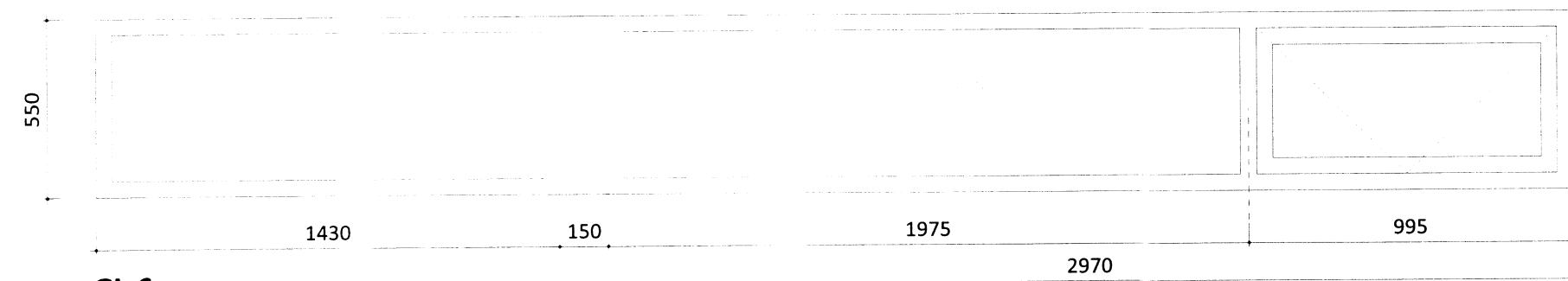

GL-6
Fjöldi: 1 stk

GL-7
Fjöldi: 1 stk

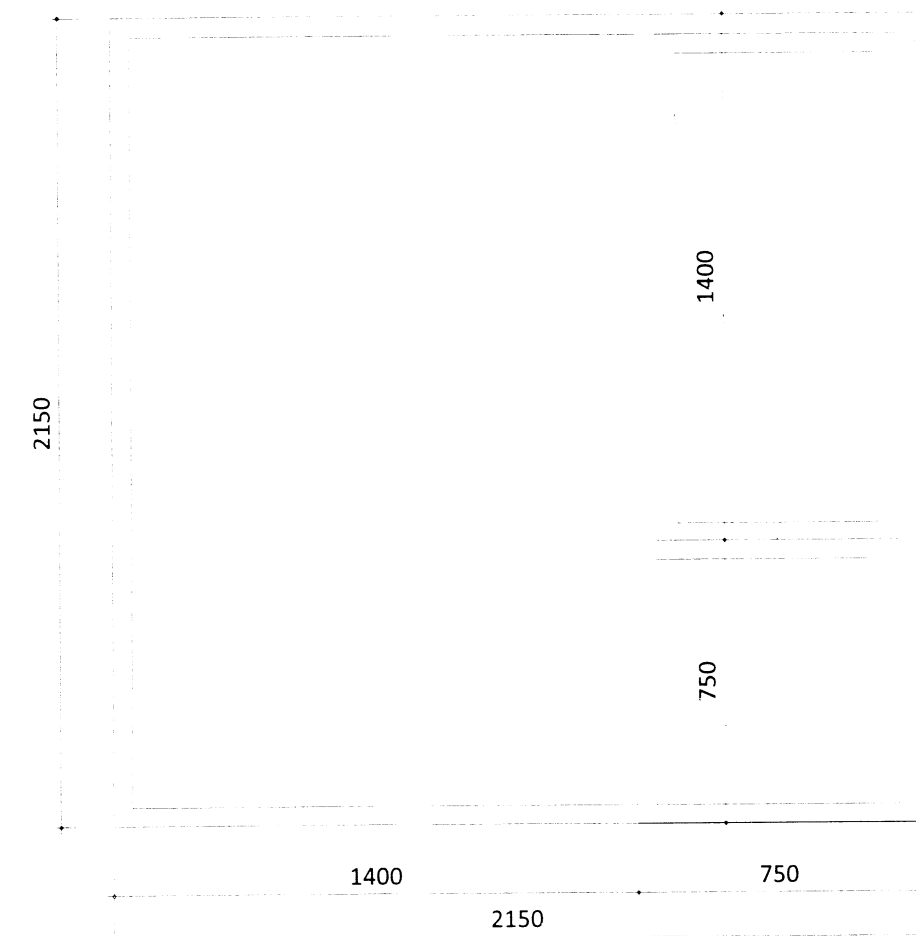

GL-8
Fjöldi: 1 stk

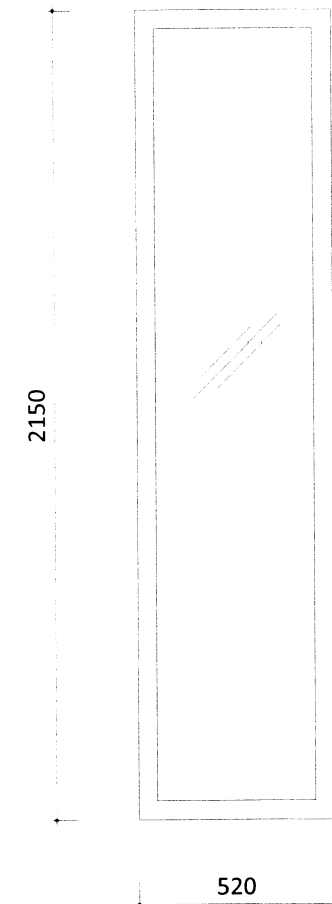

GL-11
Fjöldi: 2 stk

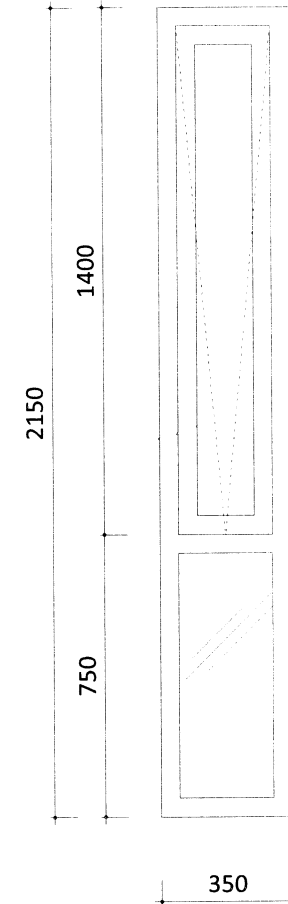

GL-12
Fjöldi: 1 stk

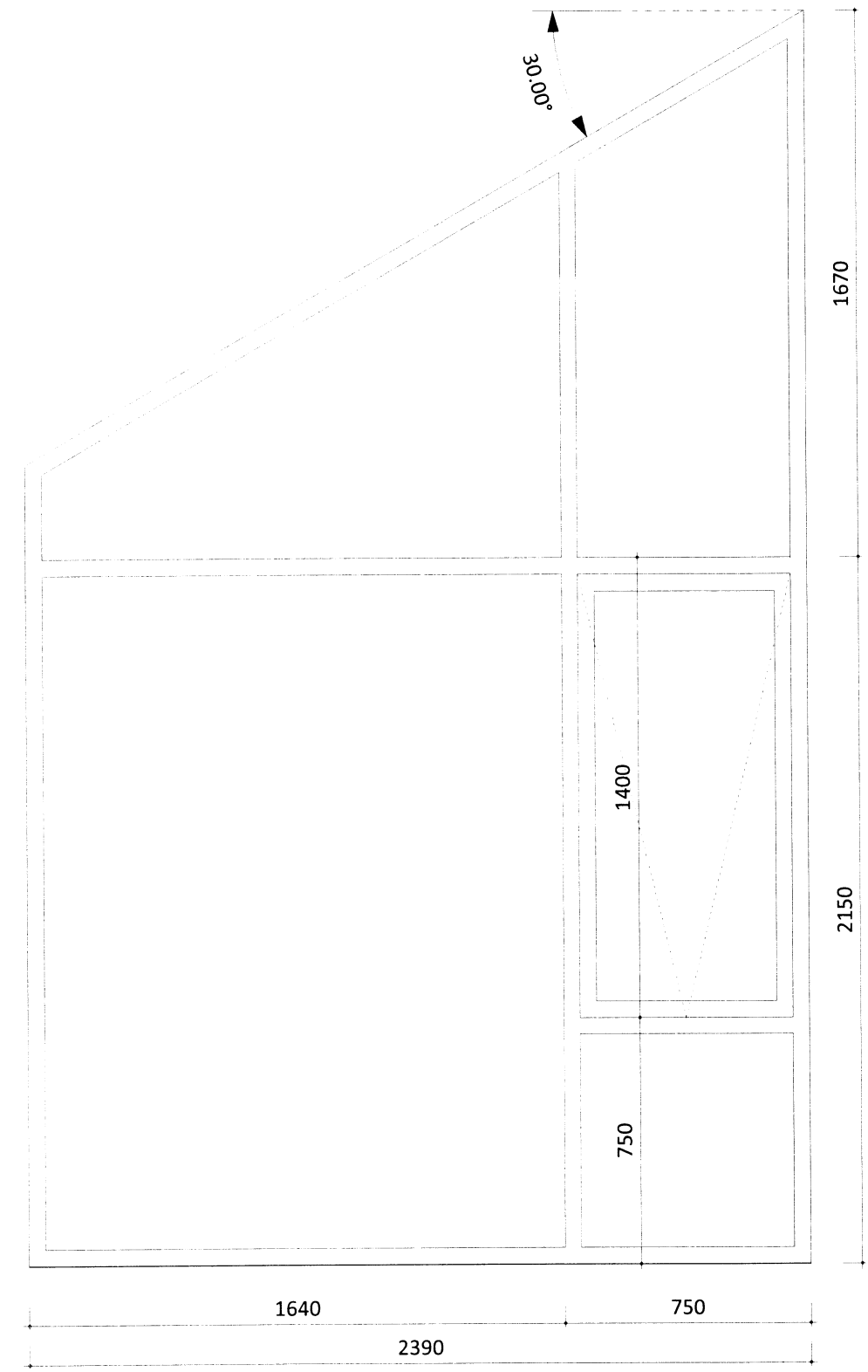

GL-9
Fjöldi: 1 stk

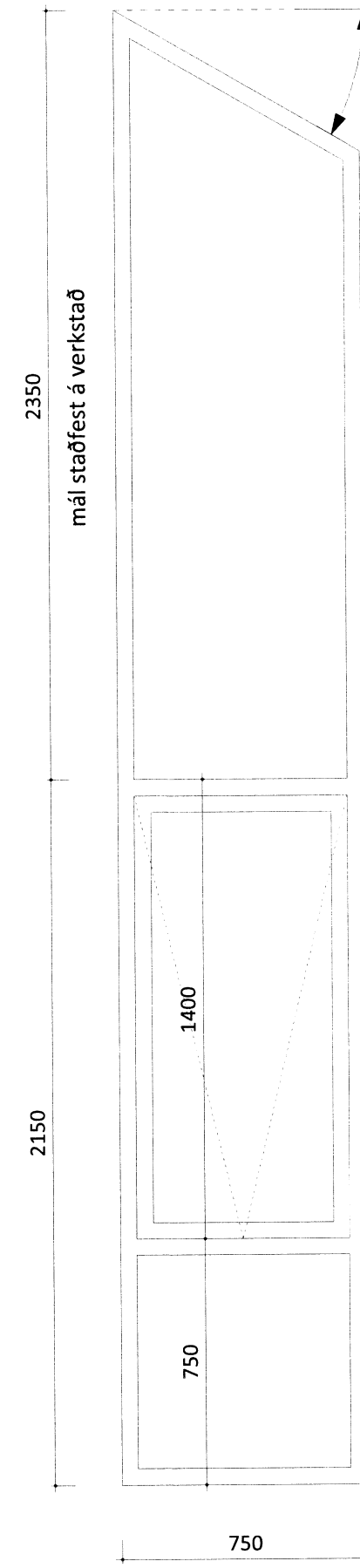

GL-10
Fjöldi: 1 stk

ATH.;
 - Öll mál athugist og mælist á staðnum áður en smíði hefst.
 - Ósamræmi í teikningum tilkynnist eftirlitsmanni verkkaupa.
 - Öll mál eru í millimetrum.

ATH.;
 - Öll mál á umfangi glugga og hurða eru utanmál með fúgu meðtaldri.
 - Öll ásýnd er utanfrá. Athugið að inngangshurð UH-1 opnast inn en er með ásýnd utanfrá.

A.20.05

Sumarhús
Langamýri 13 A, Mýrarkot,
801 Grímsnes- og Grafningshr.

Fastanúmer lóðar: 235-2852
 Landnúmer: 222622

verknúmer: 118
 teikning: Gluggar
 dags.: 11. september 2014
 m.kv.: 1:20
 teiknað: HHH
 breyting:
 dags.:
 skýring:

TEIKNIVANGUR

Kleppsmýravegur 8 - 104 Reykjavík
 s: 568 1317 - gsm: 897 1317
 nf: teiknivanpur@teiknivanpur.is - www.teiknivanpur.is

Halla Haraldsdóttir Hamar, kt. 111066-3539