

**Stapi 4 aðalhús - deili**

**Skýringar**

Mælið ekki af teikningum. Öll mál skulu sannreynð á staðnum. Öll vafalaubið berist undir eftirlit. Allir skökkjur tilkynnist eftirliti strax. Öll mál eru í millimetrum, nema annað komi fram.

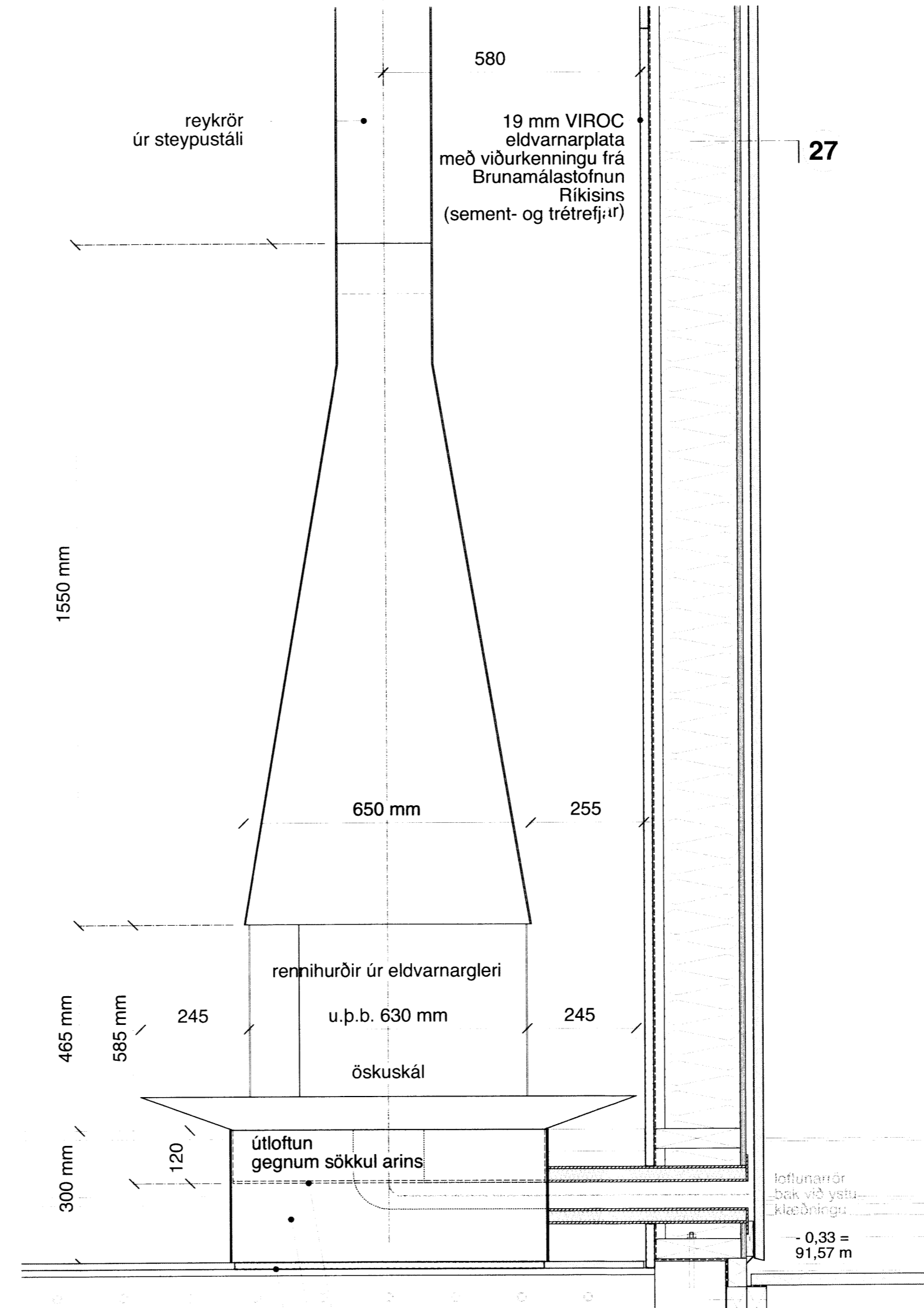
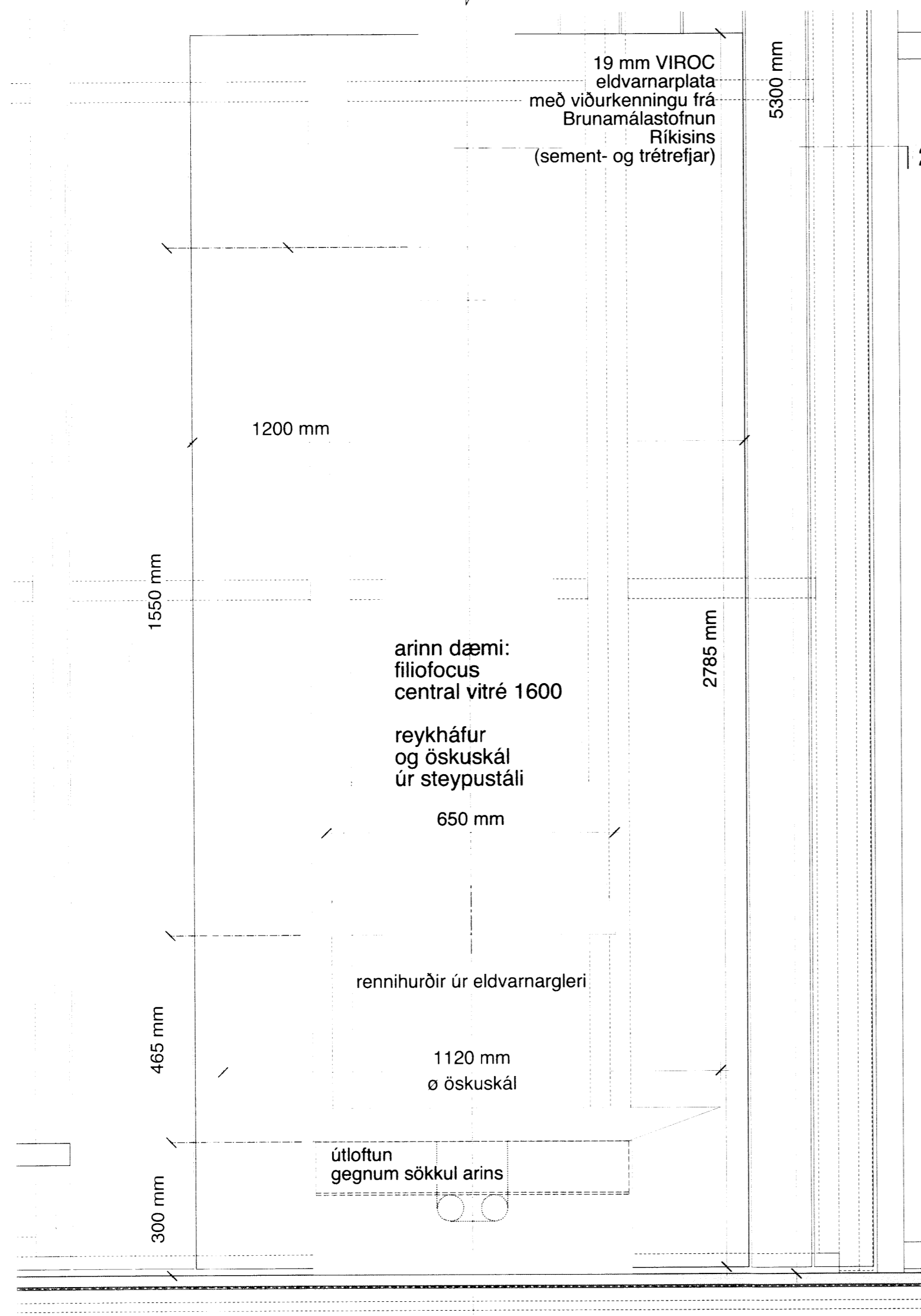
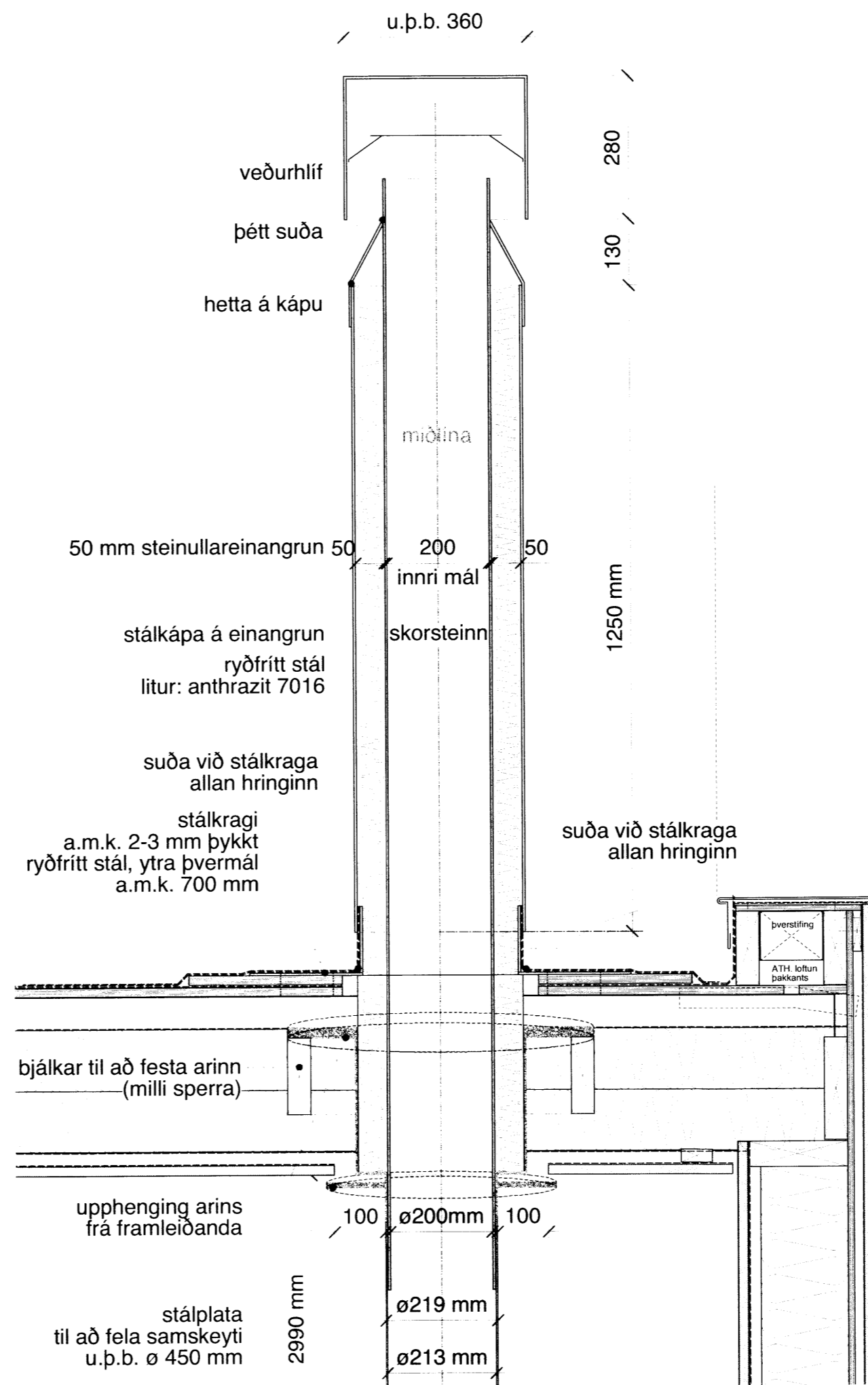
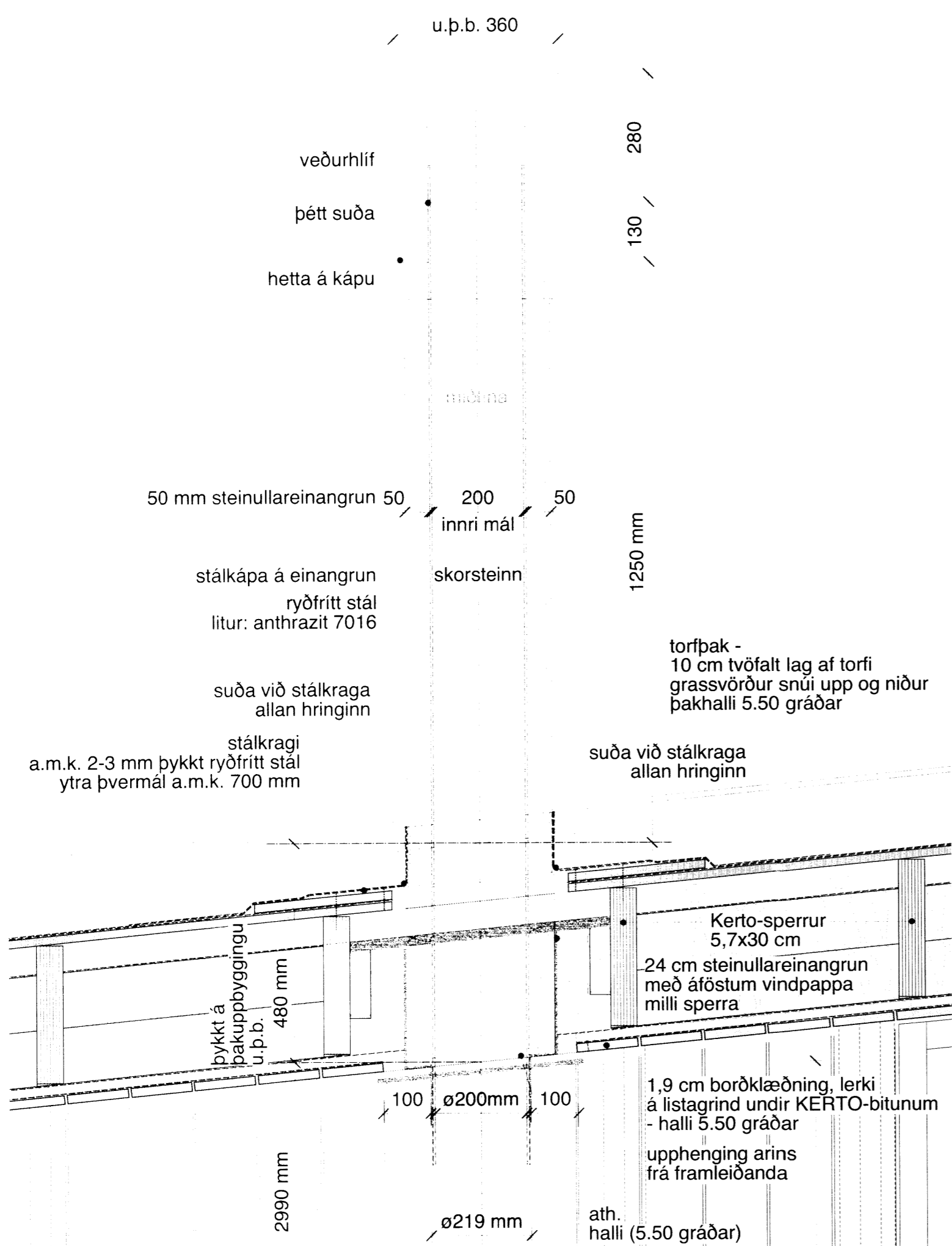

**29** útlit

**28** snið

botnplata arins  
 útlöftað rými undir arinhólfi  
 19 mm þykk eldvarnarplata  
 t.d. VIROC ofan á flotað gólf

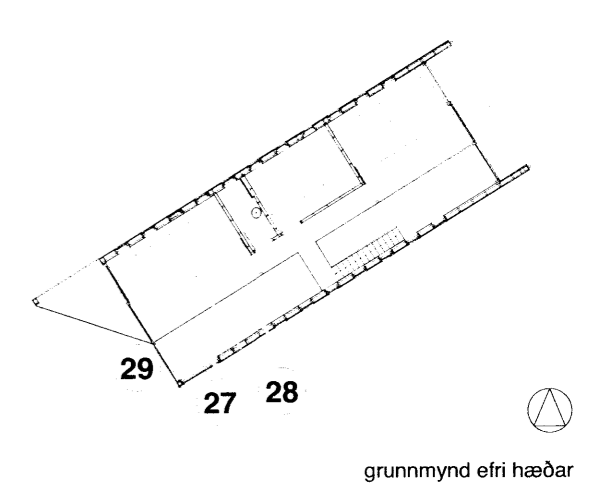
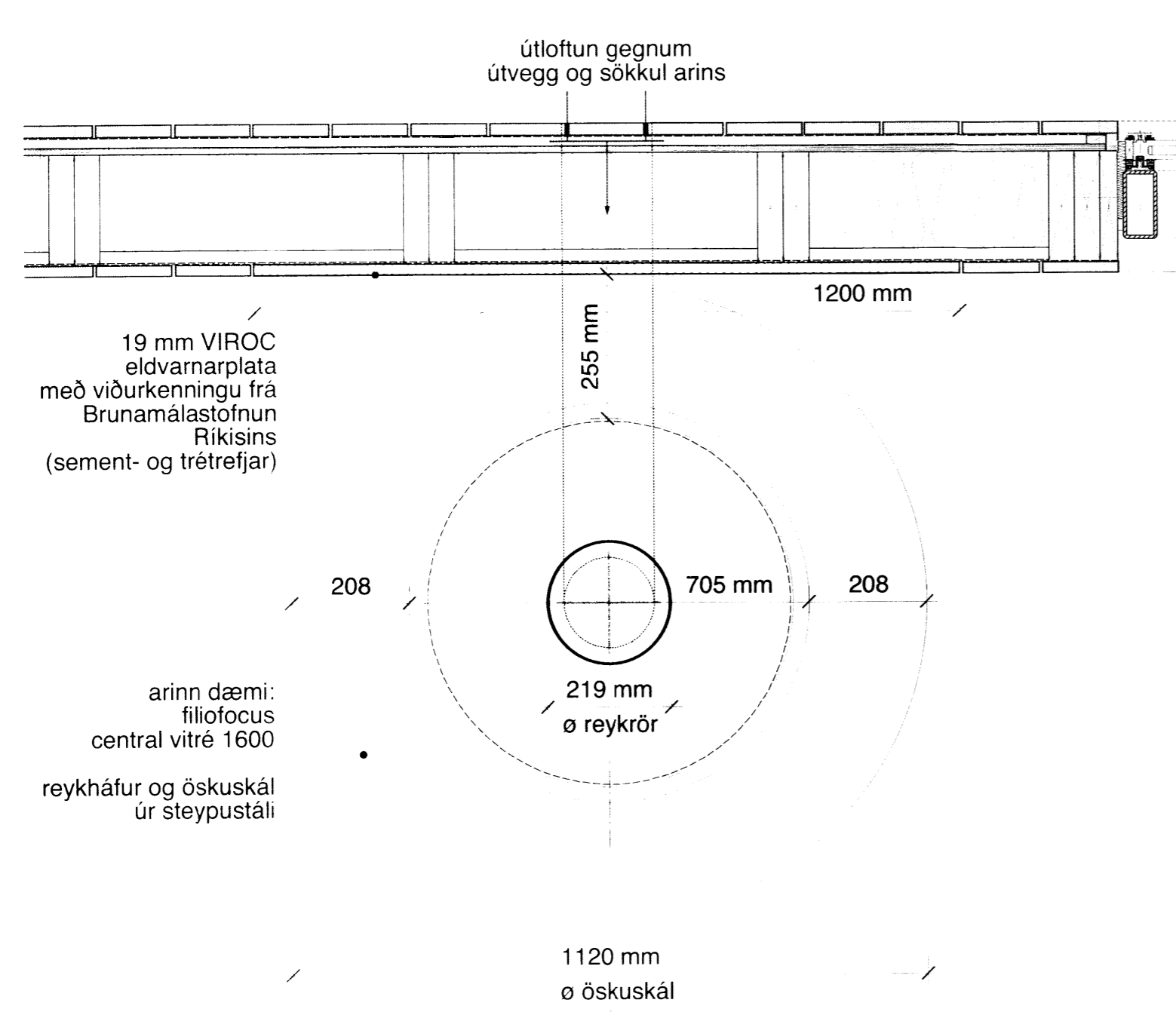

**27** grunnmynd

**Vinnustofnan Pverá ehf**  
 Skilavörðustig 12 • 101 Reykjavík • sími 5514060 • fax 5614060 • arkverk.is

**Stapi 4, sumarhús við Úlfliótsvatn**  
 Grimsnes- og Grafingshreppi

teikning: aðalhús - arinn og skorsteinn  
 höfundar: VB verkfr.: 1.146  
 teknað: ML kvæði: 1:10 (A1)  
 breytt: dags.: 23.07.2015  
 yfirfarið: Valdis Bjarnadóttir arkitekt FAL FSSA valdis@arkverk.is  
 tölvuskýr: Stapi 4 sumarhús verkefningar.mcd blaðnr.: **3.12**

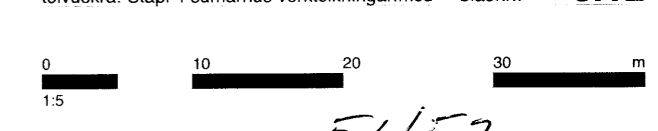

5453