

GRUNNMYND 1:50

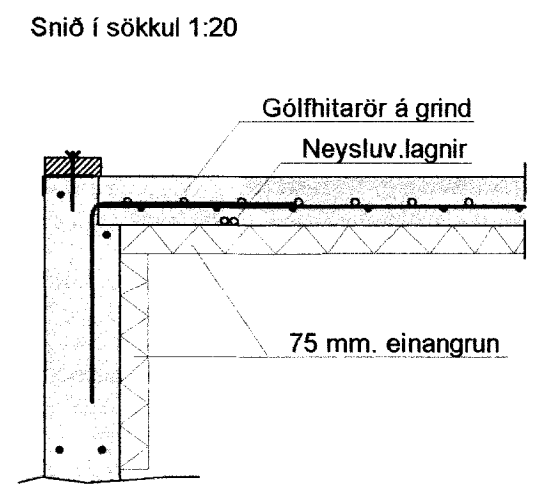

Sumarhús Brúamörk 4							Gólfhita afköst		
HERBERGI:	Slaufa númer	Lengd slaufu m	Millibil röra m	Hitastig Herbergi °C	Meðal hiti inn 40 °C út 30 °C	Varmagjöt slaufa m²	Raun flötur Hitaður upp m²	Afköst Slaufu Wött/ídst/heid	
1	Herbergi	1	57	0,150	20	35	8,55	710	
2	Hjón	2	74	0,150	20	35	11,10	921	
3	Herbergi	3	49	0,150	20	35	7,35	610	
4	Hol	4	46	0,150	20	35	6,90	573	
5	Eldhús	5	105	0,150	20	35	15,75	1.307	
6	Stofa	6	101	0,150	20	35	15,15	1.257	
7	Anddyri	7	25	0,150	20	35	3,75	353	
8	Bað	8	24	0,150	20	35	3,60	338	
Samtals							481	72	6.069

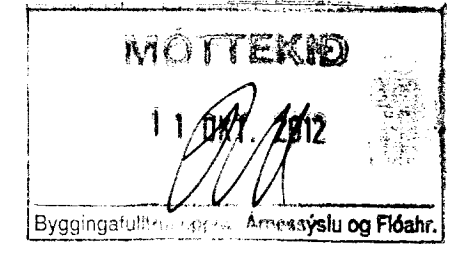
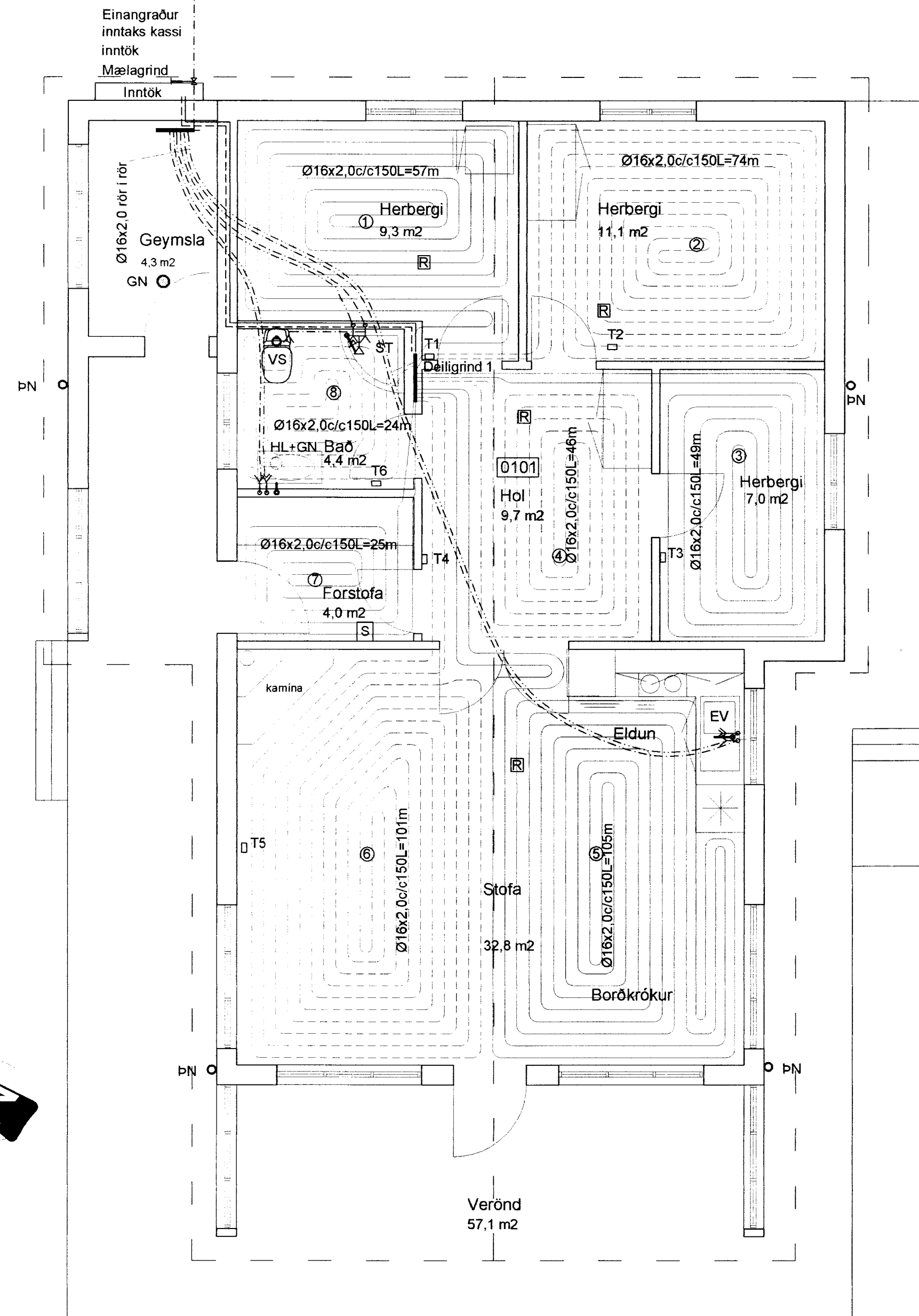
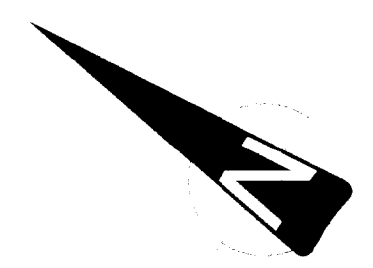

Breytingar			BRÚAMÖRK 4 GRÍMSNESH.		
Nr.	Dags.	Nafn			
Verkfræðistofa Þráinn & Benedikt Laugavegi 178, 105 Rvk. Sími: 553 1770, 568 7775, Fax: 568-7701 Netfang: verkfraedistofa@verkfraedistofa.is			H BS T HS S M 1:50 Nr. P101		
Hiti, neysluvatn og frárennsli			Dags. júl '12 090638-4839 080149-3609		
Aritun aðalhönnuðar: <i>BD</i>			<i>BS</i>		