

FB Snið
53 54 M 1:10

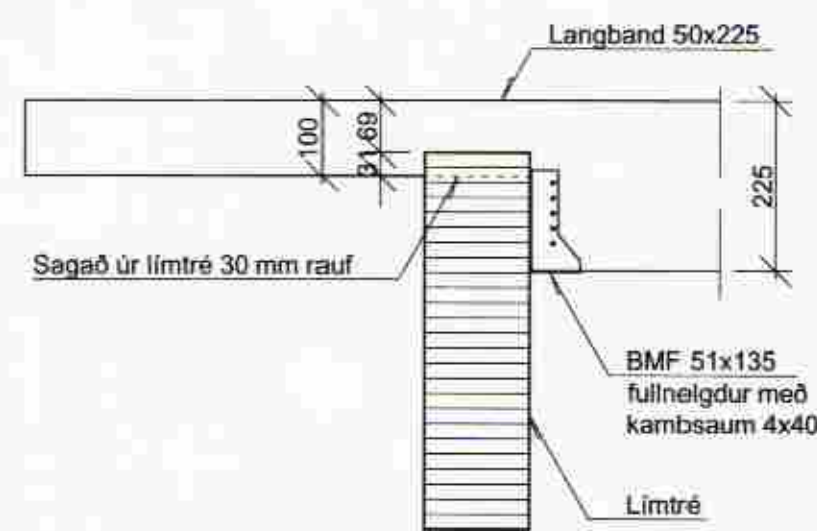

FC Snið
53 54 M 1:10

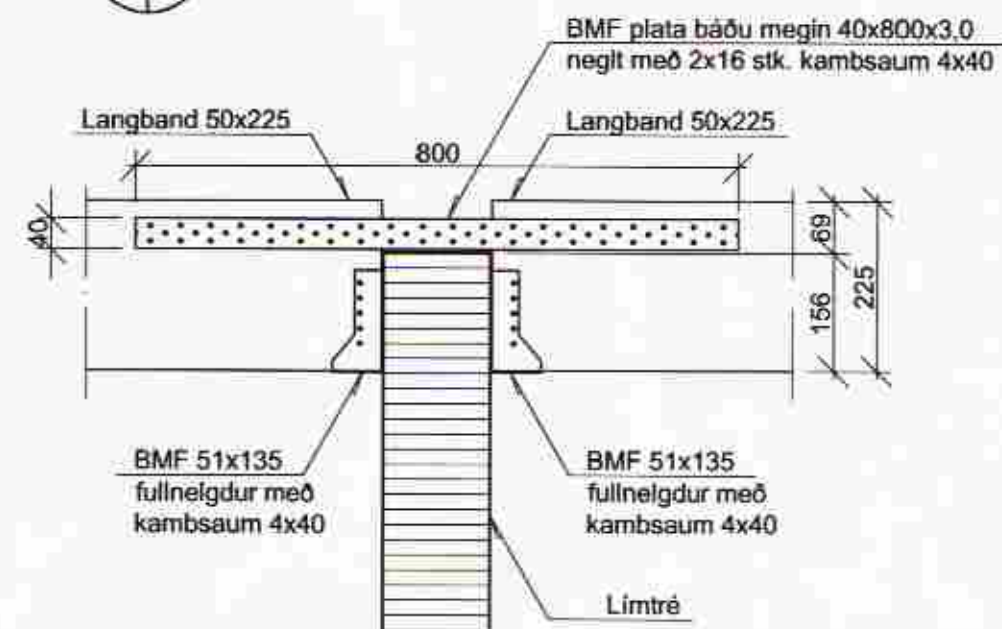

FD Snið
53 54 M 1:10

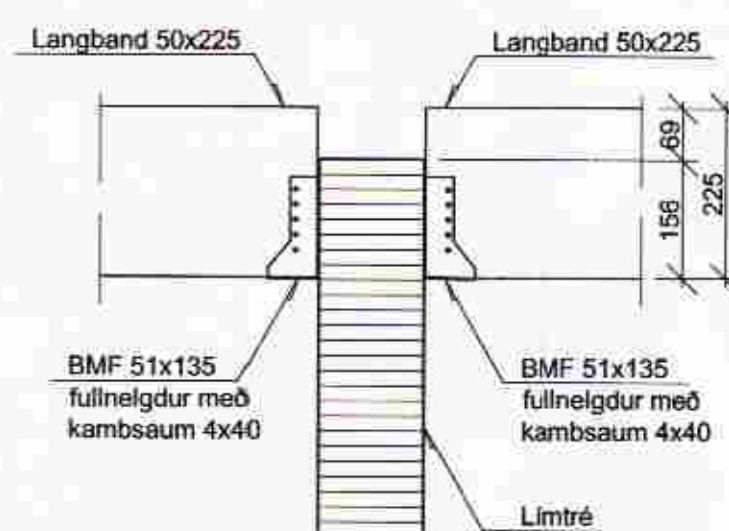

FE Snið
53 54 M 1:10

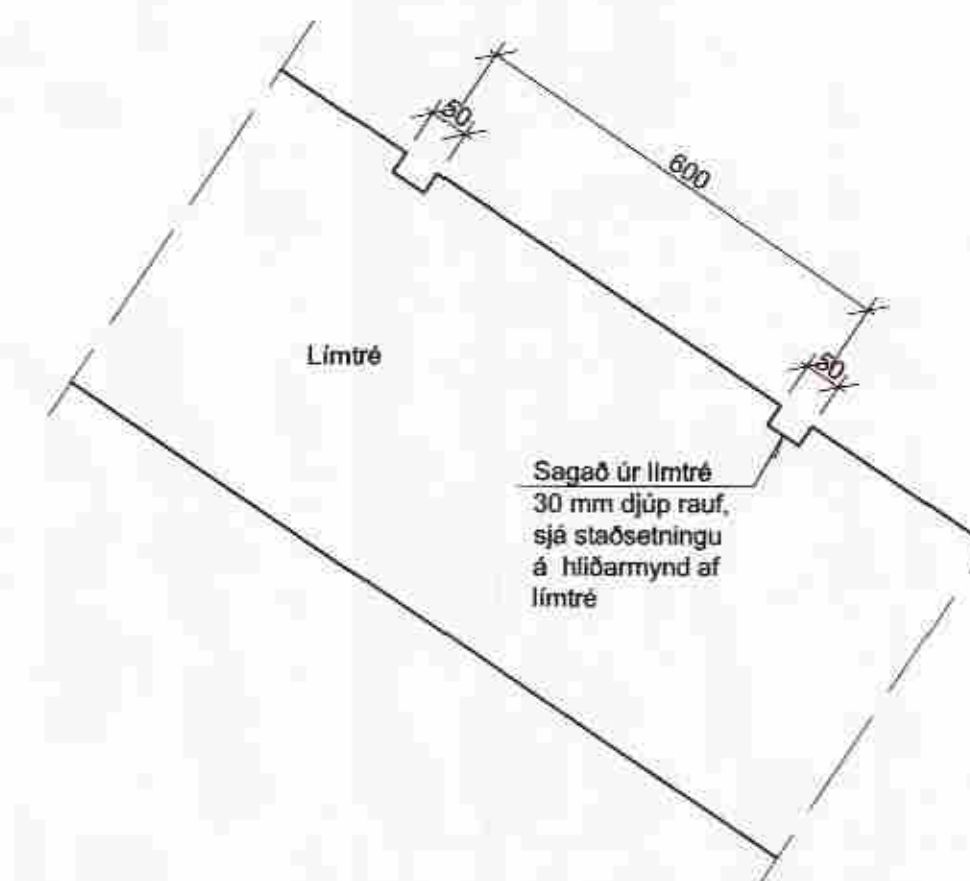

FH Snið
53 54 M 1:10

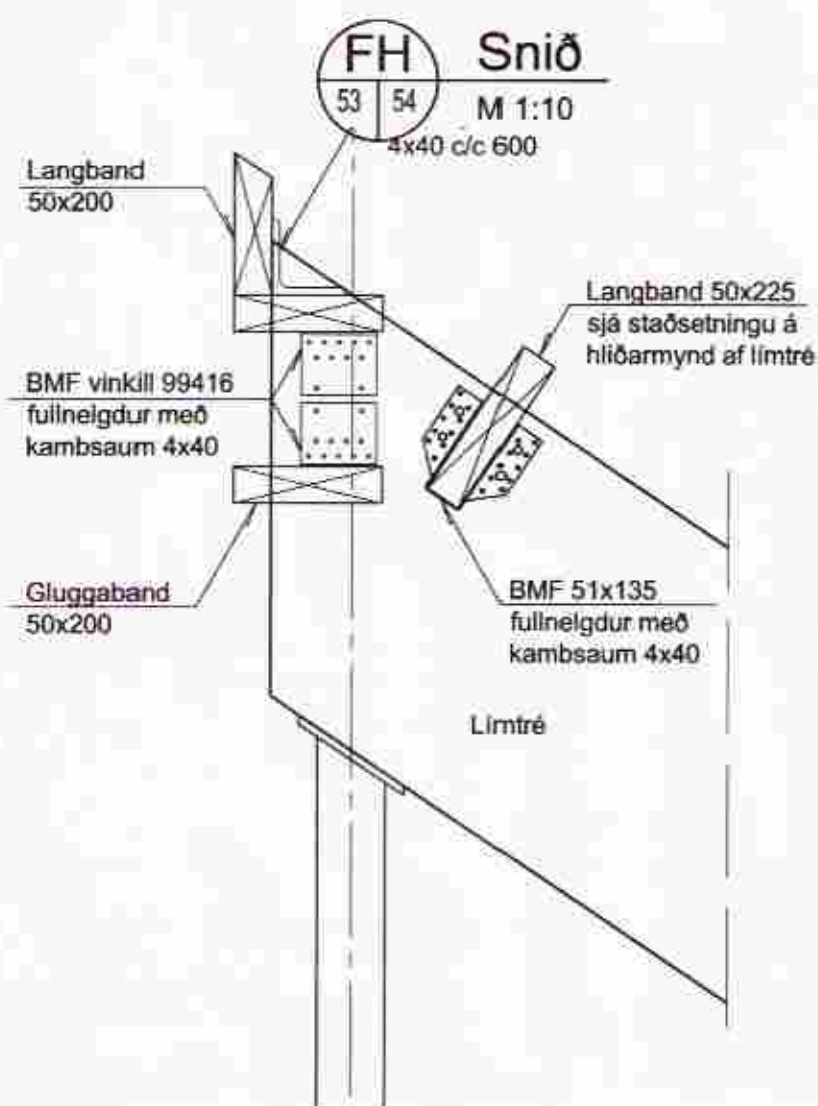

FI Snið
53 54 M 1:10

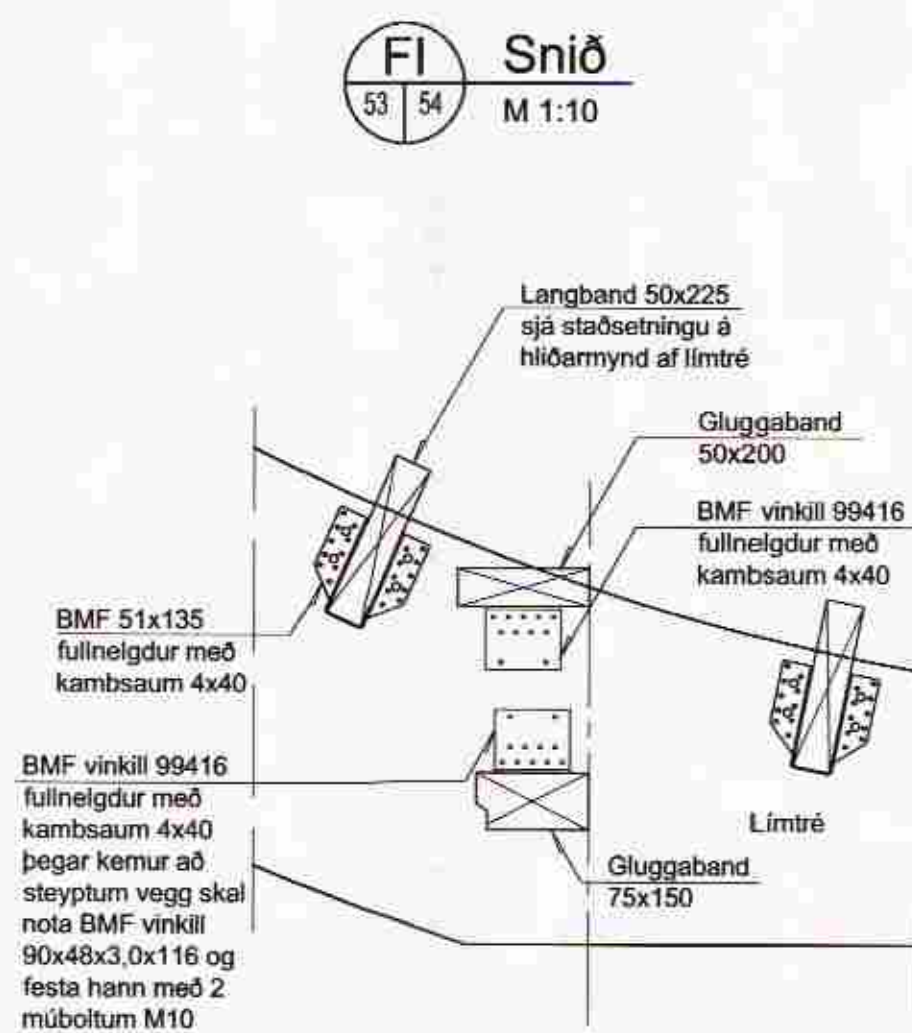

FJ Snið
53 54 M 1:10

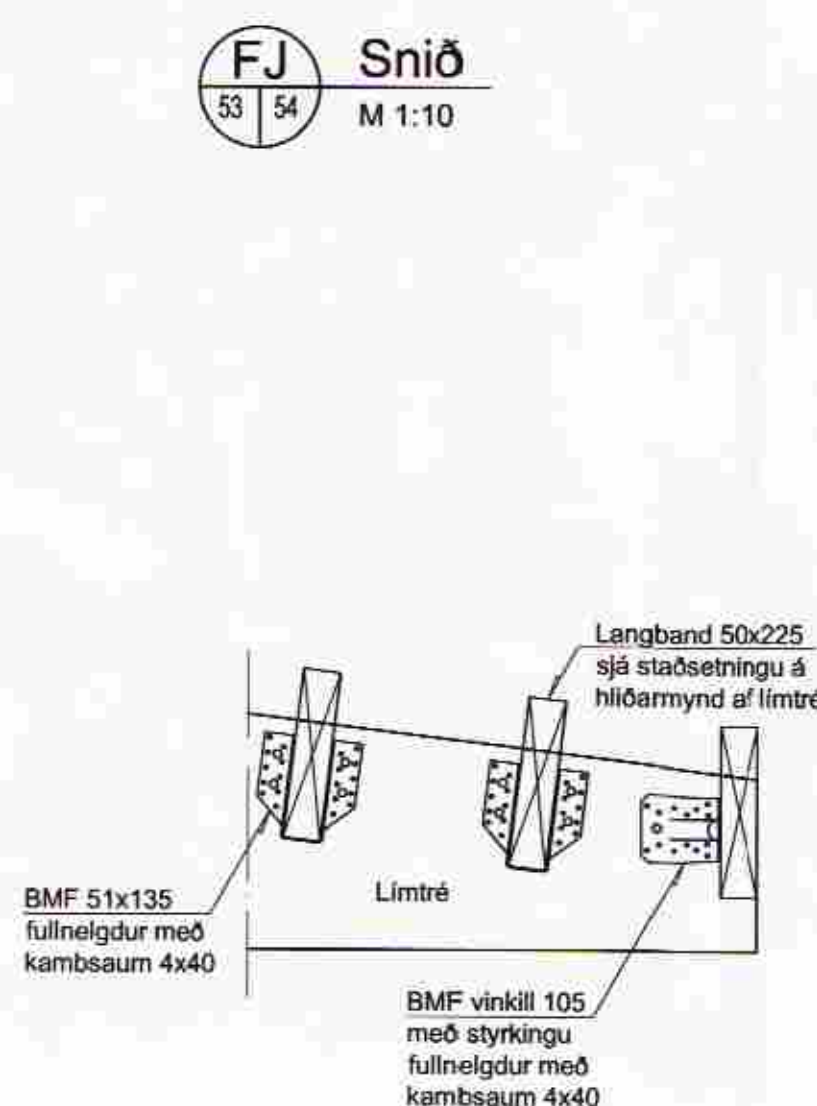

FF Snið
53 54 M 1:10

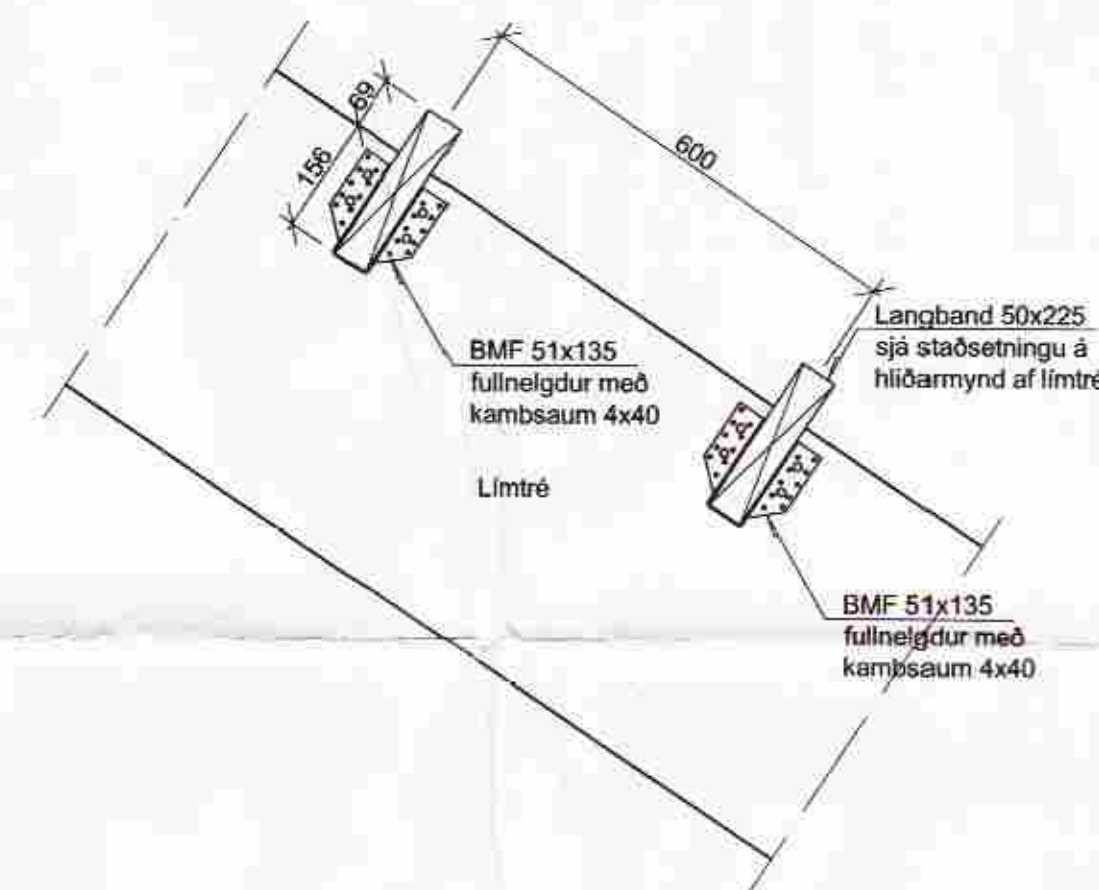

FK Mynd
53 54 M 1:10

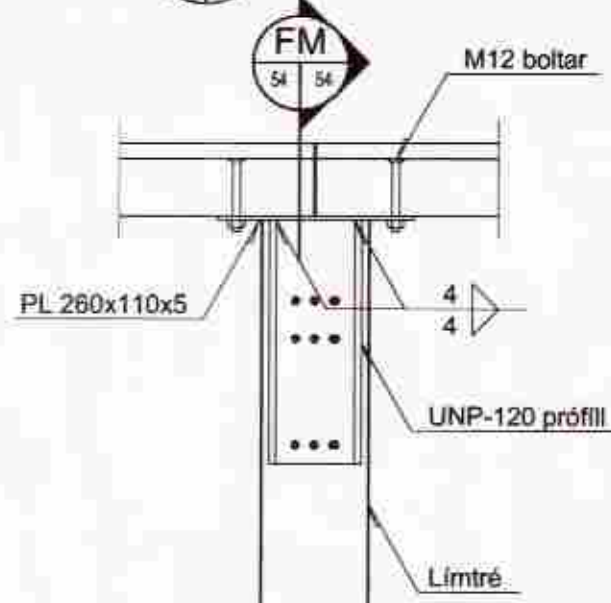

FL Mynd
53 54 M 1:10

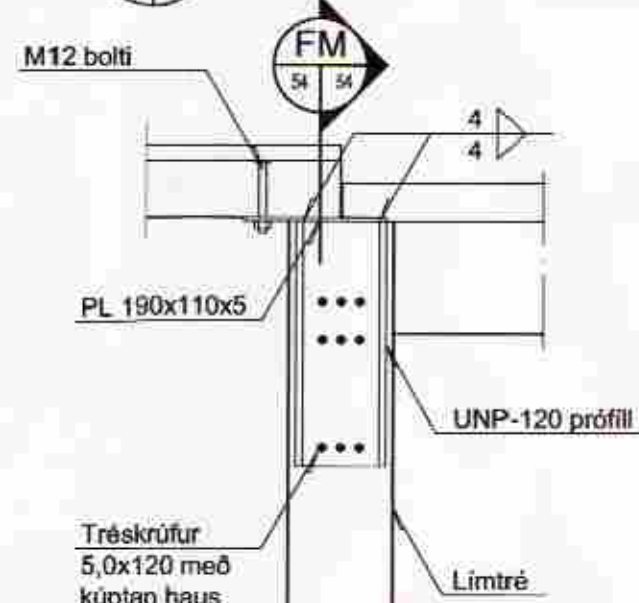

FM Snið
54 54 M 1:10

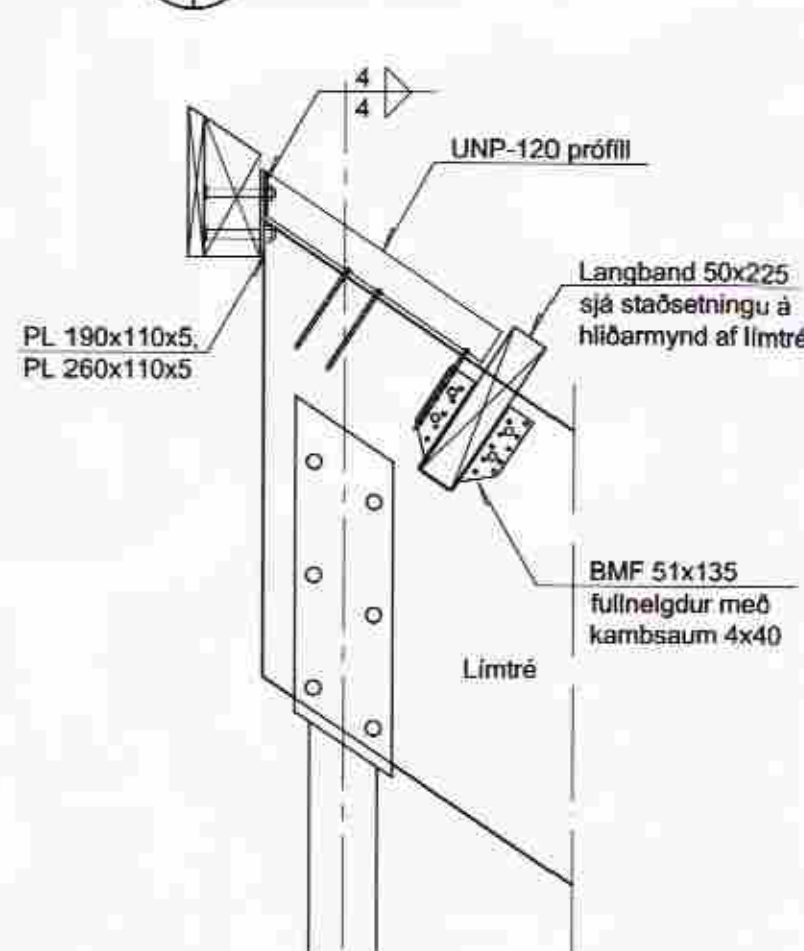

UNP-120 prófill
M 1:5

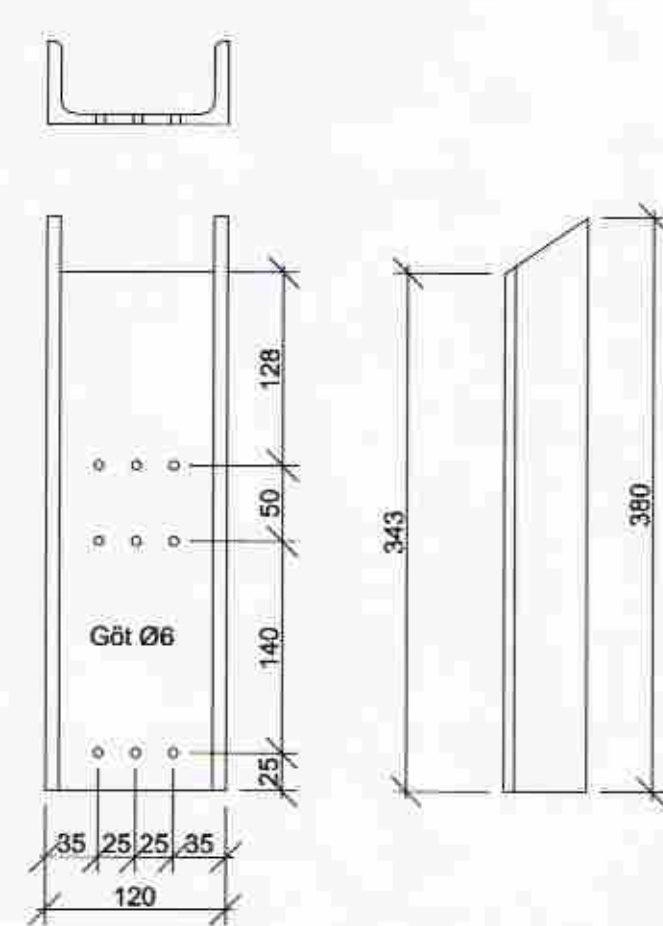

FG Snið
53 54 M 1:10

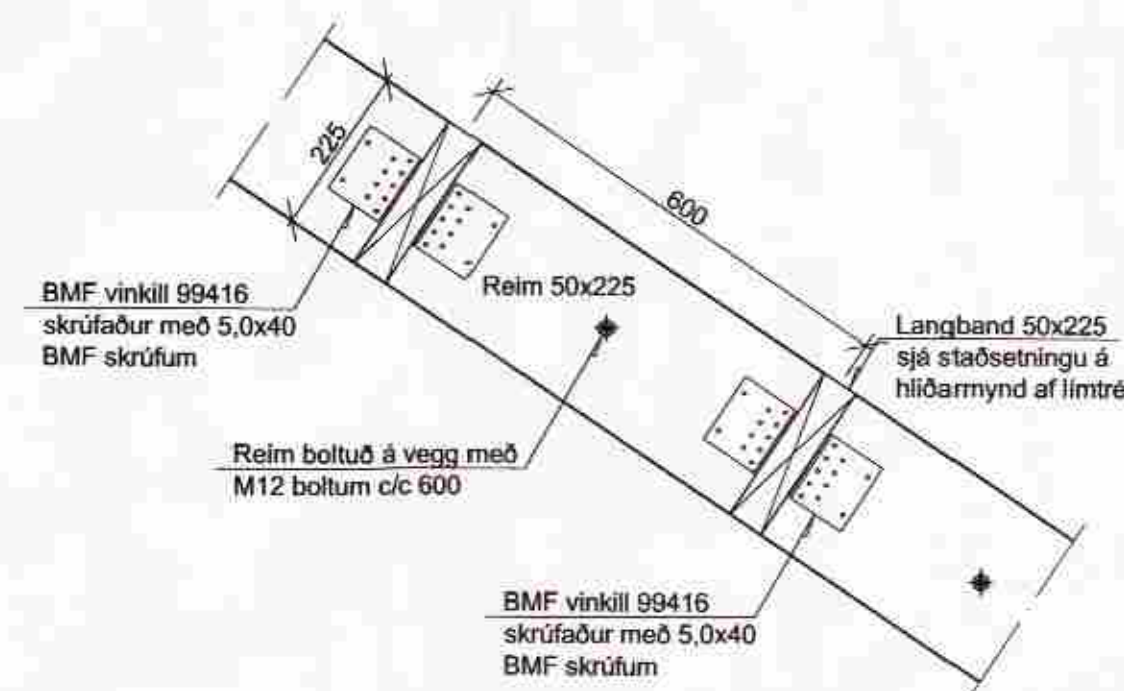

FN Snið
53 54 M 1:10



FO Snið
53 54 M 1:10

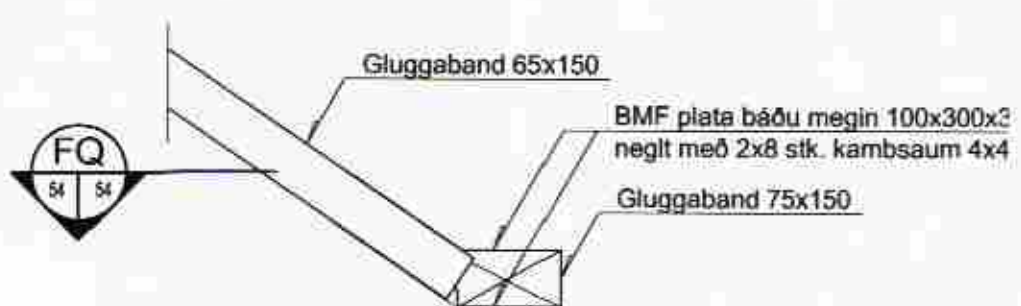

FP Snið
54 54 M 1:10

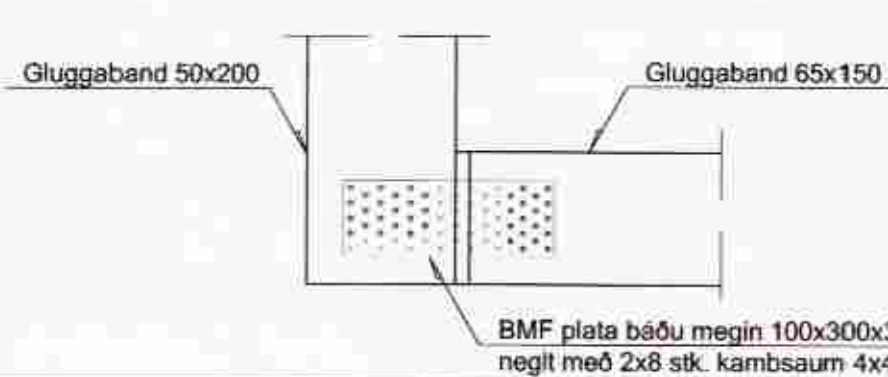

FQ Snið
54 54 M 1:10

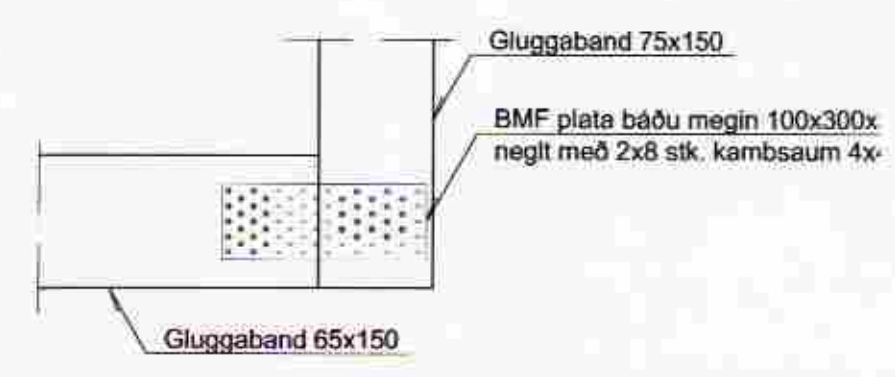

PL 190x110x5
M 1:5

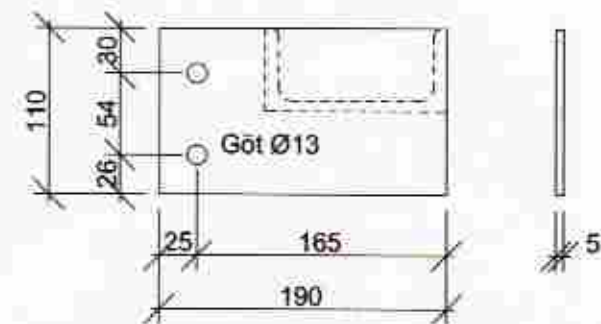

PL 260x110x5
M 1:5

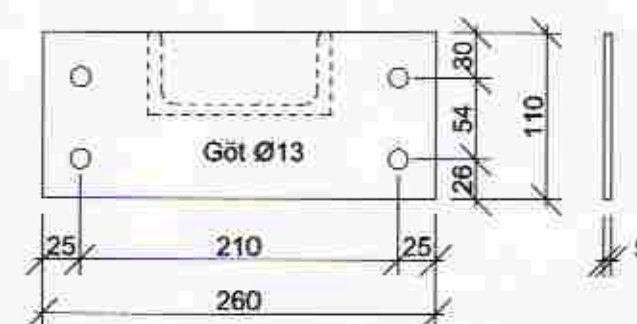

Skýringar.

Öll mál eru í mm, nema hæðarkótar í m.

UTG	BREYTING	DAGS	NAFN	LYRFR

Borg í Grímsnesi

Skóli og stjórnsýsluhúsið
Létt þak
Snið

TEIÐNÖMUR	EF04BS B-54	MÁLKVAFUR	1:5, 1:10	UTGÁFA
Línuhönnun V A R T F A R S T A T A SÍMI: 593 1500, FAX: 593 1501	NAFN	DAGSETNING		
	HANNAÐ	HPG	06.05.2005	
TEKNAÐ	HIS	06.05.2005		
ÞYRPAÐ	BLP	06.05.2005		

SAM: *Andriana Haldrup* 3.007.16.220
m/festinghorng | grímsesi/teikningar | hrburðarpólitíaröðun