

MÓTTEKIÐ

01 OKT. 2009

Byggingafrútrú uppsv. Amessýslu og Flóahv.

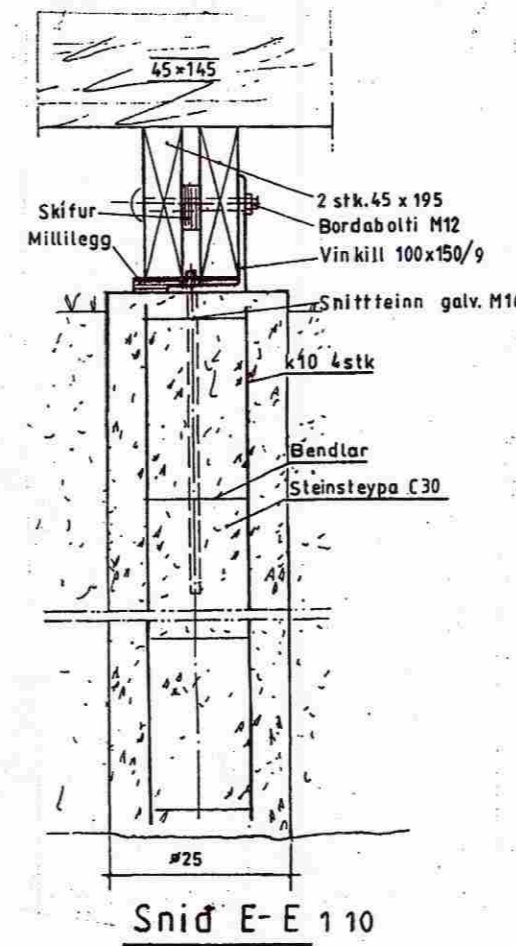
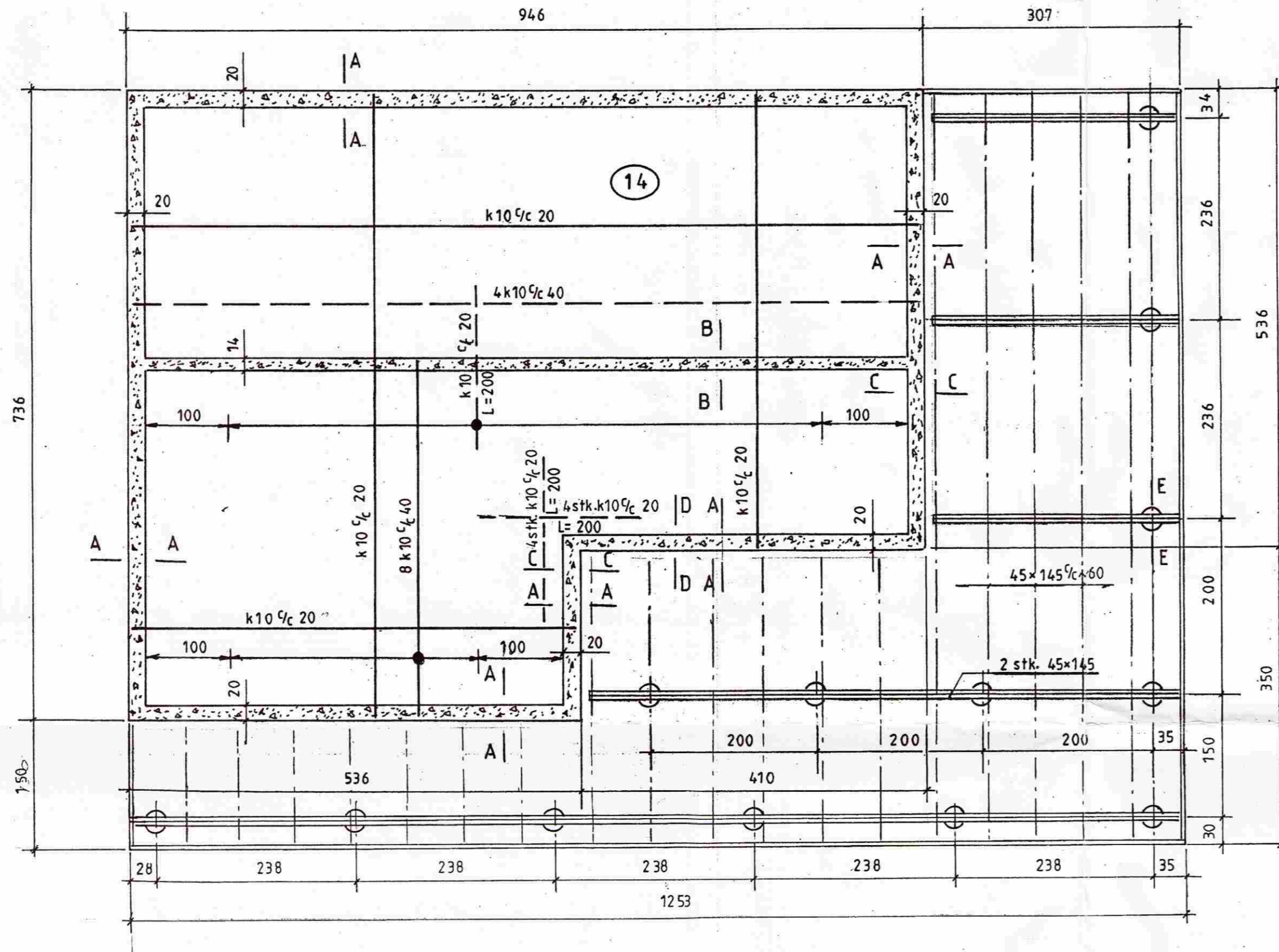

Snið E-E 1:10

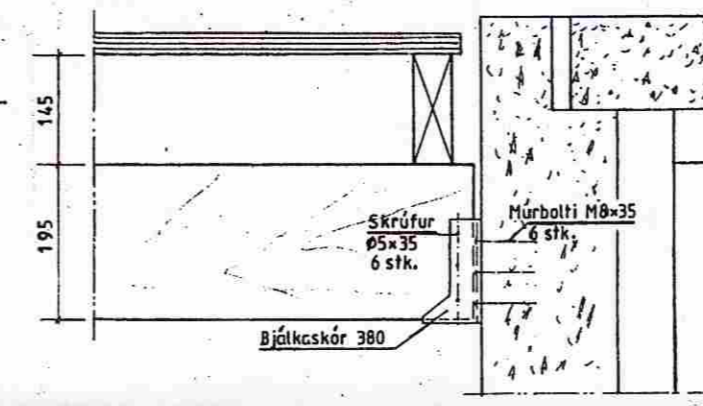

Snið C-C 1:10

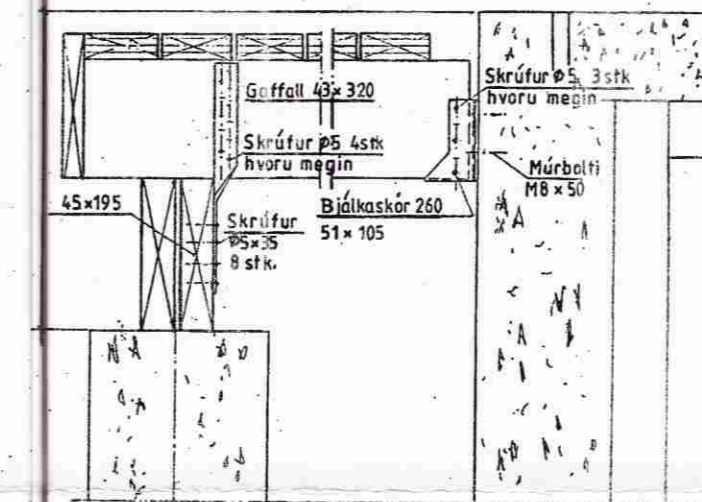

Snið D-D 1:10

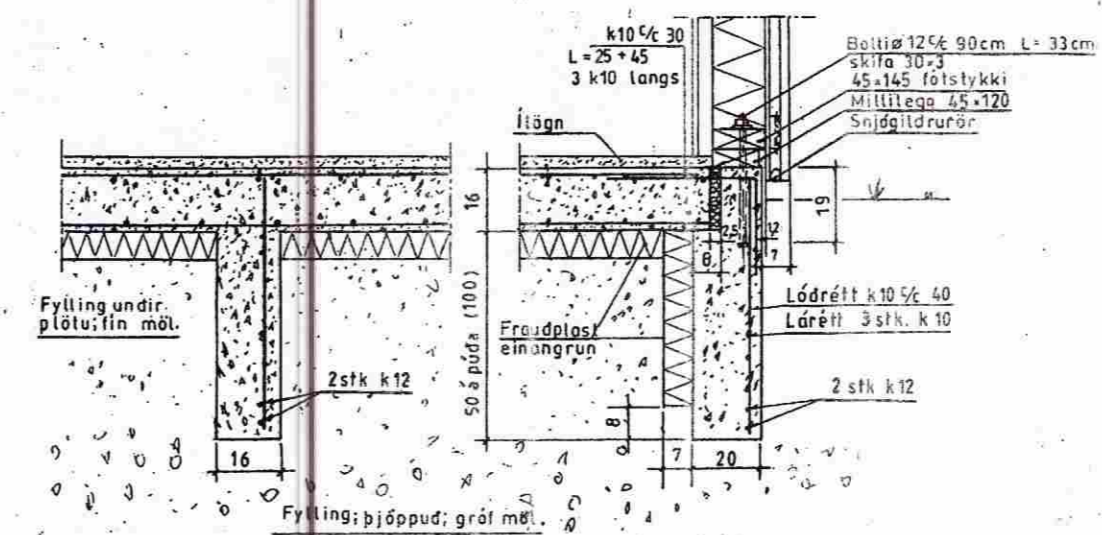

Snið B-B

Snið A-A

1:20

Mkv. 1:50, 1:10, 1:20	Sumarhús í landi Hraunkots 8719 Grímsness og Grafningshreppi Árn. lóð nr. 14 V/Bakkavík stærð 5100 m ²	TEIKNIVANGUR
Dags. maí '09	Eigandi: Sigurdur I. Geirsson kt. 221058-3219	27033-2559
Nr. 246-04	Sökkull ofanvarp. Burdarþol	201032-4829