

Uv5

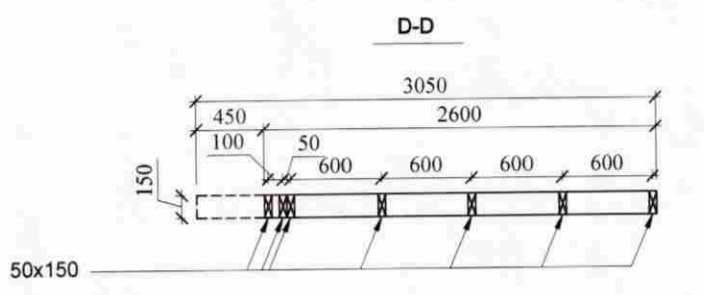

Uv6

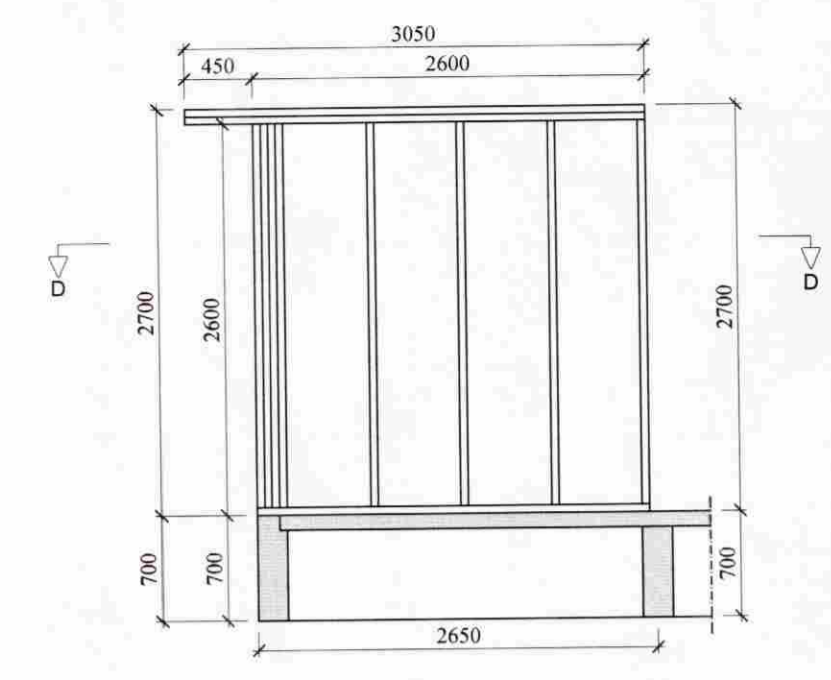
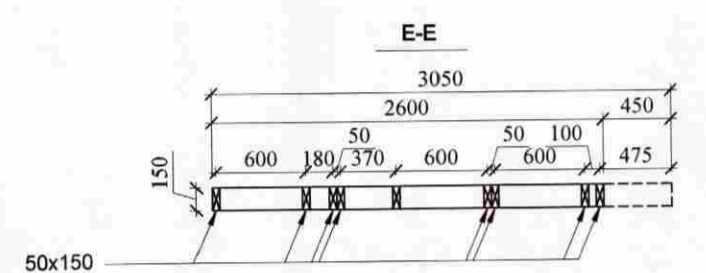
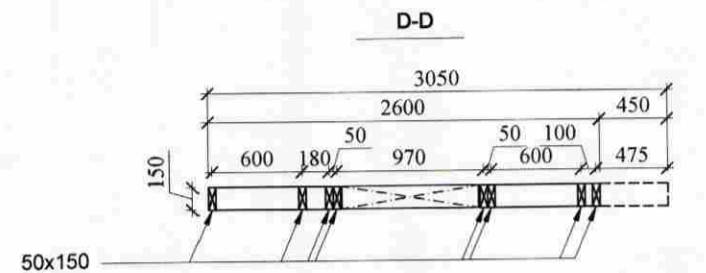
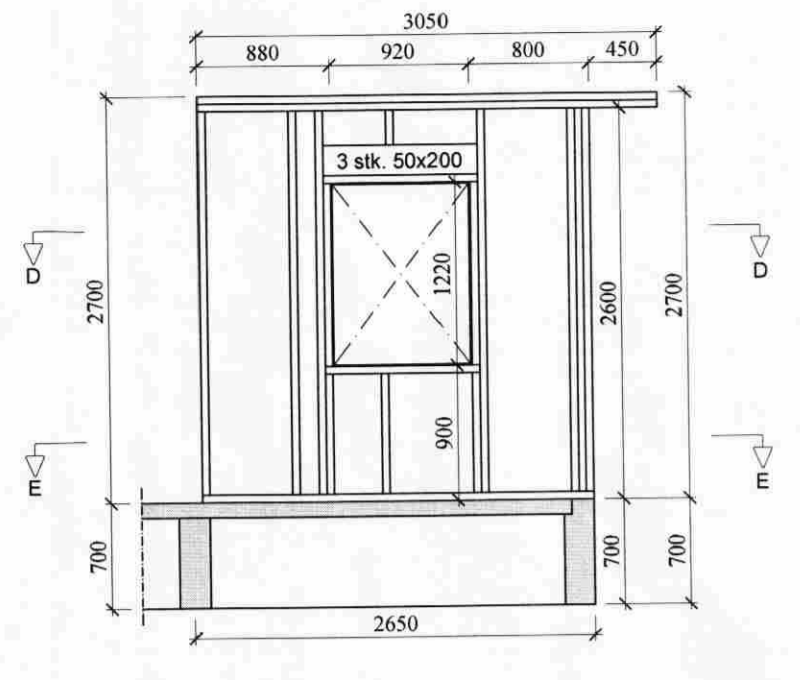

Uv7

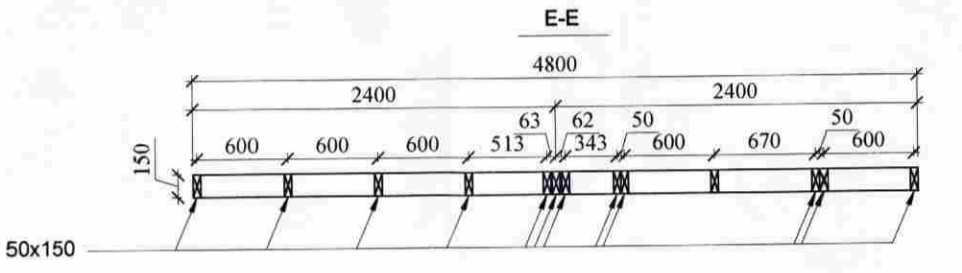
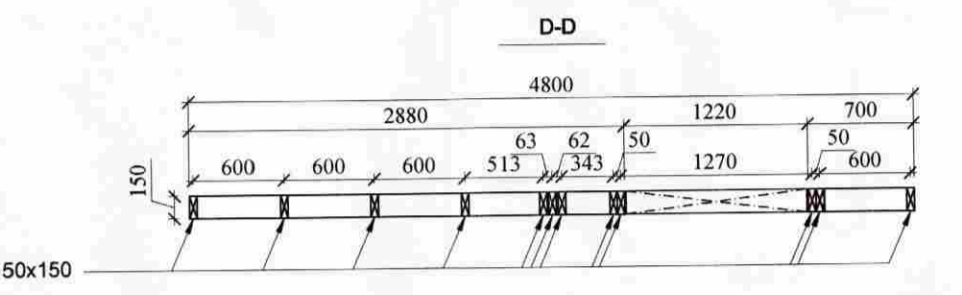
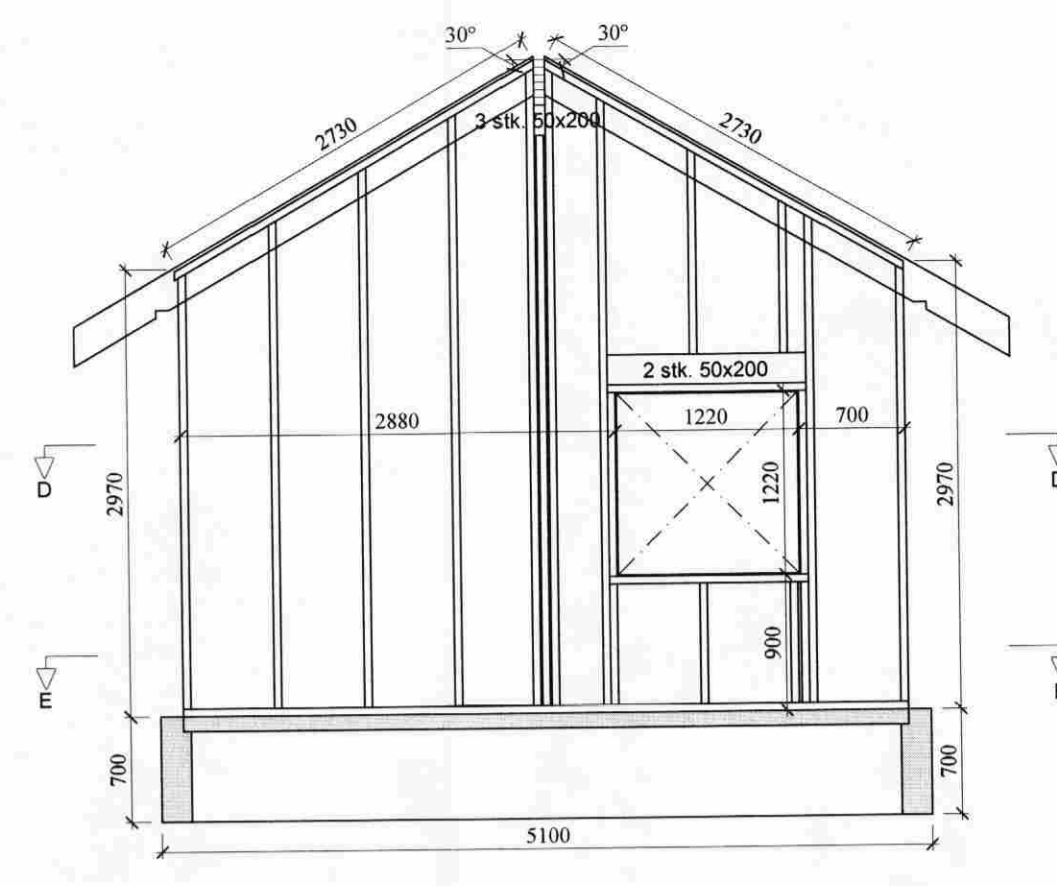

Uv11

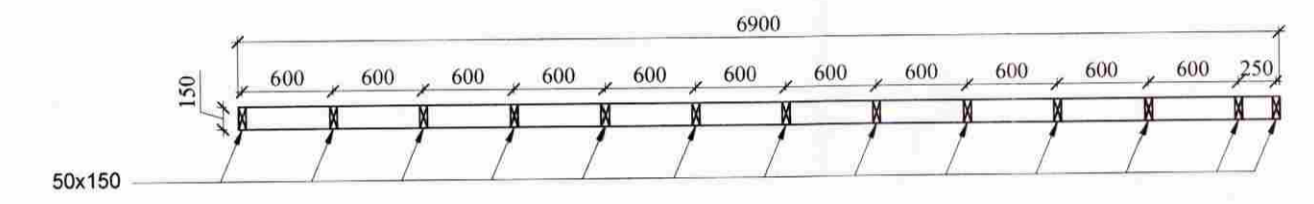
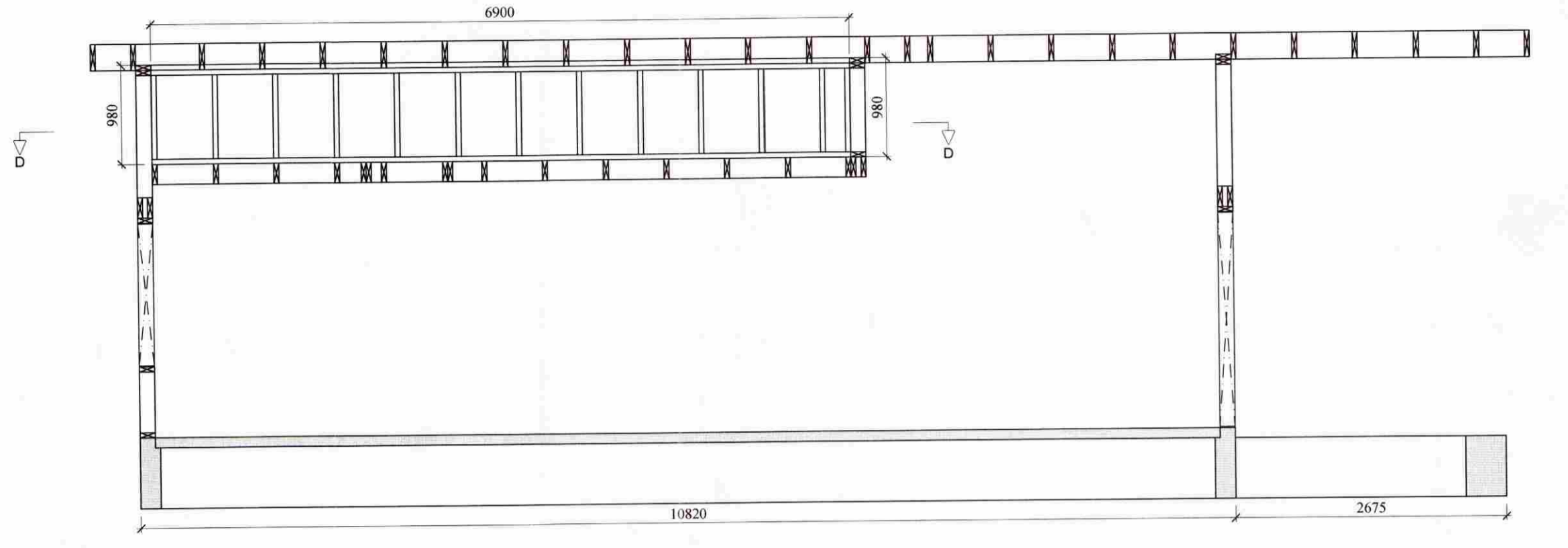

Uv8

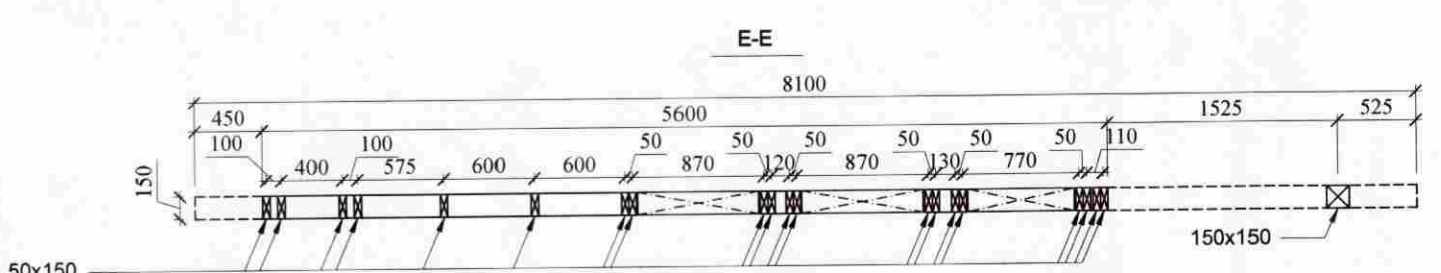
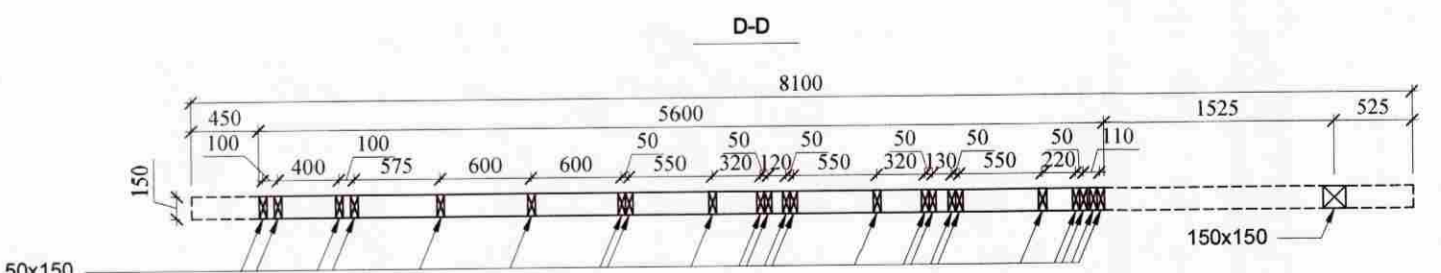
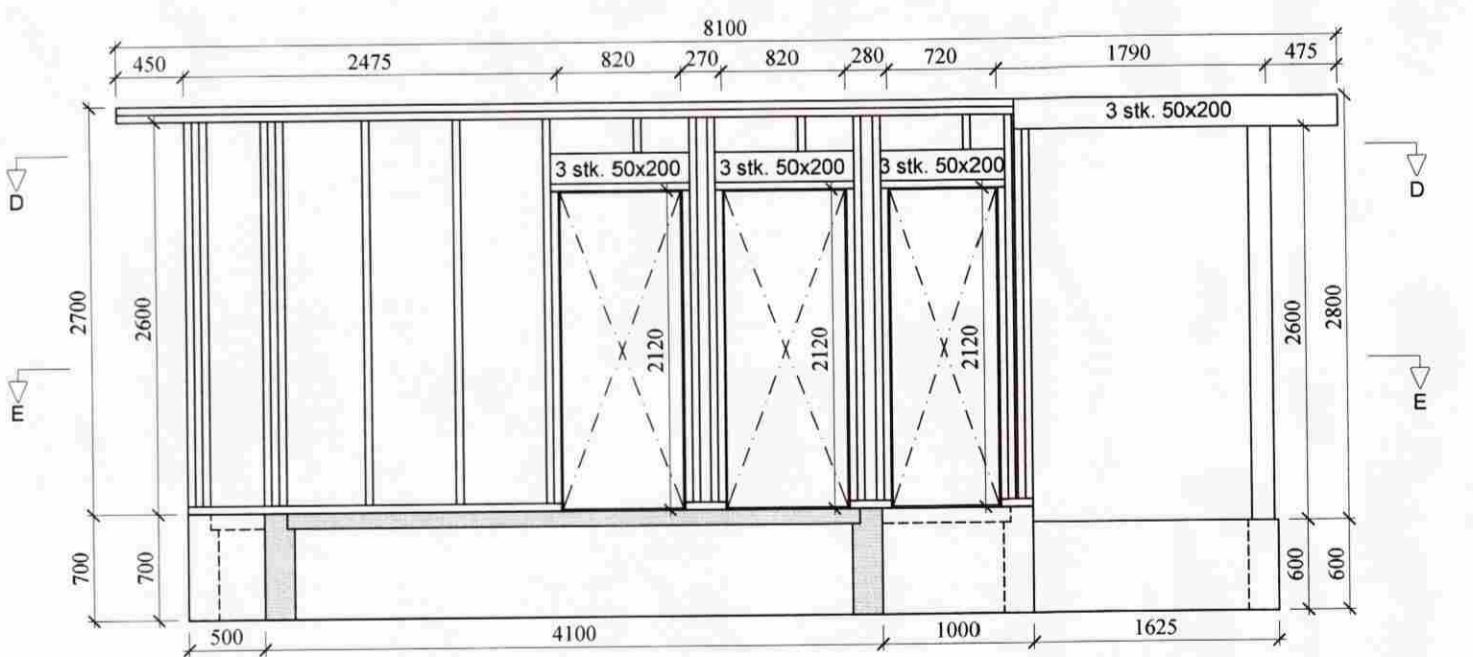

Uv10

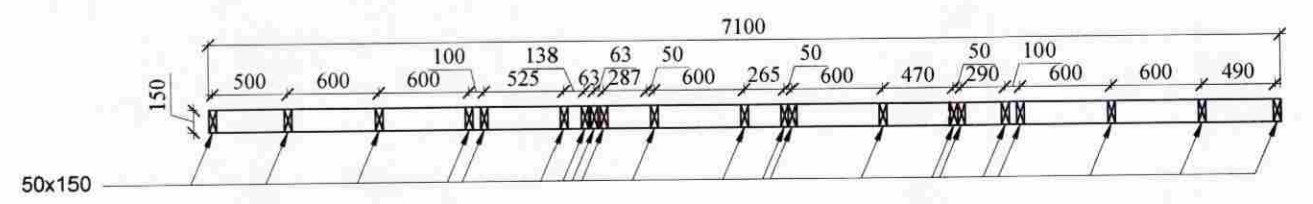
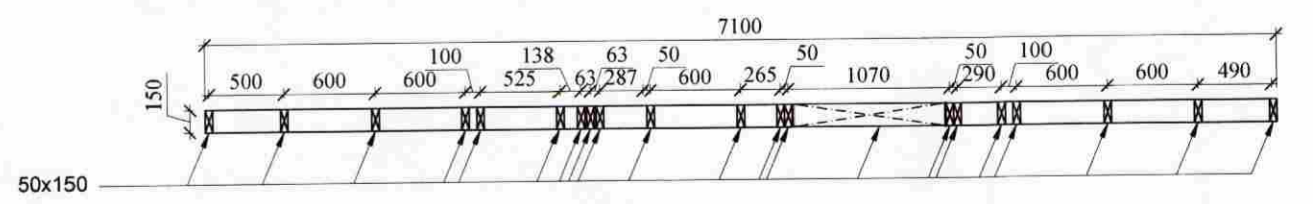
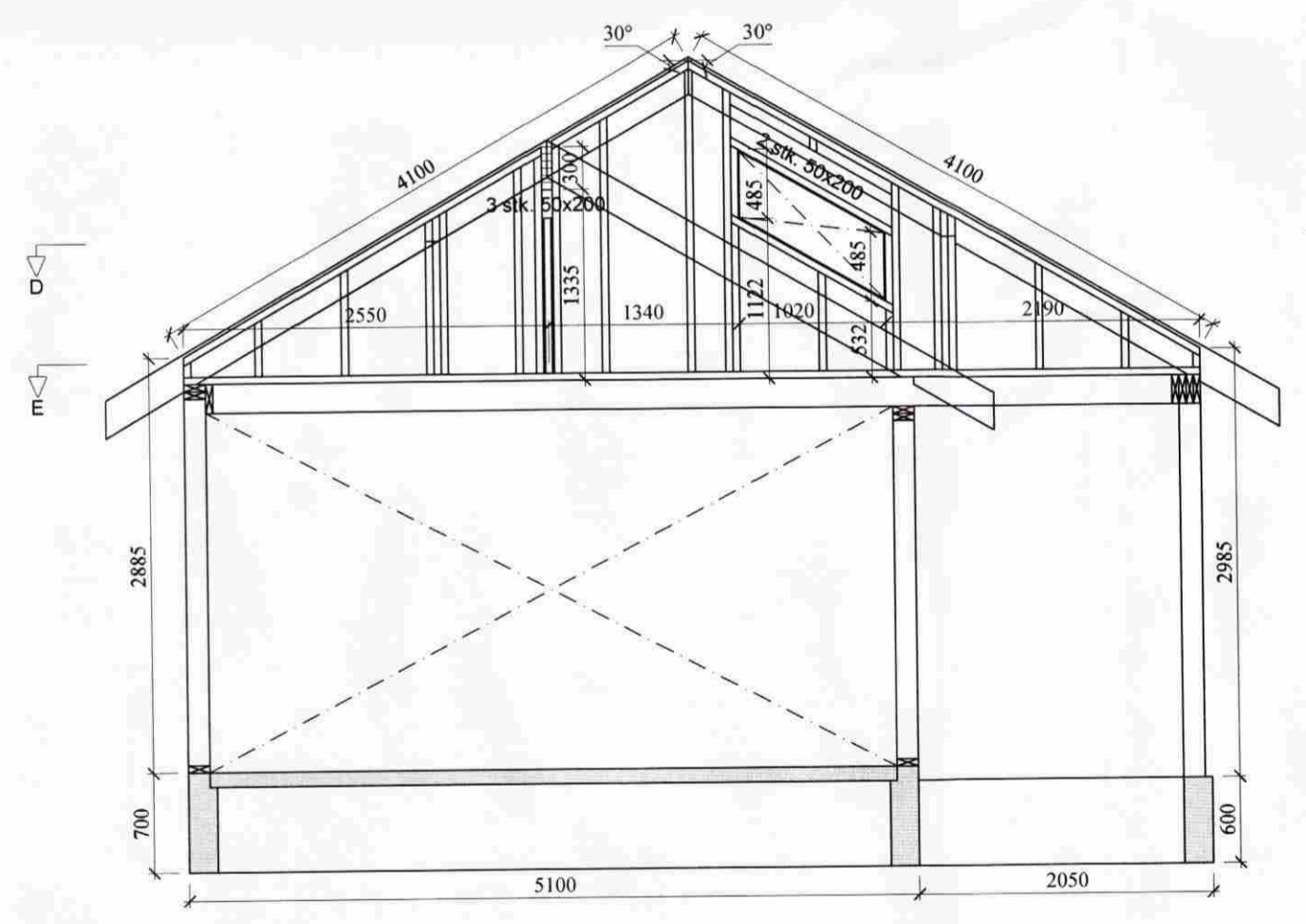

Uv12

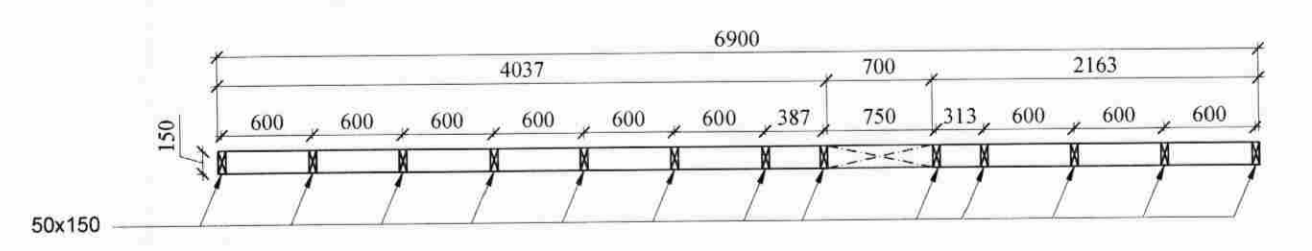
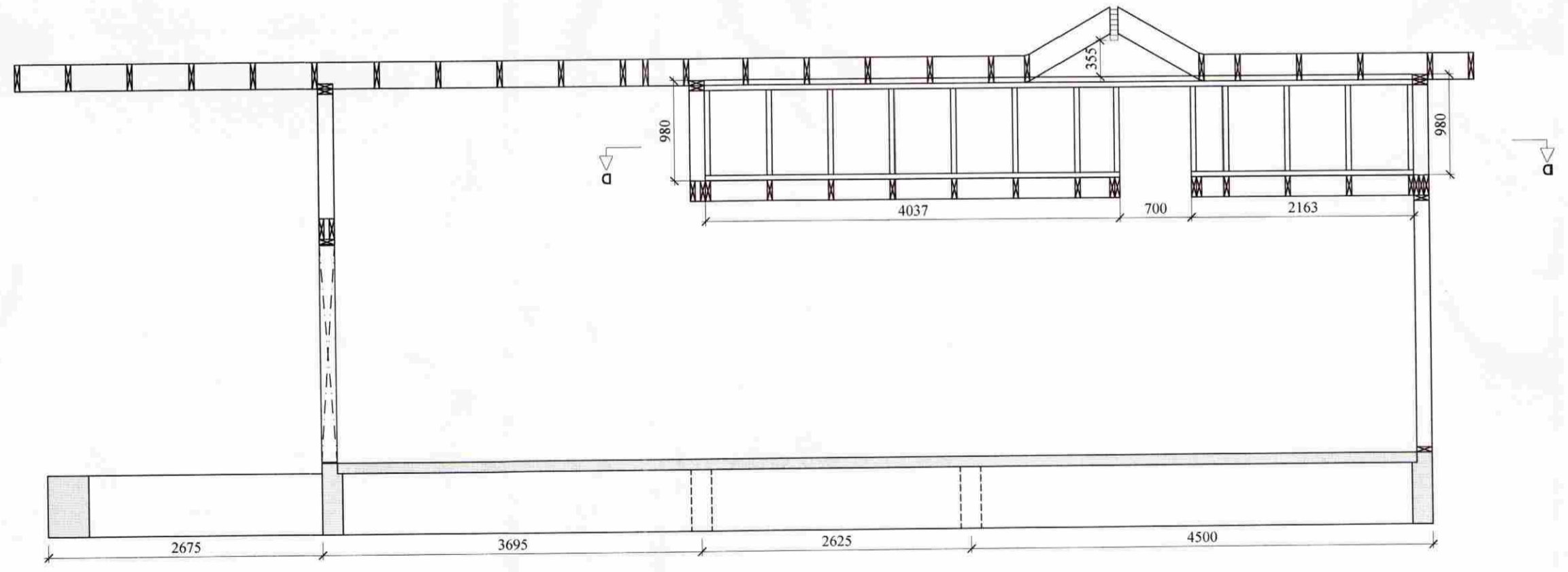

Athugasemdir og skýringar sjá B001
Allar málsetningar eru í millimetrum

Hámarks álag á sökkla er 0,20MPa
Stálgæði = Ks500
Steyrugæði C25

9mm krossviður negldur með 2,5" galvaneseruðum nöglum c/c 150mm á stoðir og c/c 100mm á reimar.
Timburgæði T1

Í veggur nr.10 nota 12mm krossviður negldur með 2,5" galvaneseruðum nöglum c/c 150mm á stoðir og c/c 100mm á reimar.
Timburgæði T1

Byggingar Lambholt 8, sumarhús í landi Grímsnes- og Grafingshrepps	Byggingar 31.03.09	Skýringar Trégrindarteikningar, ásýnd	B201
Byggingar Jón Kristjánsson Byggingafróðræðingur kí. 210754-4899 jkrist44@gmail.com	Byggingar KA	Byggingar 1:50	Byggingar B201
Byggingar Tilvísun Tilvísun@landi.is	Byggingar Tilvísun	Byggingar Tilvísun	Byggingar Tilvísun