

22
215

01
211

13
214

12
214

13
214

07
214

01
211

13
214

22
214

13
214

05
212

12
215

15
215

16
215

14
215

05
212

02
211

BMF 90 VINKILL NEGLIST
MEÐ 2x4 STK 40/40
KAMBSAUM Í STOÐIR

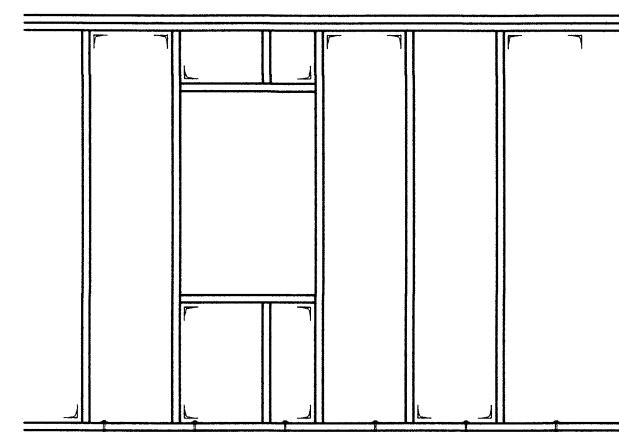

DÆMIGERÐUR FRÁGANGUR
Á VEGG.

Skipulegs- og byggingarfræðingur Yfirfarið 09.11.2014 Byggingarfrungrúi			
DAGS:	NR:	BREYTINGAR:	SAMP:

BMF-320 (45x137) bitaskór.
Negling: 2x5 Stk. K40/40 í sperru
& 2x8 Stk. K40/60 í lfmtré.

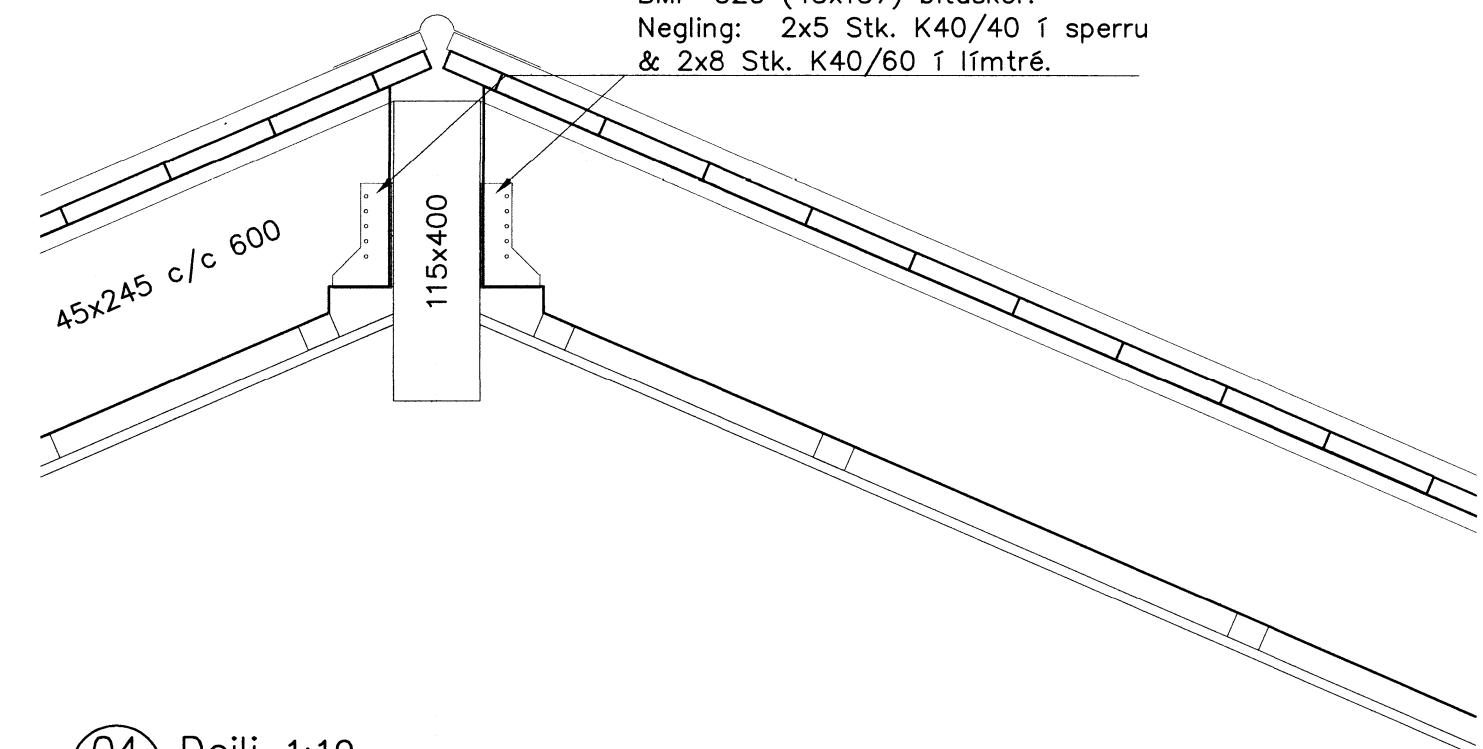

04 Deili 1:10
211

Pakplan
Mkv. 1:50

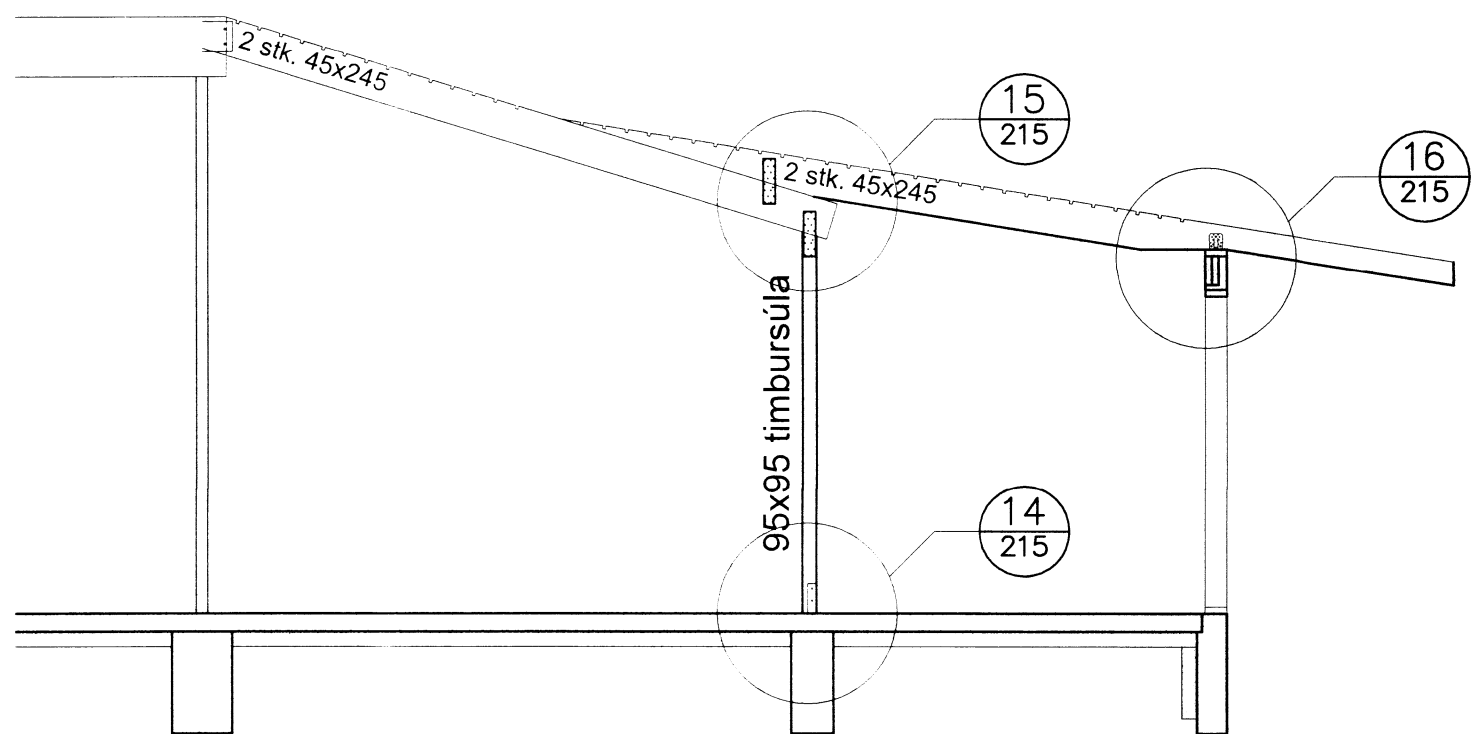

0 1000 2000 3000 4000 5000
1:50

9 mm krossvið á veggi skal
negla með 4,0/40 c/c150
kamsaum en c/c100 í
fótstykki og toppstykki.

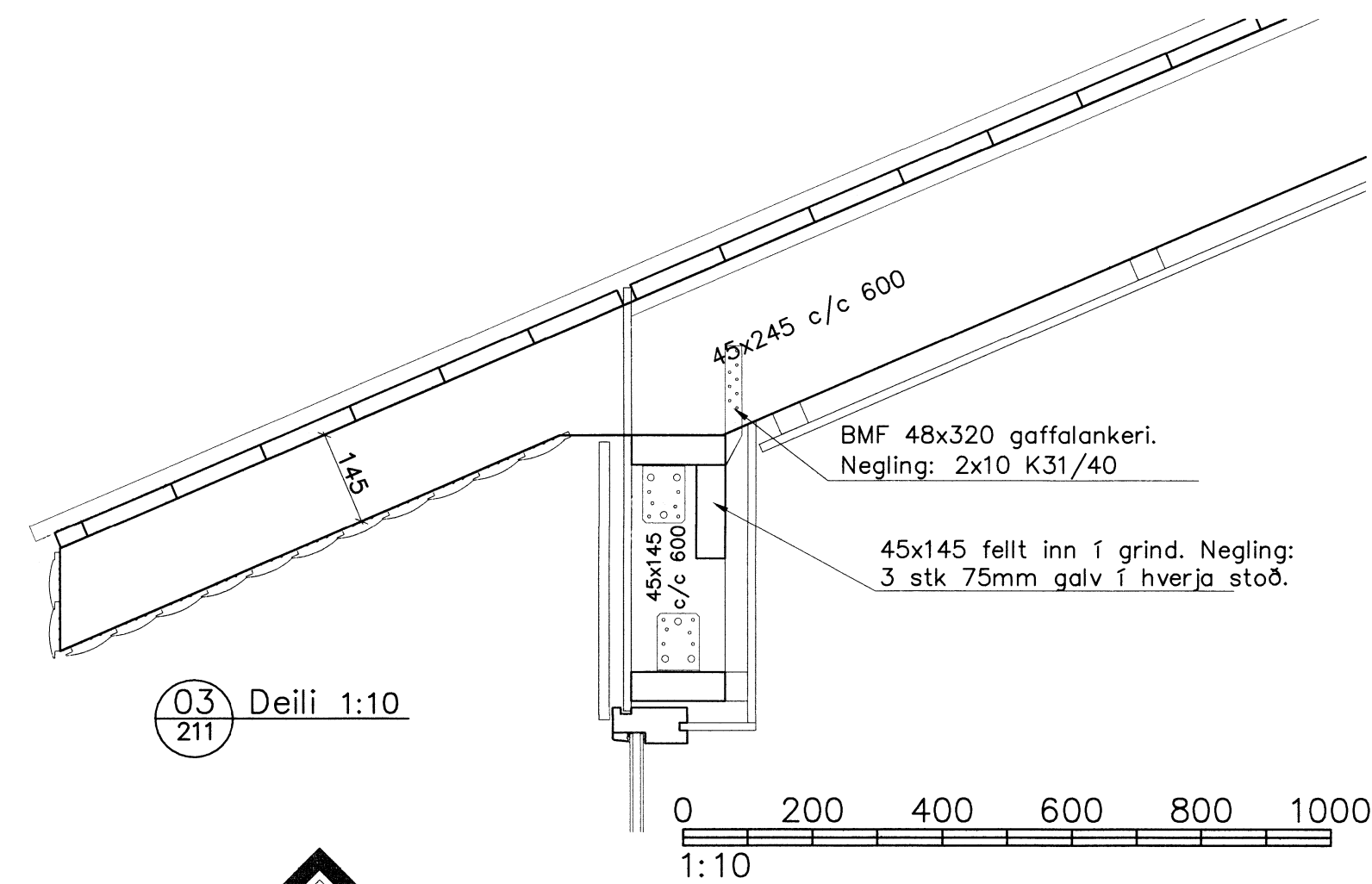
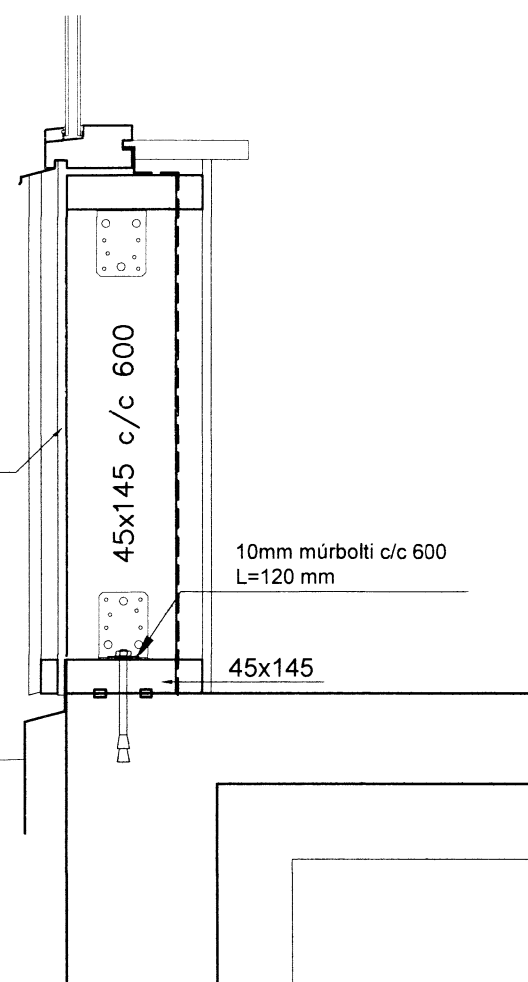

03 Deili 1:10
211

0 200 400 600 800 1000
1:10



SKEIFAN 19 108 REYKJAVÍK Sími: 517 9050 NETTFANG: teknik@teknik.is		DAGS: 19.11.2014	
HEITI VERKS Öndverðanes - Sumarhús Grímsnes- og Grafingshrepp		HOÖNNUÐIR Guðmundur Hansson 151263-3649 Svavar M. Sigurjónsson 180867-3419	VERKNUMER 211 14-69
HEITI TEIKNINGAR Burðarvirki Pakvirki Snið		SAMÞYKKI Einar V. Tryggvason 170242-4599	HÚSAGERÐ MÆLKV: 1:50/10
MIÐNAD: SMS	TEIKNARI: SMS	MÆLT:	TEIKN NR: 212