

Ásýnd, mkv. 1:20

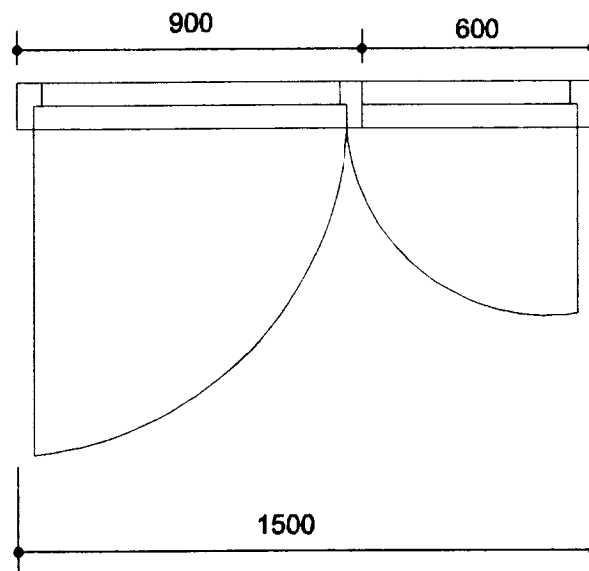

H-1  
1 stk.

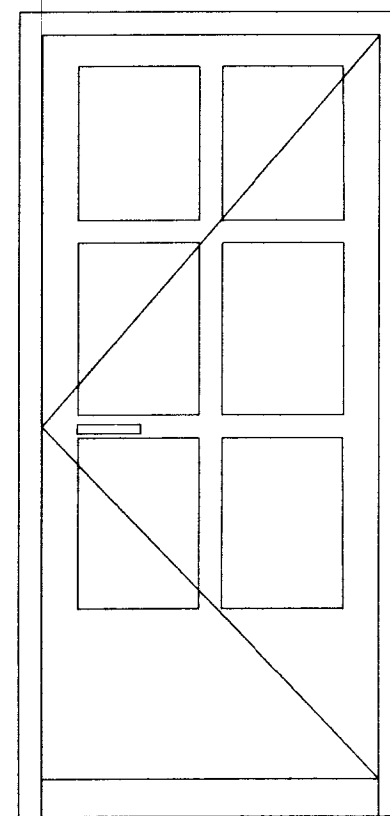
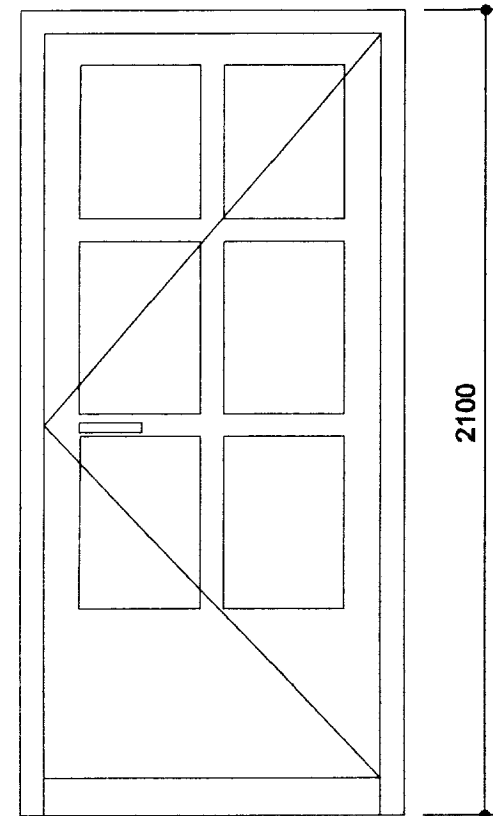
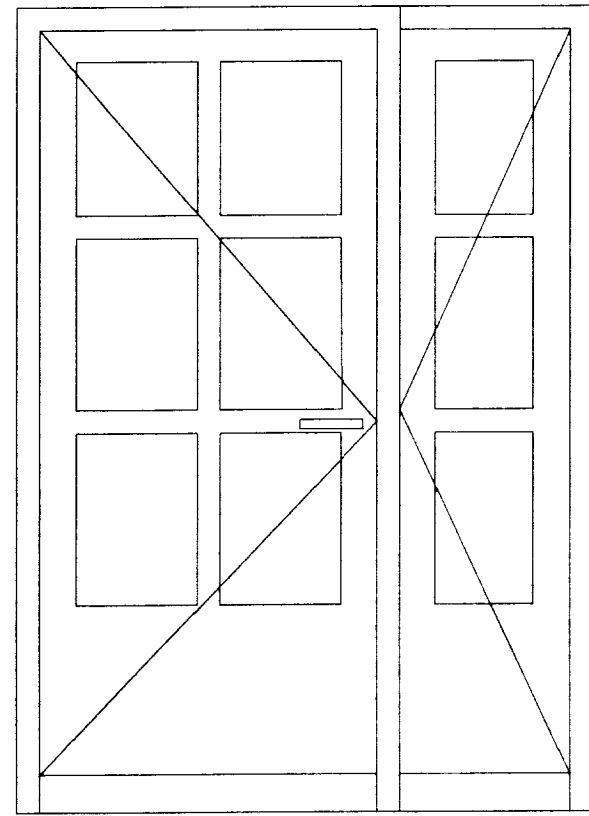
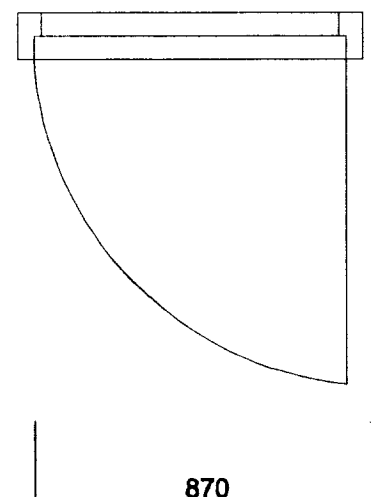

H-2  
1 stk.

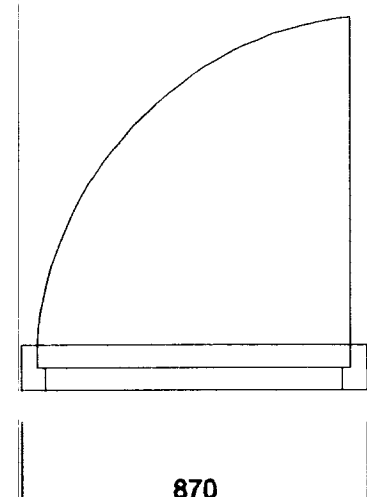

H-3  
1 stk.

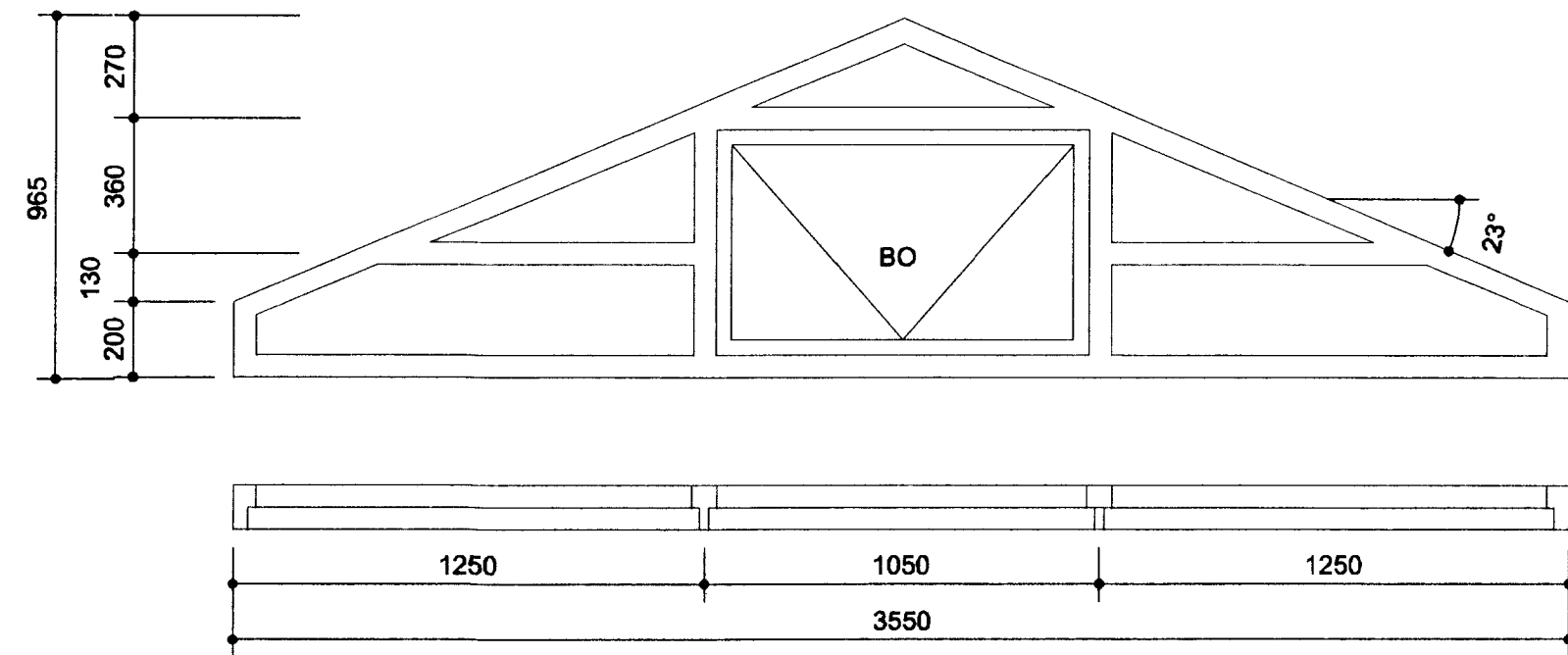

G8- b  
1 stk.

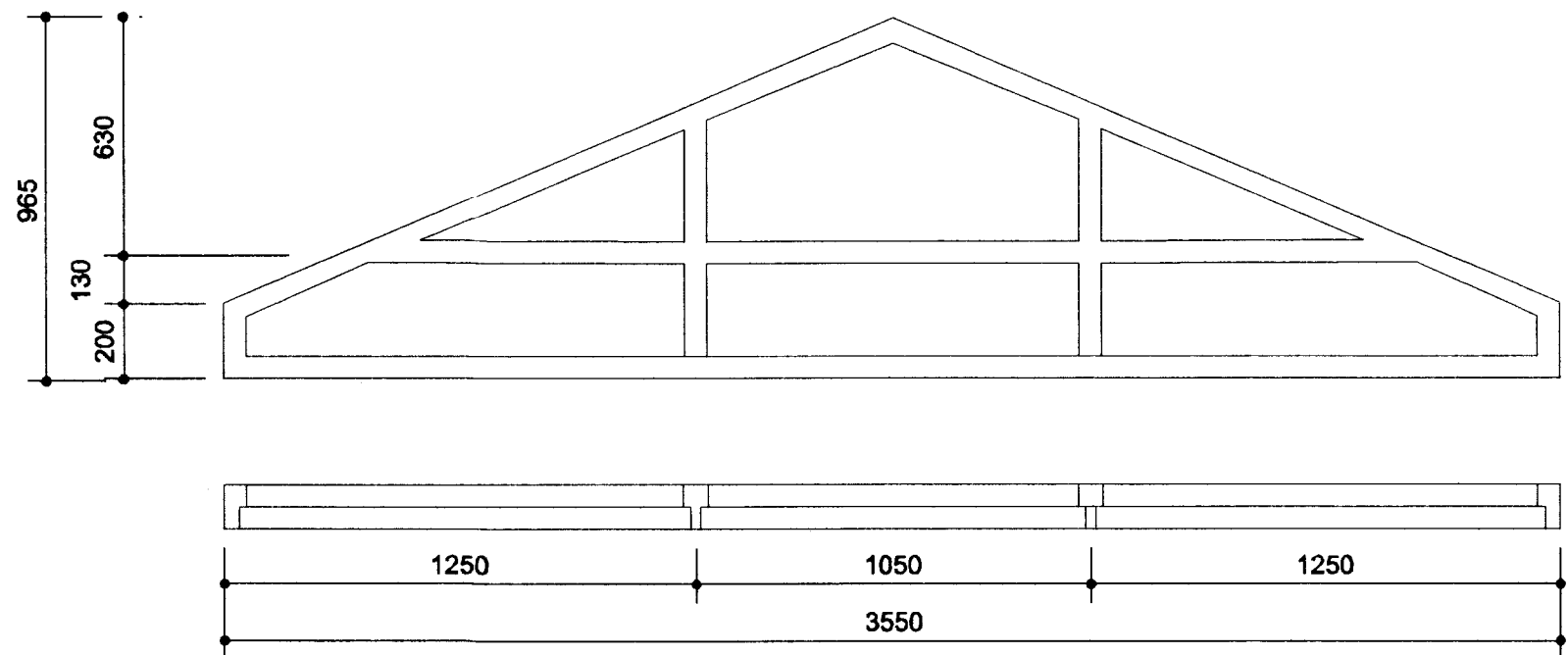

G10- b  
1 stk.

**ATH.**

1. AÐ SAMTALS VERDA GLUGGAR 14 STK, HURÐAR 3 STK. Þ.E. 17 EININGAR
2. AÐ SKOÐA STAÐSETNINGARMYND V/SNÚNINGI Á HURÐUM OG GLUGGUM VIÐ ÍSETNINGU

**SKÝRINGAR.**

GLUGGAR OG PÓSTAR SKULU VERA ÚR FURU.  
 ÖLL OPNANLEG FÖG OG HURÐIR ÚR OREGONE PINE.  
 ALLT TIMBUR SKAL VERA GEGNVARIÐ MEÐ FÚAVÖRN,  
 GALLALAUST, KVISTALÍTIÐ OG HÚSPURRT  
 FÚAVERJA SKAL MEÐ GLÆRRI FÚAVÖRN, A.M.K. EINA  
 UMFERÐ FYRIR UPPSETNINGU

G = GLUGGI  
 ÚH = ÚTIHURÐ  
 SH = SYLAHURÐ  
 BH = BÍLSKURSHURÐ



C					
B					
A					
	Dags.	Breyting.			
VERK: Vidibrekka 13, Grimsnesi			EFNI TEIKNINGAR: Gluggateikningar		
HANNAÐ: GHS	TEIKNAD GHS	YFIRFARIÐ IB	DAGS. 14-12-06	MKV 1:100	BLÁÐ A2 = 1/1
SAMPYKKT: Guðlaugur H. Sigurjónsson			VERKKAUPI:	MINNKUN A3 = 1/1.39	
				TEIKNING NO: 11-006	