

Vindstýfing veggja:  
Endabil klæðast með 12 mm krossviðspötum  
Plötur neglast með 50 mm saum c/c 100

Grind norðurhlíðar, 1:100

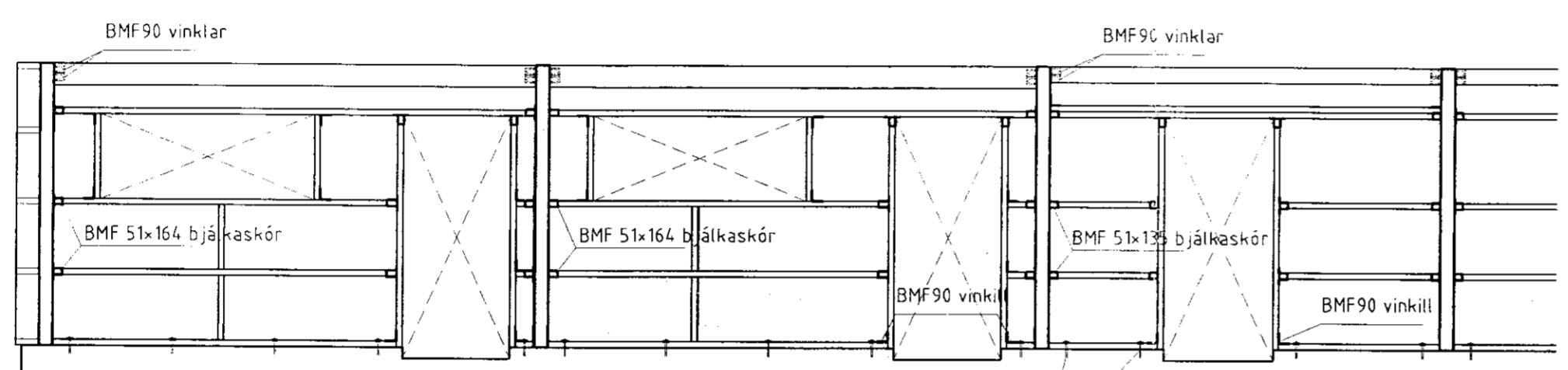

Staðsetning og gerð festinga - skýringarmynd 1:50

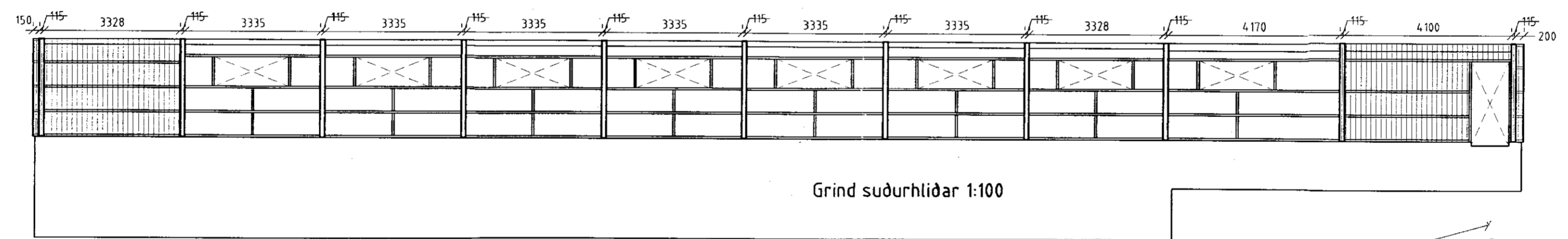

Grind suðurhlíðar 1:100

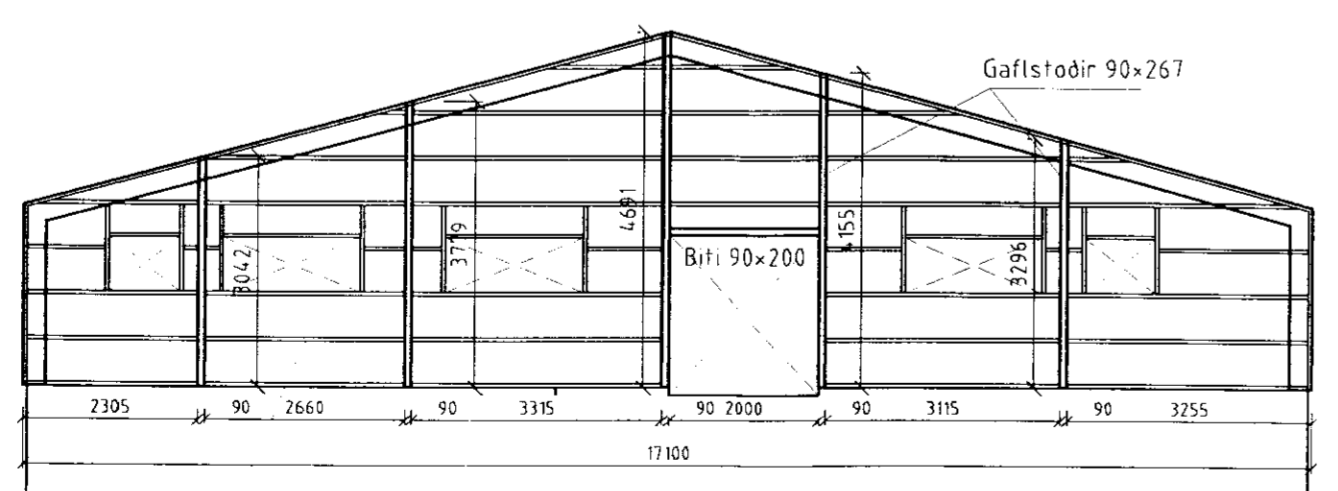

Grind austurgafls 1:100

Langbönd 50x200 c/c 600

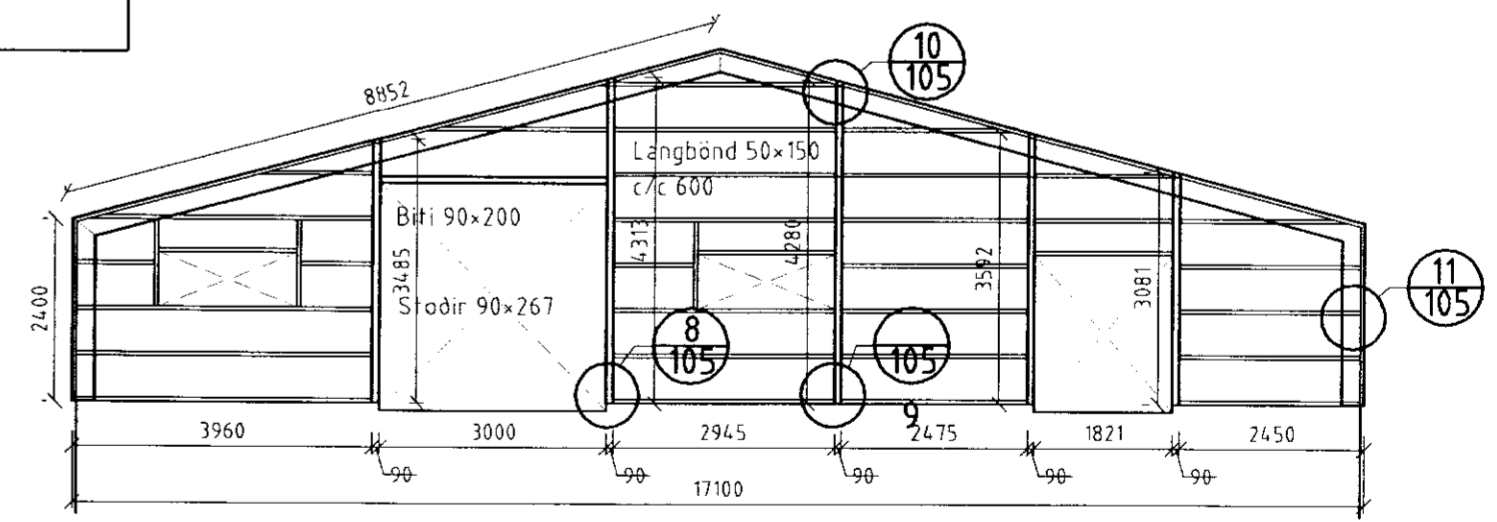

Grind vesturgafls 1:100

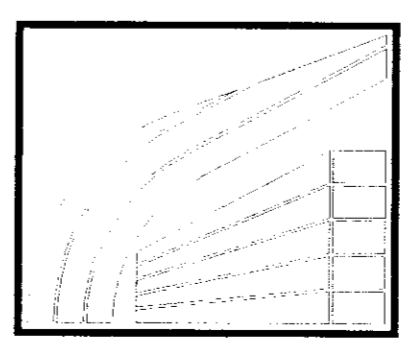

**LÍMTRÉ HF.**

Hlíð, Gnúpver jehr., Árn.

Fjós - Yfirbygging

Límtrésgrundur

L-98060015-02	
GG	14.12.1998
GG	98060015
1:100	<b>102</b>

*Eisti Eiríksdóttir*