

FASTING LAKJÓR 1:10

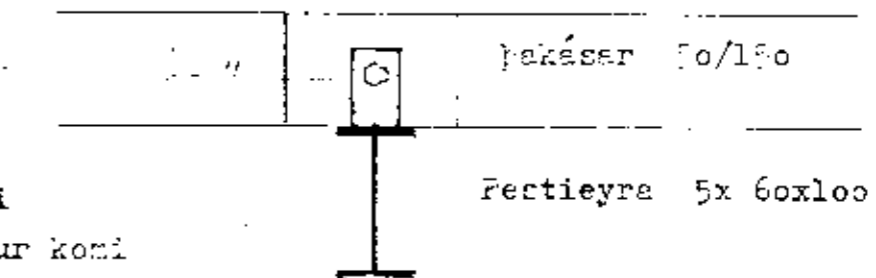

12 mm bolti
undir timbur komi
skinna 4x40x40

FASTING VEGGJÓR 1:10

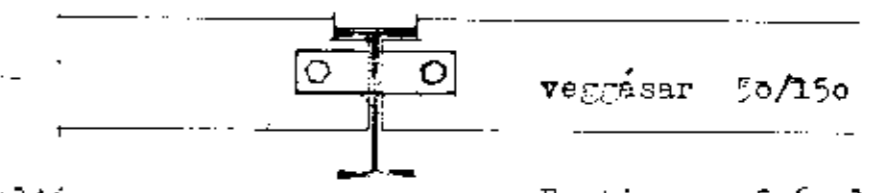

10 mm bolti
undir timbur komi
skinna 4x40x40

SMI 3-5 1:20

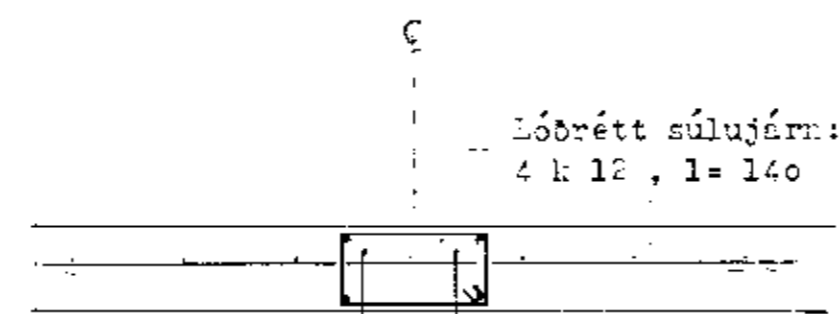

Lóbrétt súlujárn:
4 k 12, l=140

Lýkkjur $\emptyset 8$, l=110
2 stk í hverja súlu

Aukatengijárn:
2 stk við hverja súlu
l=30+50=80

SMI 1-2 1:20

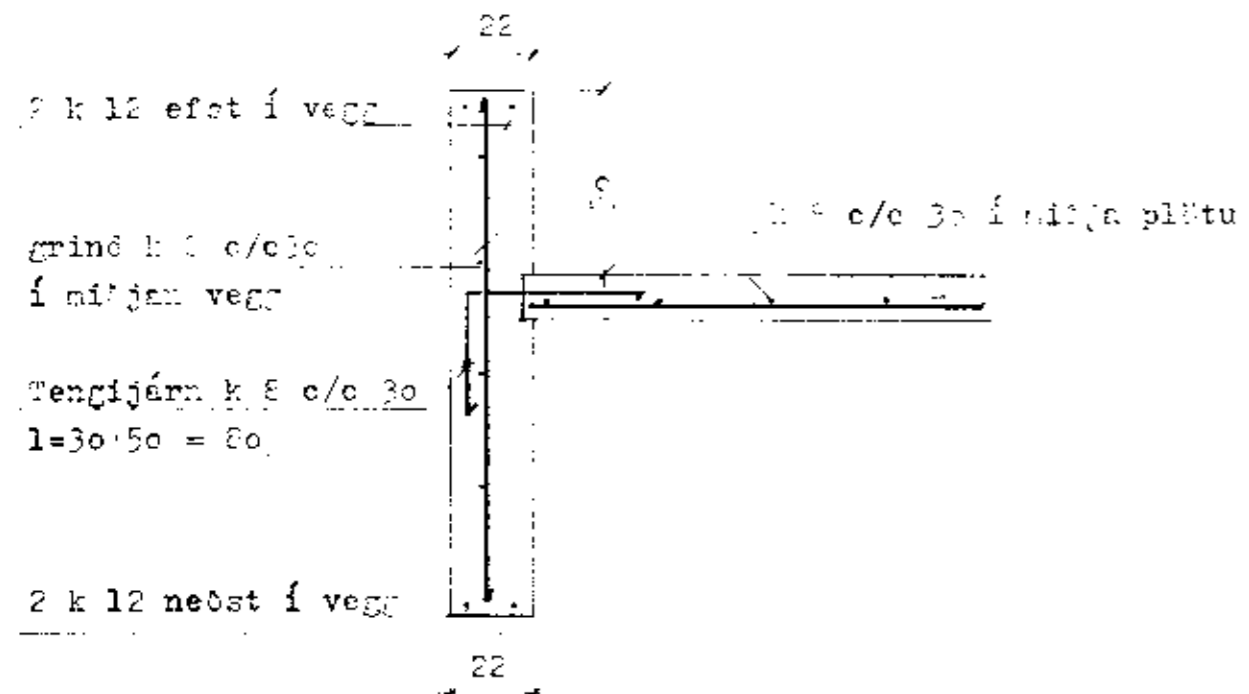

2 k 12 efst í vegg

grind k 8 c/c 30
í miðjum vegg

Tengijárn k 8 c/c 30
l=30+50=80

2 k 12 neðst í vegg

BL BYGGINGASTOFNUN LANDBÜNADARINS
LAUGAVEGI 120, REYKJAVÍK, SÍMI 25444

Langanjóni, Skeldahl, Árn.

Hlaða - Stálgrind og fleira

Sig. Sigurdsson

TEIKN NR. 30-5389

BLAD NR. 51

MÆLIKVARDI 1:100, 1:20

DAGSETNING MAÍ 1968

HANNAÐ GG