

Grunnmynd veggjastoðir mkv. 1:50

Ásýnd vegggrinda mkv. 1:50

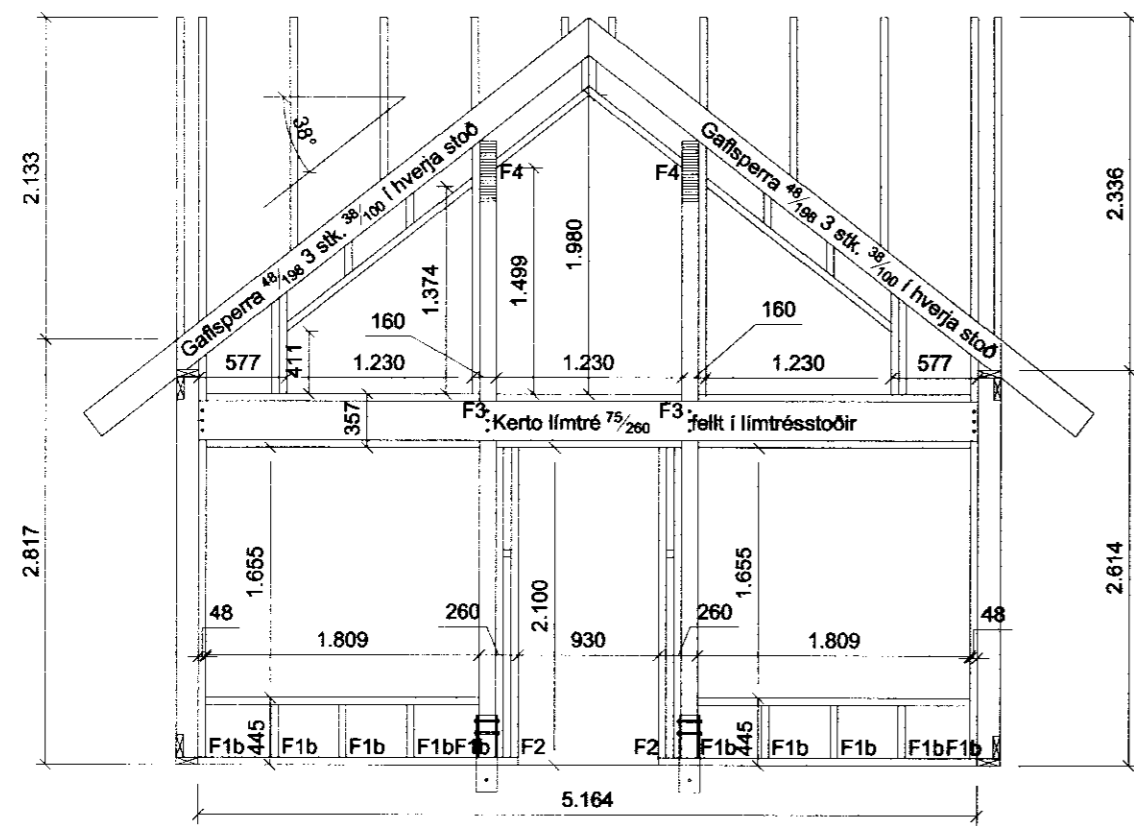

Grind nr. 1

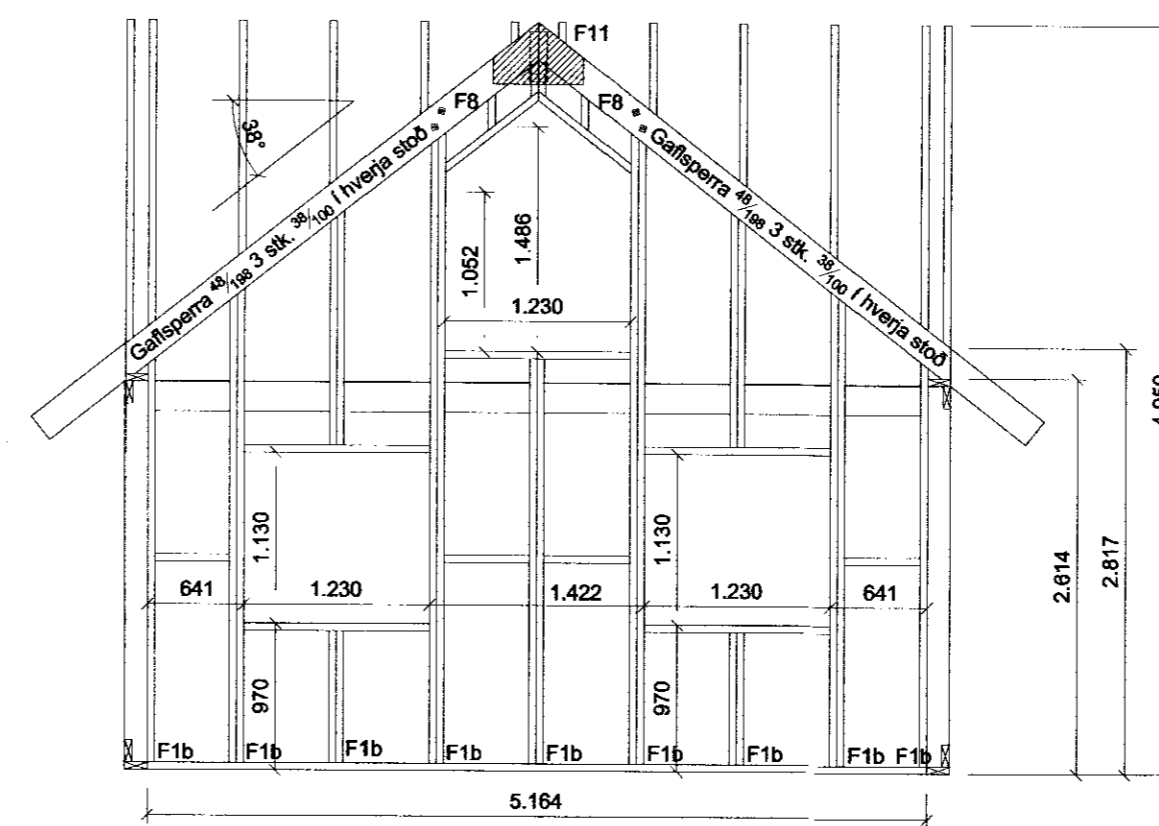
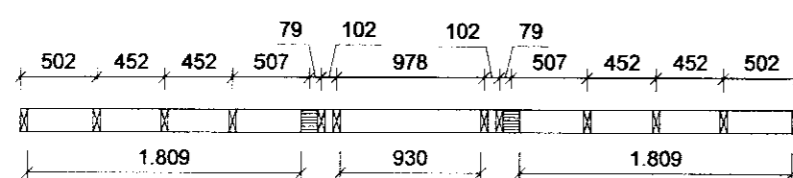

Grind nr. 3

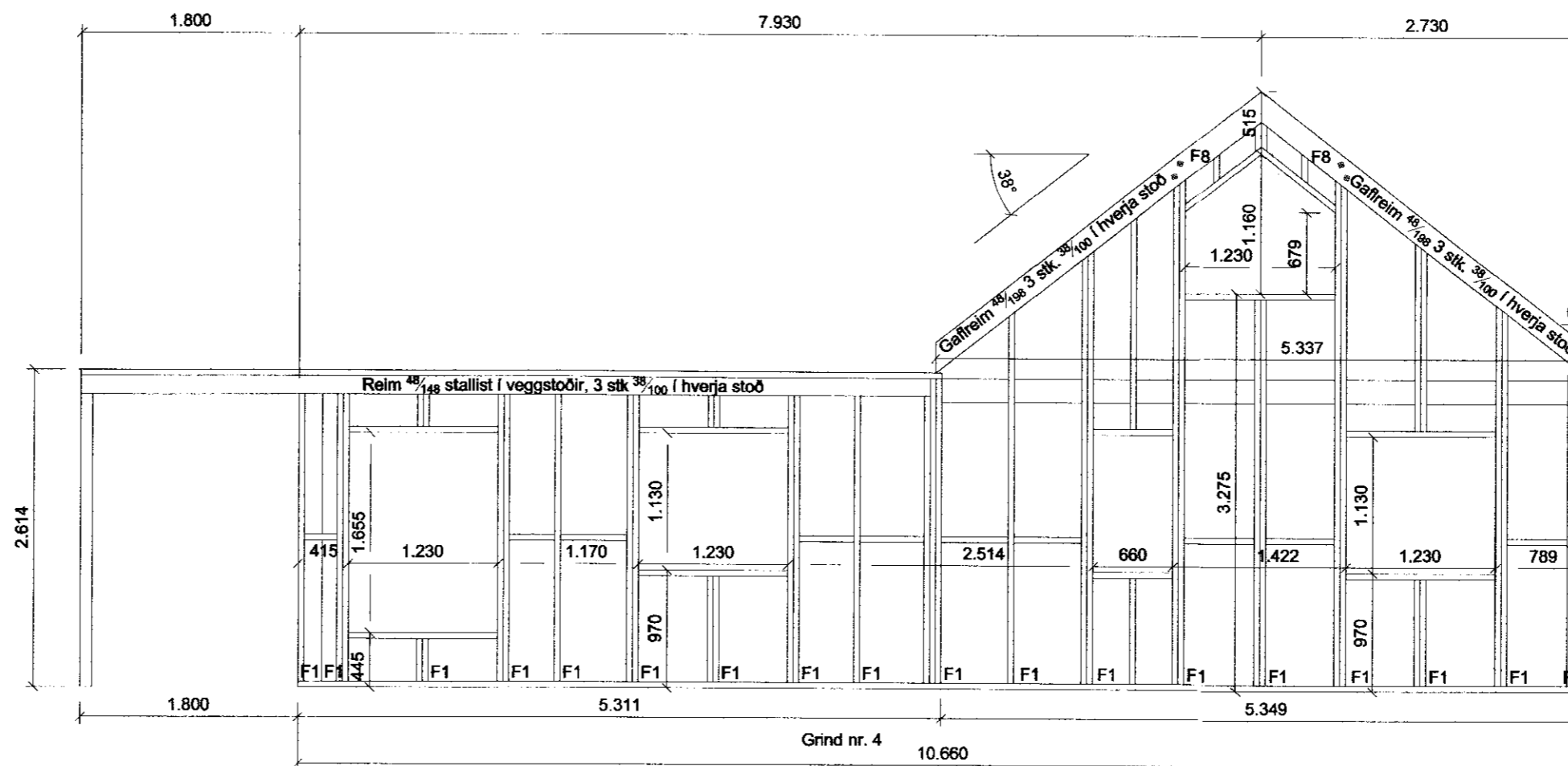
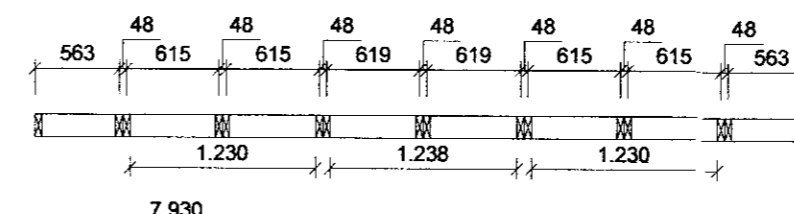

Grind nr. 4

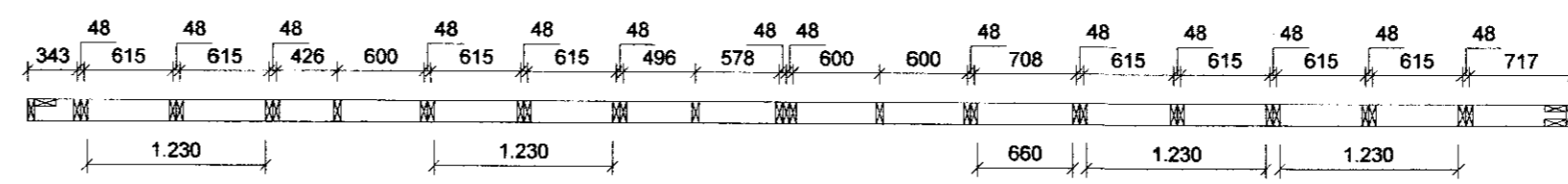

Ásýnd vegggrinda mkv. 1:50

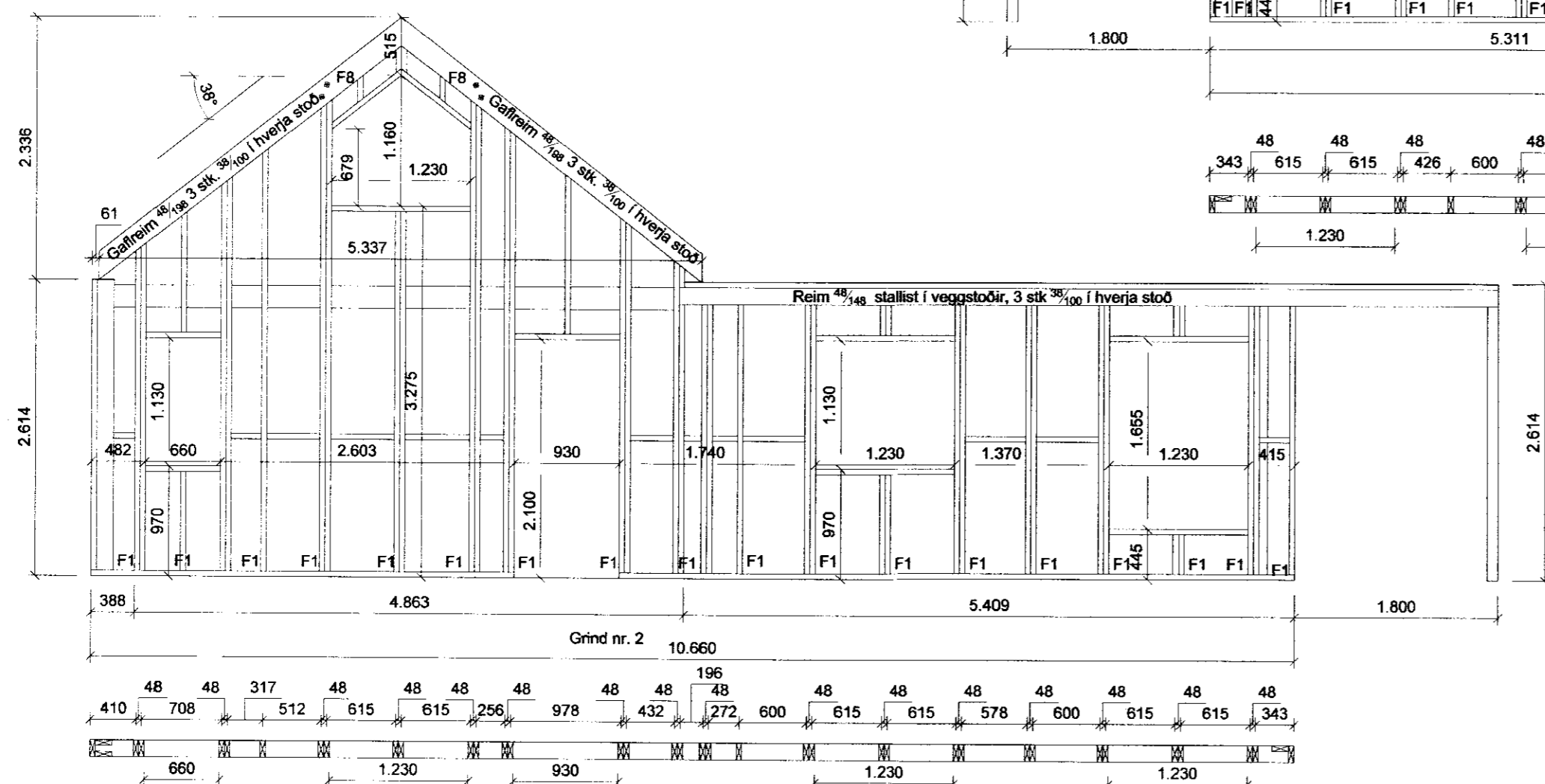

Grind nr. 2

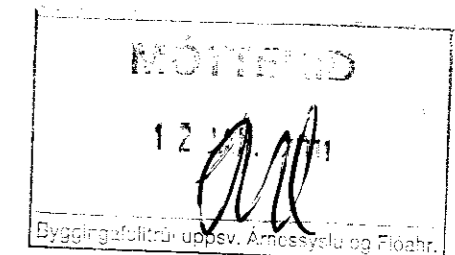
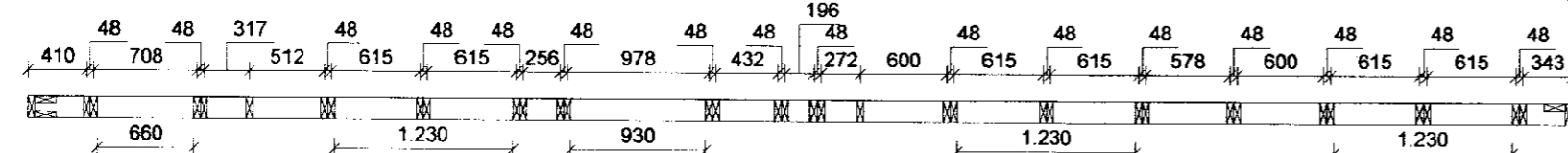

Almennt:

Öll mál skulu staðfest skv. aðalteikningum. Ef eitthvert misræmi er skulu aðalteikningar vera ráðandi, þó þer að láta hönnuði vita af misræmi. Öll mál eru í millimetrum, nema annað komi fram.

Skýringar - trévirki veggja

Allur viður er K18 eða betri skv. DS413.

Allan við utanhúss skal fúaverja. Allur saumur og festingar utanhúss skulu vera heitzinkhúðaðar eða ryðfríar. Allar stoðir og lausholt eru <sup>48</sup>/<sub>148</sub> nema annað sé tekið fram.

Bíl á milli miðjúlínu stoða skal ekki vera meira en 600 mm. Utan á grind komi 9 mm gufuopinn rakapoliinn krossviður (t.d. birki-krossviður). Krossviður festist með <sup>28</sup>/<sub>65</sub> C150 í rakapolið ílm.

Br. nr.	Dags.	Af.	Breyting
(A)	2010-09	JHG	Kvistir og þakhalli
(B)			
(C)			
(D)			
(E)			

Iða II (fjallið) lóð nr. 9  
801 Bláskógabyggð

Teikn nr:  
201

Burðarvirki  
Veggjagrindur

Frumstærð:  
A2

Dags: 2010-09 Mkv. 1:50 Hann: GPS

Samb: *[Signature]* 020162-3099 V.nr: 10-003 Teikn: JHG

**VGS**  
VERKFRÆÐISTOFA  
GUÐJÓNS P. SIGFÚSSONAR EHF.  
AUSTURVEGI 42, 2. HÆÐ,  
800 SELFOSSI  
S: 482 2805, F: 482 3818  
NETFANG: VGS@VGS.IS