

sperra 45x220 mm
skambbiti 45 x200 mm
lengd 4800 mm
bolti 2 stk 12x140 mm skinna
3x32x32 mm

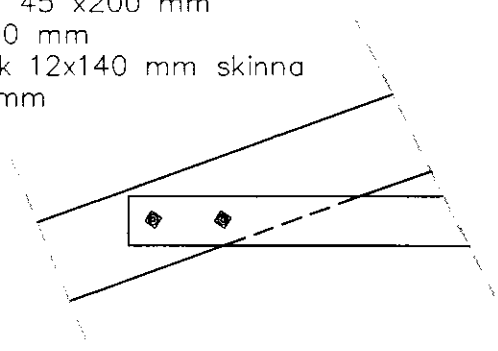

deili 3 í skambbita

sperra 50x225mm
laski 25x150x460 mm
beggja megin
negling 2,8x75mm
7+7+7+7

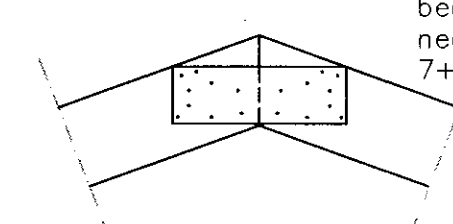

deili 4 í mænir

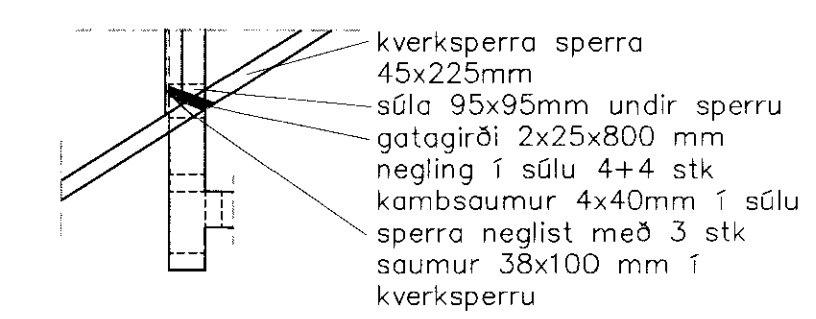

deili 5 súla undir kverksperu

sperra 45x220 mm c/c 600mm
reim 45x95mm
vinkill 90x90 mm beggja megin
sperru negling kamb.4x40 mm
5stk
12x 80 mm bolti í gegnum
vinkil skífa 3x32x32 mm
gatagirði 2x25x400 mm negling
2,8x75 mm saumur 3+3

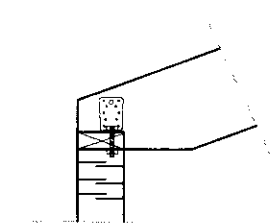

deili 2 reim í þakkannt

sperra 50x225mm
laski 25x150x460 mm beggja
megin
negling 2,8x75mm 7+7+7+7

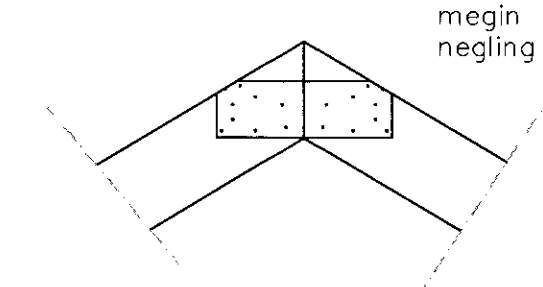

snið 2 mænir

stoð 45x95 mm c/c 600mm
reim 45x95 mm

bmf 90 vinkill með styrkingu
negling ks 4x40 mm
múrbolti 250 mm
boltist í gegn um vinkil og í
steypulým c/c 600 mm
bolti nái lágmark 150 mm í
steypu

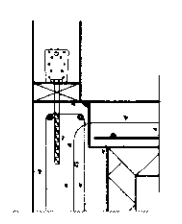

deili 1. 1:20

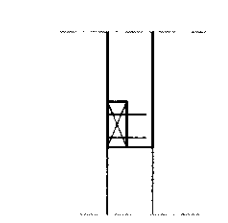

stoð 45x95 mm c/c 600mm
biti 45x95 mm
2 stk 38x100 mm saumur í
hverja stoð

snið 1 yfir glugga

170339

Miðfell Bláskógarbyggð
Viðbygging

Burður
Deili / snið

| | |
|-------------|-------------------|
| Mál 1:20 | Teikn. nr. 2 af 5 |
| teiknað: SA | dagss. 10-03-2010 |

Hönnuður: *Eiríkur Arnarson*

SA teiknistofa
Gvendargeisla 40

Sveinn Arnarson BFI Kt. 15076
Eiríkur Arnarson TFI Kt. 280