

Teikningaskrá		DL23 022
Nr.	Heiti	Mkv.
301	Þakmynd, þversnið A & þversnið B	1:100, 1:30
302	Sérmyndir	1:10
361	Stálfestingar - framleiðsluteikningar	1:5
381	Límtré - framleiðsluteikningar	1:20
382	Límtré - framleiðsluteikningar	1:20

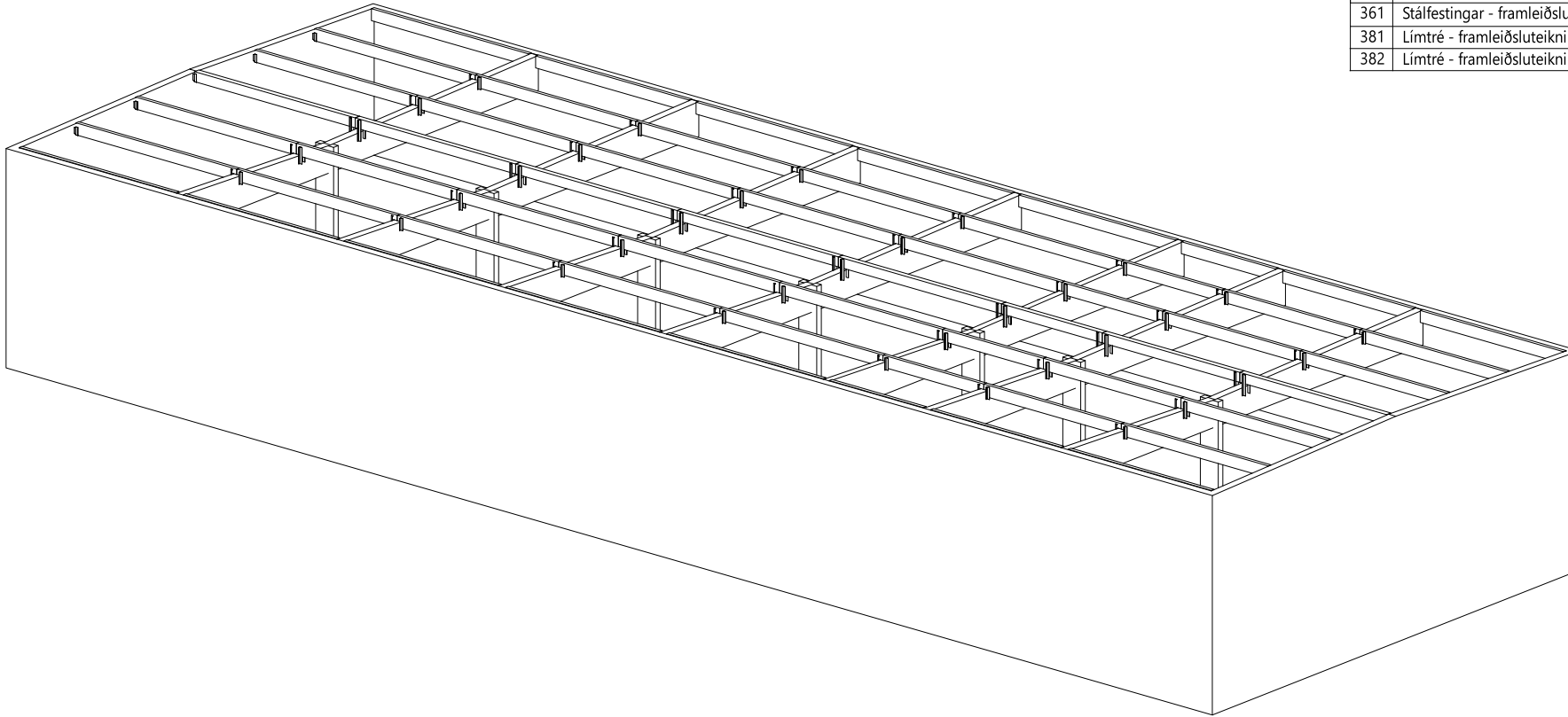

LímtréVjrnnet

Apríl 2023

Bjarni H. Ingibergsson
byggingartæknifræðingur B.Sc.

Flúðaskóli
Endurnýjun þaks
Burðarvirki þaks úr límtré

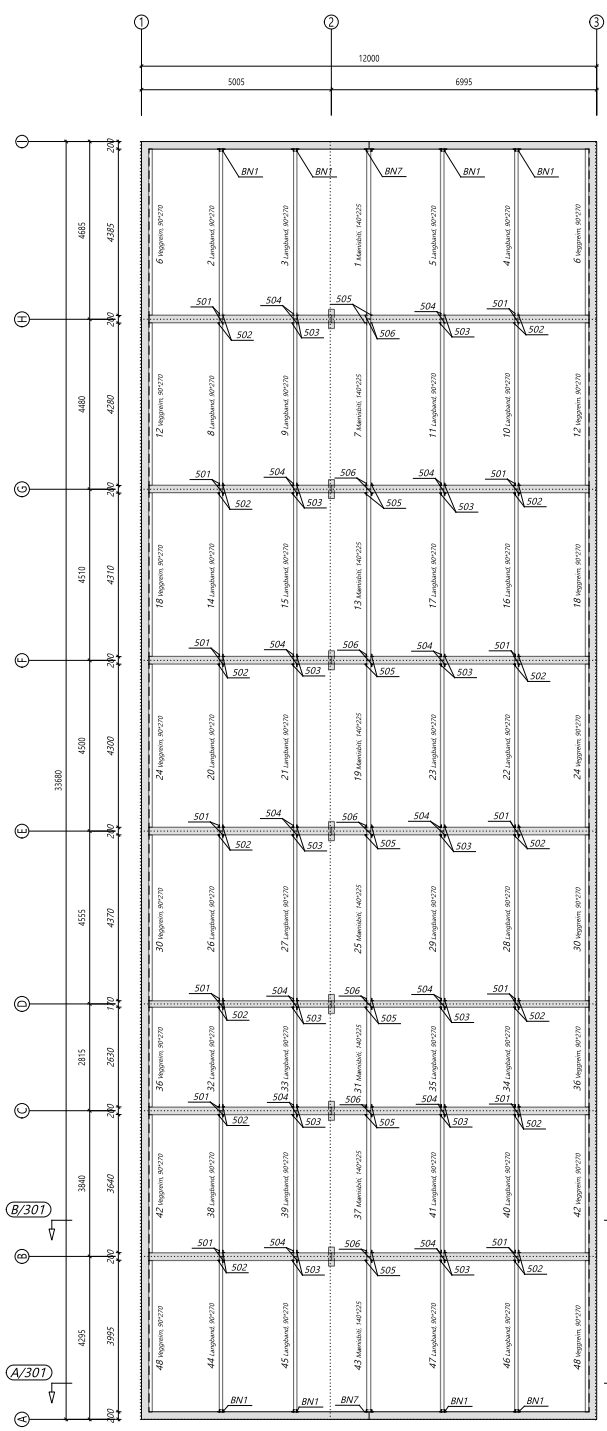

Þakmynd Mkv. 1:70

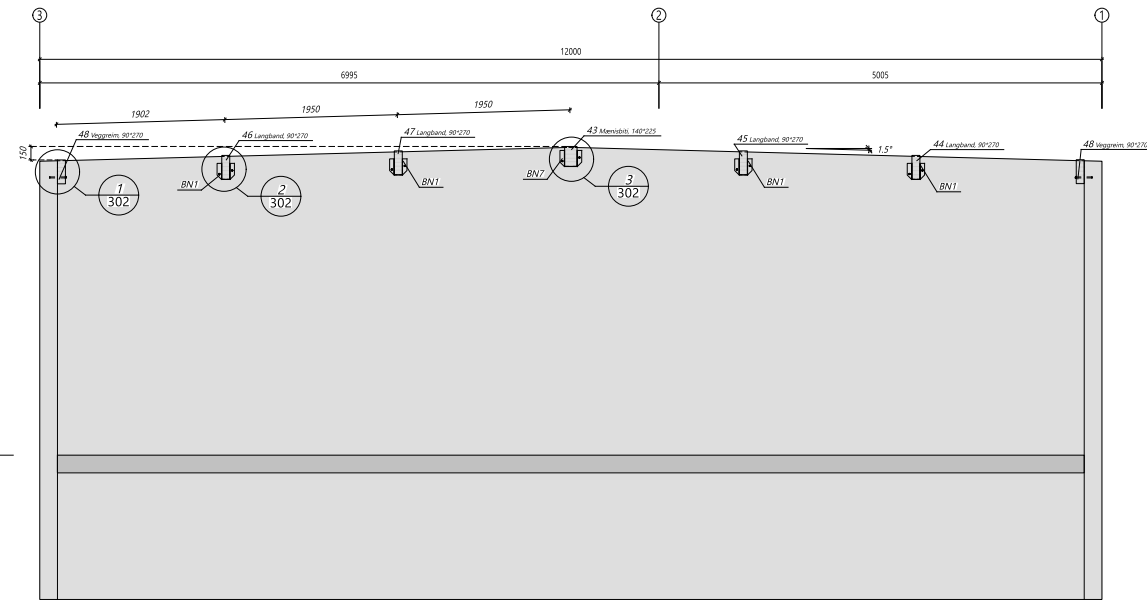

Þversnið A Mkv. 1:30

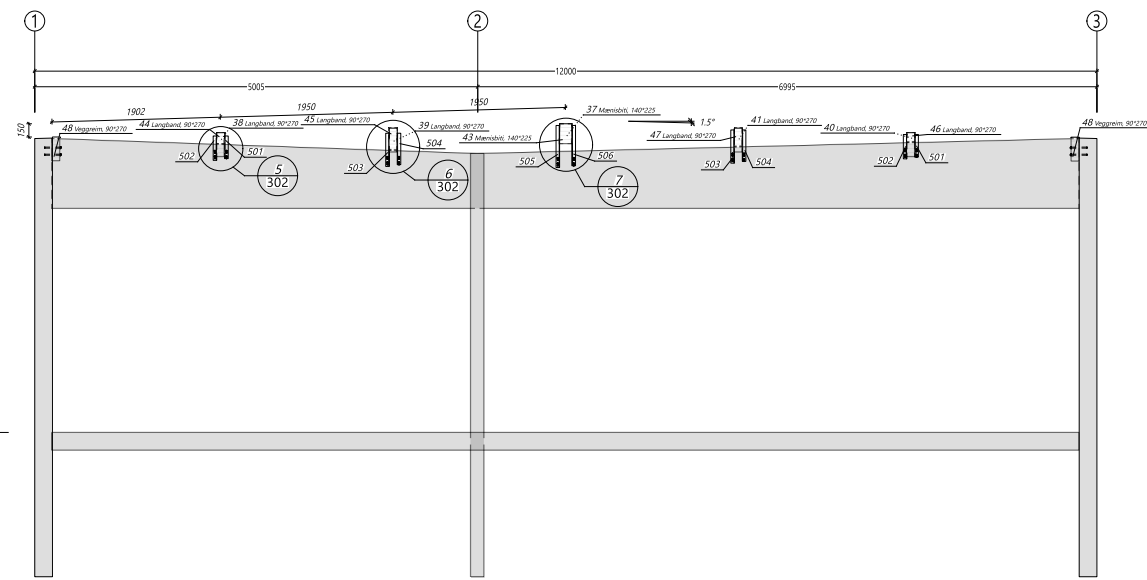

Þversnið B Mkv. 1:30

Skiptingar
Öll mál eru í mm nema annað sé tekið fram

ALMENNT

- Táknað hæð í sniðmynd
- Táknað hæð á plötu í grunnmynd
- Járnstærðir eru í mm
- Timburstærðir eru í mm
- Öll ónefnd mál eru í mm

ÁLAGSFORSENDUR

- Leyft álag á grunn.....: mN/m²
- Snjóálag.....: 1,26*µ kN/m²
- Vindálag.....: 2,07*µ kN/m²
- Notálag.....: kN/m²

TRÉVIRKI OG STÁLFESTINGAR

Límré skal vera í gæðaflokki GL30c
Samkvæmt ÍST EN 14080:2013
Límflokkur U (notaðhelti)
Aðrir burðarsúðir skulu ekki vera lakari en C18 samkvæmt ÍST EN 338:2009
Stálgæði í sérsníðubólum festingum eru S235 samkvæmt ÍST EN 10025-2:2004
Stálgæði í bolttum og teinum er ISO 8.8
Stálgæði í borðabólum er ISO 4.6
nema annað sé tekið fram.

Fúavegja skal spennu og aðra hluta tré sem steypast inn eða leggjast að steinsteypu.

Undir allar boltarar sem herðast að tré skal setja skinnur með kantlengd 3xd og þykkt 0,3xd (d er þvermál bolta).

Allir festihlutar gr stáli skulu galvanhúðaðir nema annað sé tekið fram á teikningu.

Þar sem bita/stoð kemur að hurð eða glugga skal setja 3 stk tréskruur 6.0x140/160mm bora skal fyrir skruflegg

Útg.	Dags.	Breyting	Br. af



Hétt vefs
Flúðaskóli
Endurnýjun þaks

Hétt teikningar
Þakmynd, þversnið A & B

Teiknað af	Málfróð	Teiknaður
ASJ	1.100.1.30	DL23 022
Verkið af	Dagsetning	Stig/Bl. n.
BI	19.04.2023	1

Nafn höfundar
Bjarni H. Ingibergsson
Byggingar- og tæknifræðingur
KE 050861-2729

301

Sérmynd 1
301 Mkv. 1:10

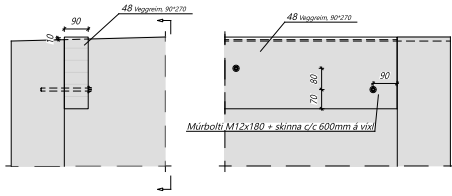

Sérmynd 2
301 Mkv. 1:10

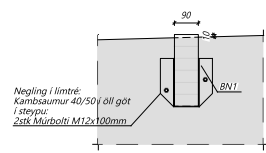

Sérmynd 3
301 Mkv. 1:10

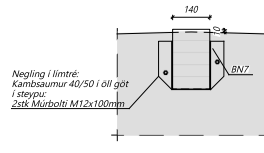

Sérmynd 5
301 Mkv. 1:10

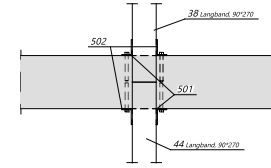
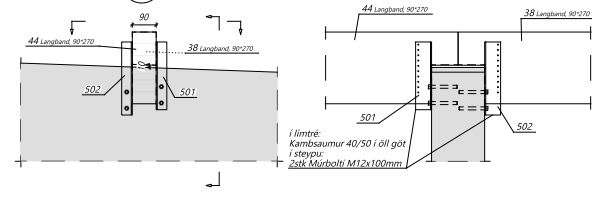

Sérmynd 6
301 Mkv. 1:10

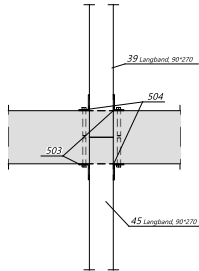
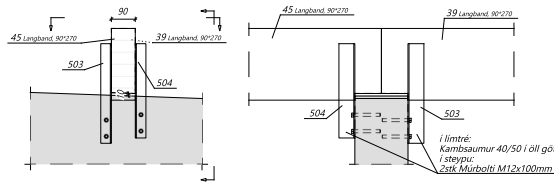

Sérmynd 7
301 Mkv. 1:10

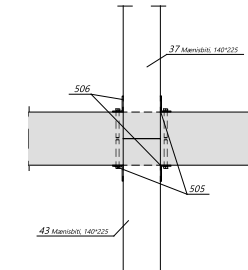
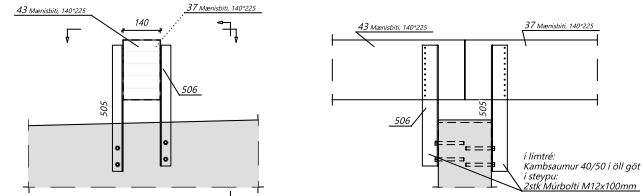

Skýringar
Öll mál eru í mm nema annað sé tekið fram.

Öll áhrif og áhrifur tekið tillit til í hild og hald en það skilfraga, kyfl, limtré/limtré átt.

Útg.	Dags.	Breyting	Br. af



ÚmtréVirnet
Byggingaáætt - Lynghólar 2 - 110 Reykjavík
Sí. 449510-1160 - Sími. 412 5100

Hétt verkefni
Flúðaskóli
Endurnýjun þaks

Hétt tekið myndir

Sérmyndir	
Teiknað af ASJ	Teiknað af DL23 022
Verkið af BI	Dagsetning 19.04.2023
Blátt höfundur Bjarni H. Ingibergsson Byggingar- og tæknifræðingur Kt. 030861-2729	Blátt höfundur Dags. arftakar

302

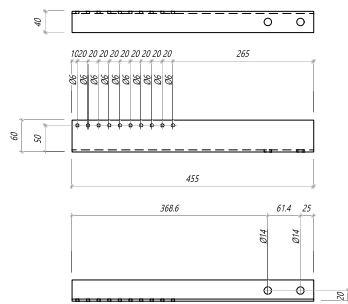

Nr. 506
 Prófill: L60*40*4
 Samtals: 14 stk.

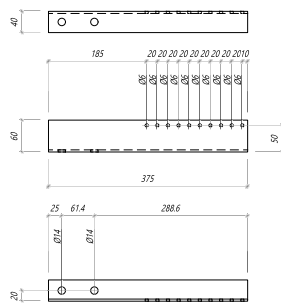

Nr. 503
 Prófill: L60*40*4
 Samtals: 28 stk.

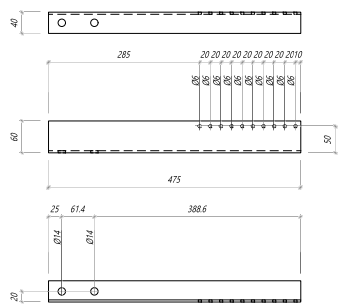

Nr. 505
 Prófill: L60*40*4
 Samtals: 14 stk.

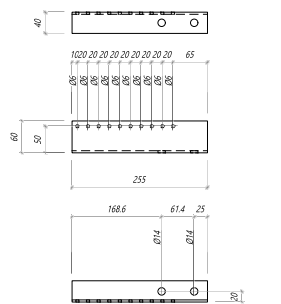

Nr. 501
 Prófill: L60*40*4
 Samtals: 28 stk.

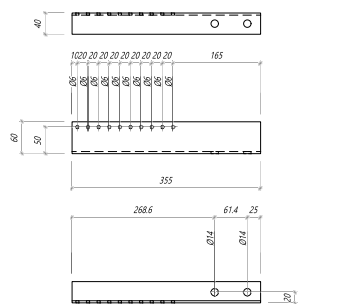

Nr. 504
 Prófill: L60*40*4
 Samtals: 28 stk.

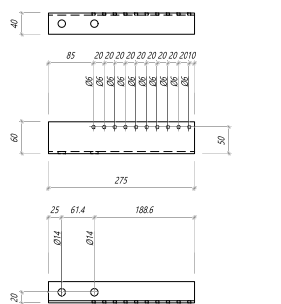

Nr. 502
 Prófill: L60*40*4
 Samtals: 28 stk.

Skýringar
 Öll mál eru í mm nema annað sé tekið fram

Útg.	Dags.	Breyting	Br. af
-	-	-	-

Byggingaæðild - Lyrngáhlú 2 - 110 Reykjavík
 Sí. 449510-1160 - Sími: 412 5100

Heiti vefs
Flúðaskóli
Endurnýjun þaks

Heiti tekiþingar
Stálfastingar - framleiðsluteikningar

Tekni af	Málfræði	Skilríki
ASJ	1:5	DL22 047
Vefur af	Dagsetning	Stig af m.
BI	19.04.2023	1

Nátt höfundur
 Bjarni H. Ingibergsson
 Byggingartæknifræðingur
 KT 030861-2729

Arnan höfundur
 Daga. arnar

361

361-001 Rúðskrá A1

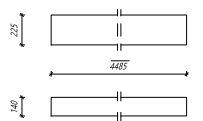

Nr. 1 Mænisbiti
 Límré: 140*225, L=4485 mm
 Samtals: 1 stk.

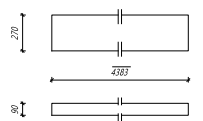

Nr. 6 Veggreim
 Límré: 90*270, L=4383 mm
 Samtals: 2 stk.

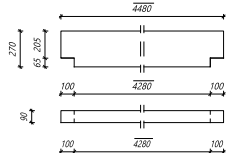

Nr. 11 Langband
 Límré: 90*270, L=4480 mm
 Samtals: 1 stk.

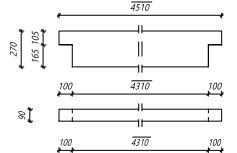

Nr. 16 Langband
 Límré: 90*270, L=4510 mm
 Samtals: 1 stk.

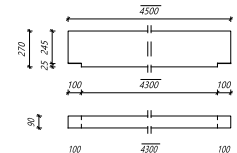

Nr. 21 Langband
 Límré: 90*270, L=4500 mm
 Samtals: 1 stk.

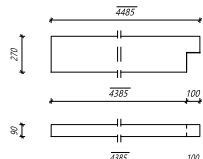

Nr. 2 Langband
 Límré: 90*270, L=4485 mm
 Samtals: 1 stk.

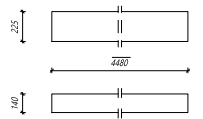

Nr. 7 Mænisbiti
 Límré: 140*225, L=4480 mm
 Samtals: 1 stk.

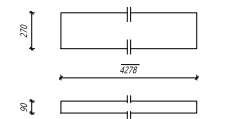

Nr. 12 Veggreim
 Límré: 90*270, L=4278 mm
 Samtals: 2 stk.

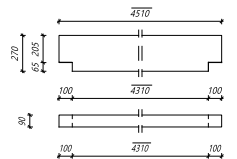

Nr. 17 Langband
 Límré: 90*270, L=4510 mm
 Samtals: 1 stk.

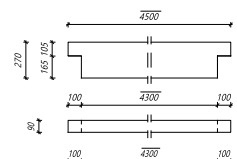

Nr. 22 Langband
 Límré: 90*270, L=4500 mm
 Samtals: 1 stk.

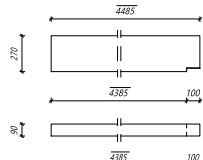

Nr. 3 Langband
 Límré: 90*270, L=4485 mm
 Samtals: 1 stk.

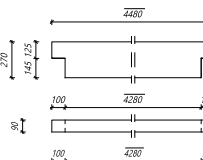

Nr. 8 Langband
 Límré: 90*270, L=4480 mm
 Samtals: 1 stk.

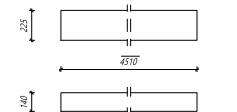

Nr. 13 Mænisbiti
 Límré: 140*225, L=4510 mm
 Samtals: 1 stk.

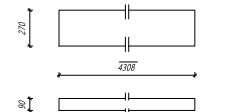

Nr. 18 Veggreim
 Límré: 90*270, L=4308 mm
 Samtals: 2 stk.

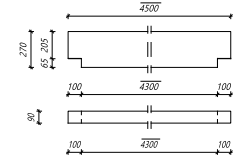

Nr. 23 Langband
 Límré: 90*270, L=4500 mm
 Samtals: 1 stk.

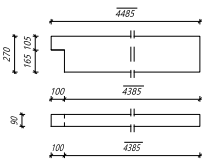

Nr. 4 Langband
 Límré: 90*270, L=4485 mm
 Samtals: 1 stk.

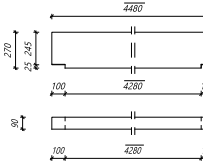

Nr. 9 Langband
 Límré: 90*270, L=4480 mm
 Samtals: 1 stk.

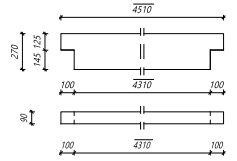

Nr. 14 Langband
 Límré: 90*270, L=4510 mm
 Samtals: 1 stk.

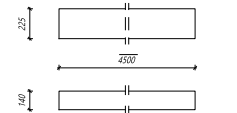

Nr. 19 Mænisbiti
 Límré: 140*225, L=4500 mm
 Samtals: 1 stk.

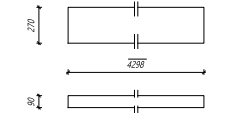

Nr. 24 Veggreim
 Límré: 90*270, L=4298 mm
 Samtals: 2 stk.

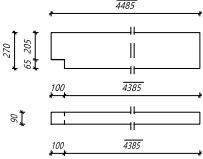

Nr. 5 Langband
 Límré: 90*270, L=4485 mm
 Samtals: 1 stk.

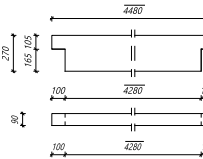

Nr. 10 Langband
 Límré: 90*270, L=4480 mm
 Samtals: 1 stk.

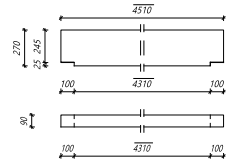

Nr. 15 Langband
 Límré: 90*270, L=4510 mm
 Samtals: 1 stk.

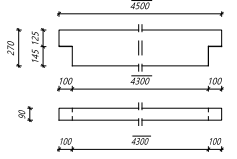

Nr. 20 Langband
 Límré: 90*270, L=4500 mm
 Samtals: 1 stk.

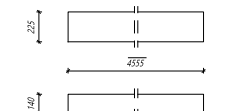

Nr. 25 Mænisbiti
 Límré: 140*225, L=4555 mm
 Samtals: 1 stk.

Skýringar
 Öll mál eru í mm nema annað sé tekið fram

Útg.	Dags.	Breyting	Br. af
<small>Byggingaáæð - Lyrghafni 2 - 110 Reykjavík Sí. 44510-1160 - Sími: 412 5100</small>			
Flúðaskóli Endurnýjun þaks			
Límré - framleiðsluteikningar			
Teiknað af	Málfrétt	Reykjavík	
ASJ	1:20	DL23 022	
Verkað af	Dagsetning	Skjalnúmer	Nr. teikningar
BI	19.04.2023	1	
<small>Nútt höfundur Bjarni H. Ingibergsson Byggingarteknikráðgjafi Kf. 050861-2729</small>			381
<small>Annar höfundur</small>			
<small>381-001</small>			<small>Rúðskrá Af</small>

Skýringar
Öll mál eru í mm nema annað sé tekið fram

Útg.	Dags.	Breyting	Br. af
 <small>Byggingaáæð - Lyrngahúsi 2 - 110 Reykjavík Sí. 449510-1160 - Sími: 412 5100</small>			
Heiti vefs			
Flúðaskóli			
Endurnýjun þaks			
Heiti tekiþingar			
Límtre - framleiðsluteikningar			
Teiknað af	Málfræði	Wélfræði	
ASJ	1:20	DL23 022	
Veitnað af	Dagsetning	Skjalnúmer	
BI	19.04.2023	1	
<small>Notk. höfundur</small> Bjarni H. Ingibergsson <small>Byggingartæknifræðingur</small> Kf. 050861-2729			382
<small>Arkunúmer</small>			<small>Dagp. arftar</small>
381-1002			Flúðaskóli

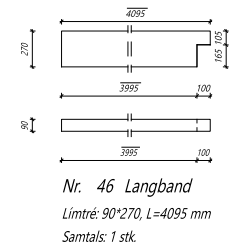

Nr. 46 Langband
Limtré: 90*270, L=4095 mm
Samtals: 1 stk.

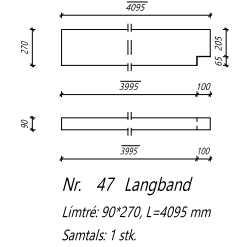

Nr. 47 Langband
Limtré: 90*270, L=4095 mm
Samtals: 1 stk.

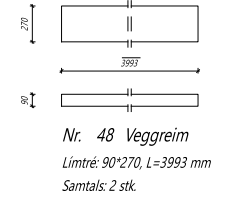

Nr. 48 Veggreim
Limtré: 90*270, L=3993 mm
Samtals: 2 stk.

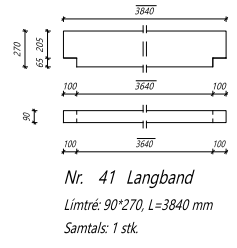

Nr. 41 Langband
Limtré: 90*270, L=3840 mm
Samtals: 2 stk.

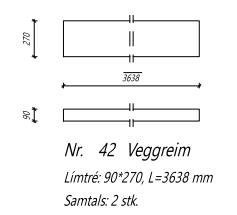

Nr. 42 Veggreim
Limtré: 90*270, L=3638 mm
Samtals: 2 stk.

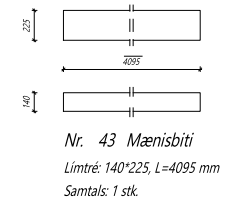

Nr. 43 Mænisbiti
Limtré: 140*225, L=4095 mm
Samtals: 1 stk.

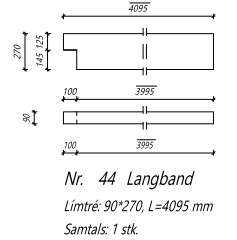

Nr. 44 Langband
Limtré: 90*270, L=4095 mm
Samtals: 1 stk.

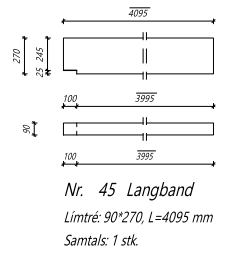

Nr. 45 Langband
Limtré: 90*270, L=4095 mm
Samtals: 1 stk.

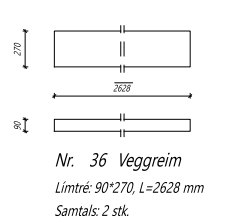

Nr. 36 Veggreim
Limtré: 90*270, L=2638 mm
Samtals: 2 stk.

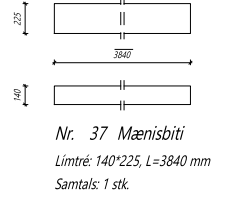

Nr. 37 Mænisbiti
Limtré: 140*225, L=3840 mm
Samtals: 1 stk.

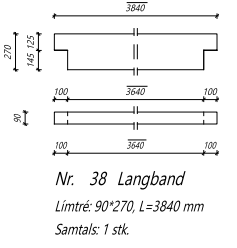

Nr. 38 Langband
Limtré: 90*270, L=3840 mm
Samtals: 1 stk.

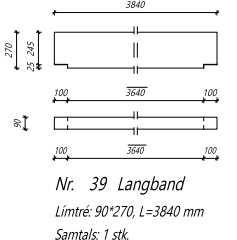

Nr. 39 Langband
Limtré: 90*270, L=3840 mm
Samtals: 1 stk.

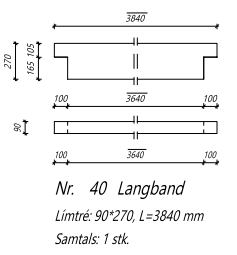

Nr. 40 Langband
Limtré: 90*270, L=3840 mm
Samtals: 1 stk.

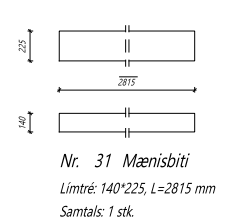

Nr. 31 Mænisbiti
Limtré: 140*225, L=2815 mm
Samtals: 1 stk.

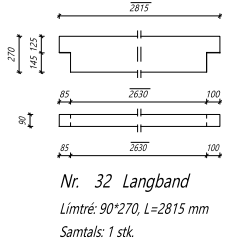

Nr. 32 Langband
Limtré: 90*270, L=2815 mm
Samtals: 1 stk.

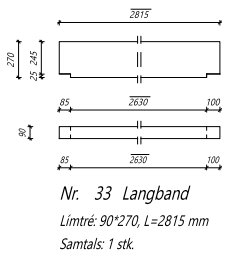

Nr. 33 Langband
Limtré: 90*270, L=2815 mm
Samtals: 1 stk.

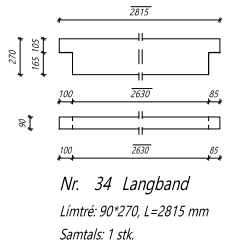

Nr. 34 Langband
Limtré: 90*270, L=2815 mm
Samtals: 1 stk.

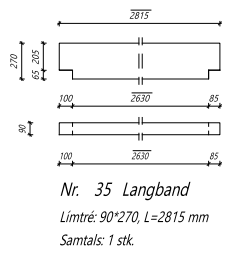

Nr. 35 Langband
Limtré: 90*270, L=2815 mm
Samtals: 1 stk.

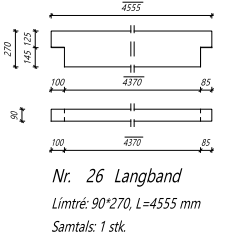

Nr. 26 Langband
Limtré: 90*270, L=4555 mm
Samtals: 1 stk.

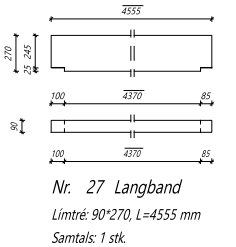

Nr. 27 Langband
Limtré: 90*270, L=4555 mm
Samtals: 1 stk.

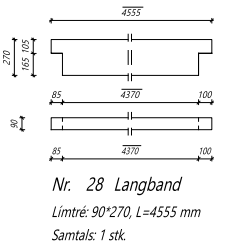

Nr. 28 Langband
Limtré: 90*270, L=4555 mm
Samtals: 1 stk.

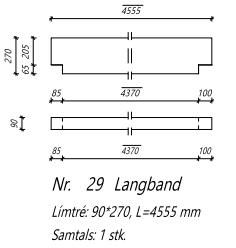

Nr. 29 Langband
Limtré: 90*270, L=4555 mm
Samtals: 1 stk.

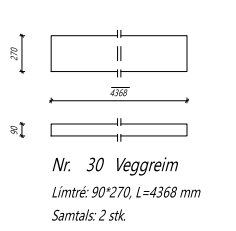

Nr. 30 Veggreim
Limtré: 90*270, L=4368 mm
Samtals: 2 stk.