

MÖTTEKIÐ
12. FEB. 2008
Rannsóknir

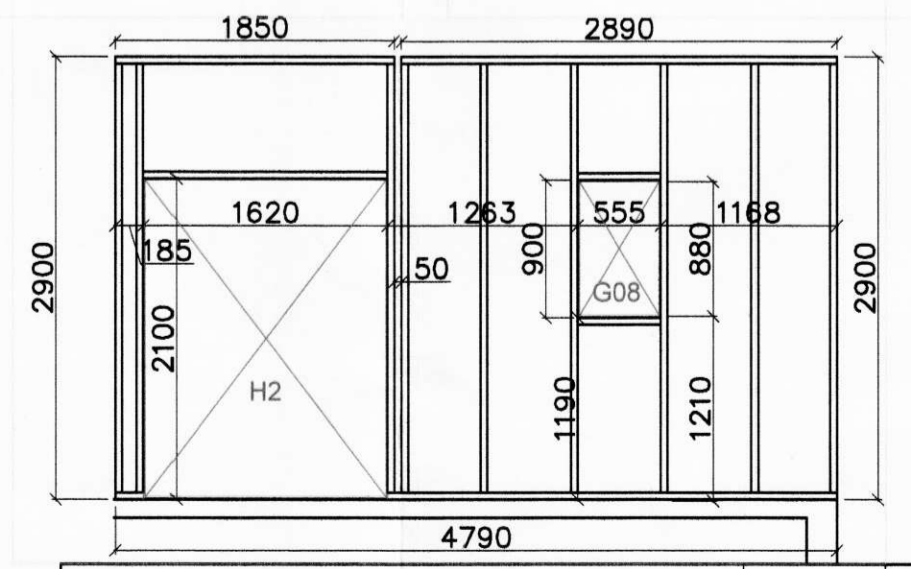
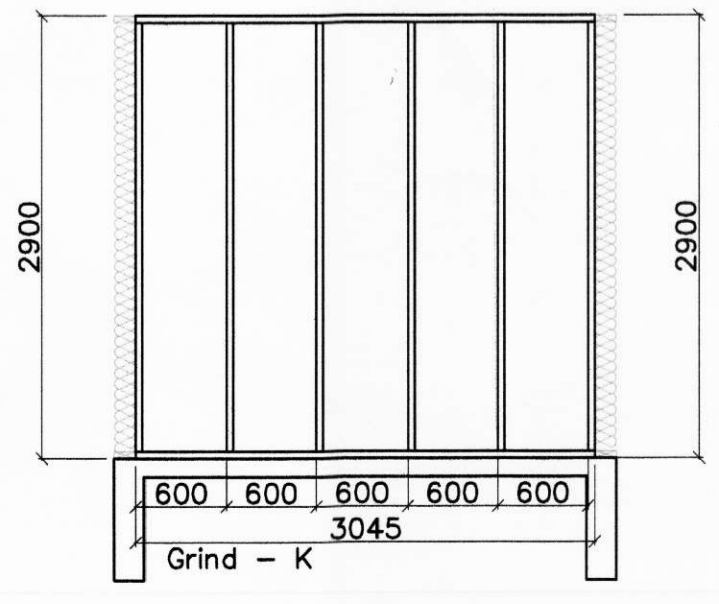
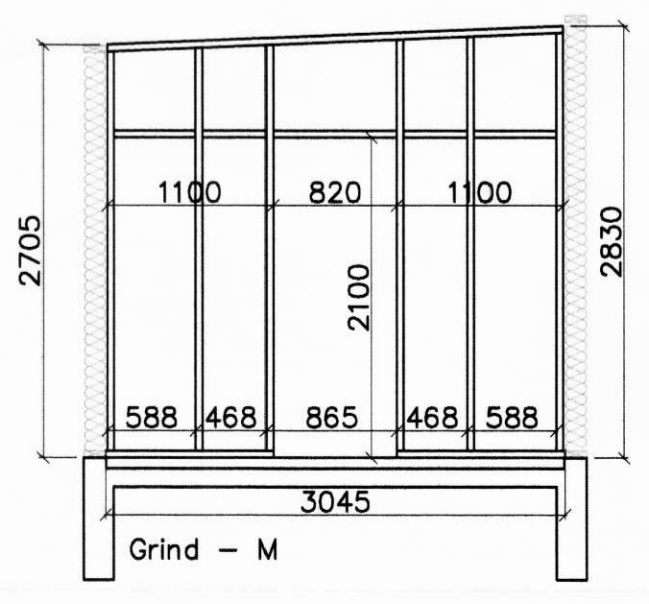
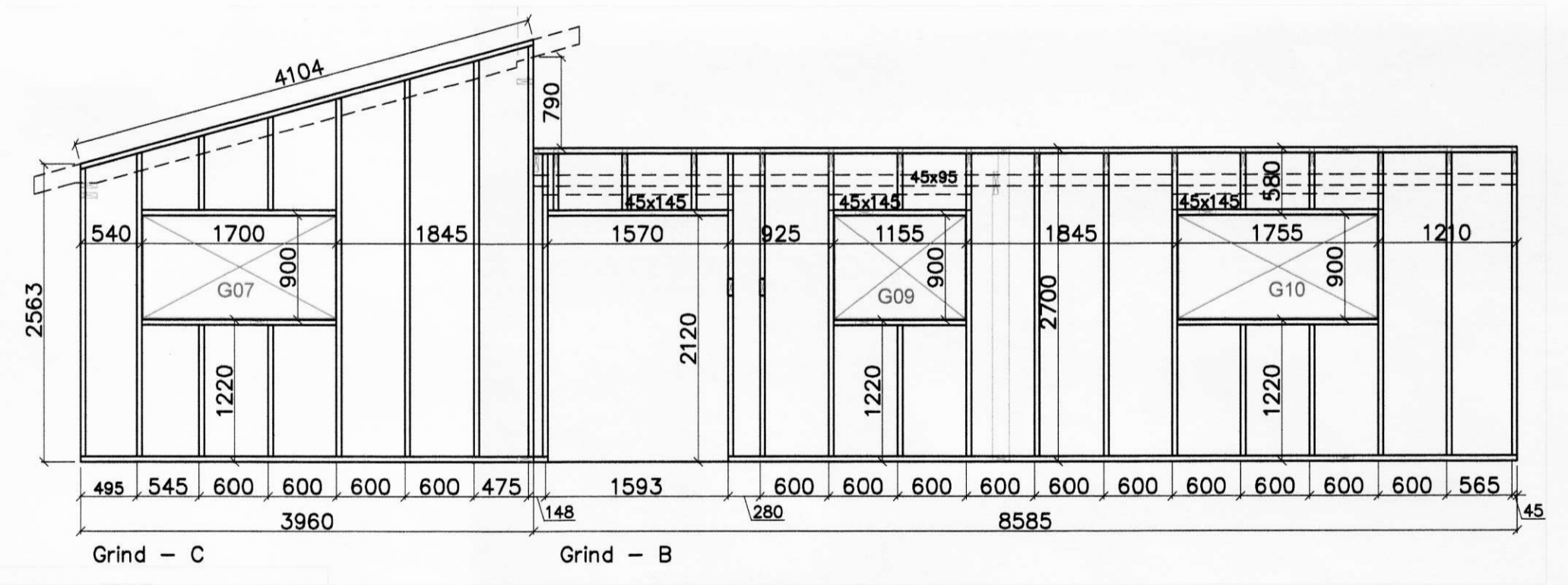
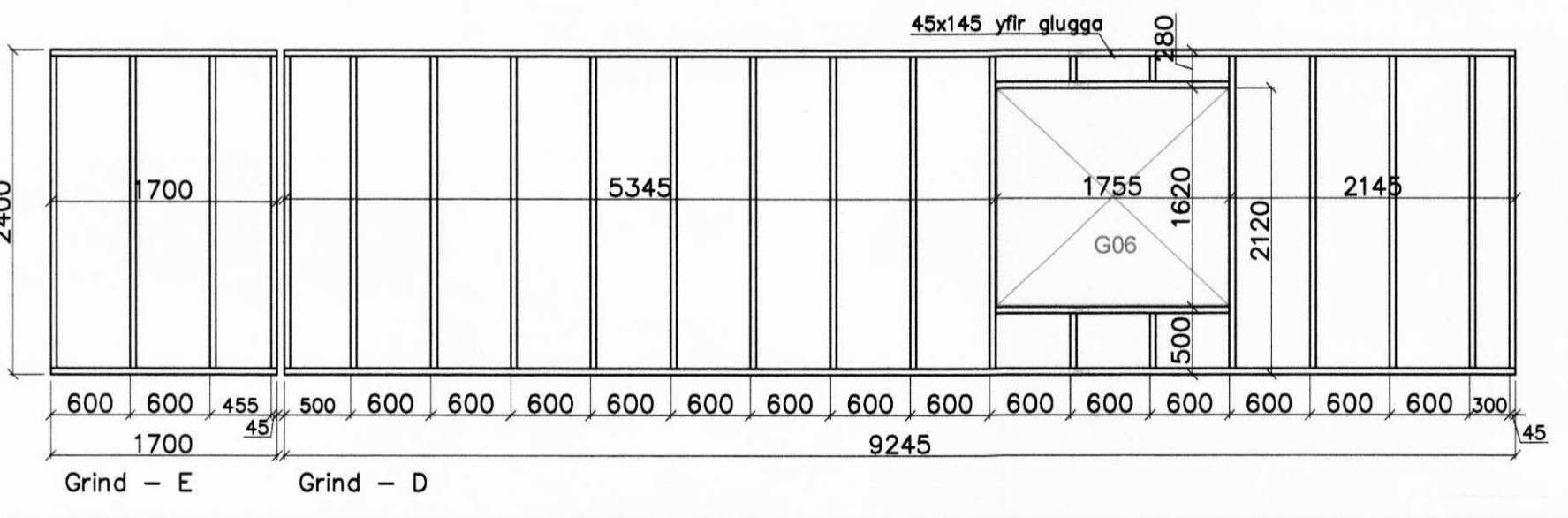
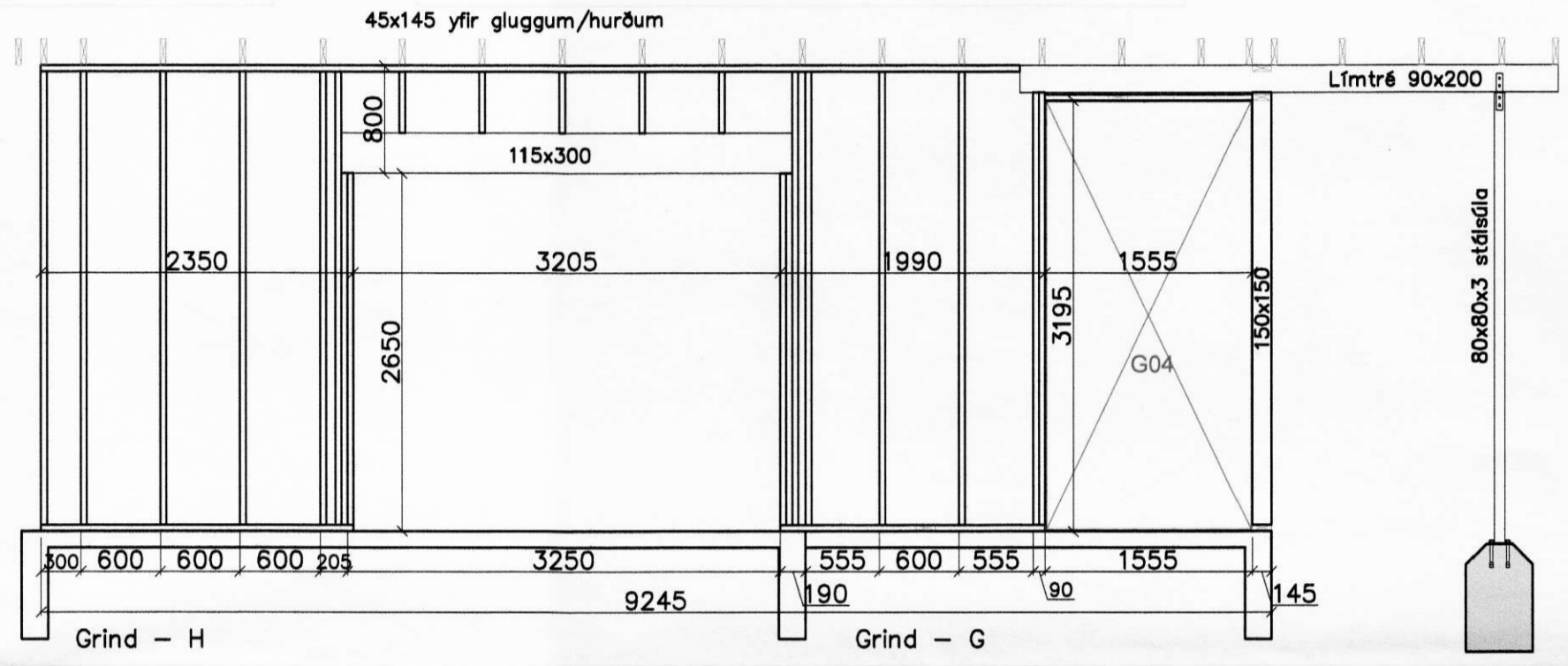
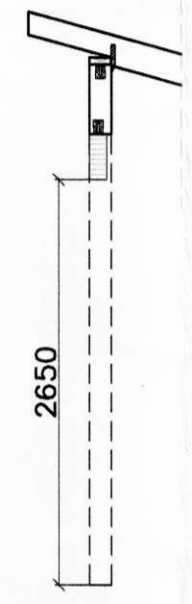
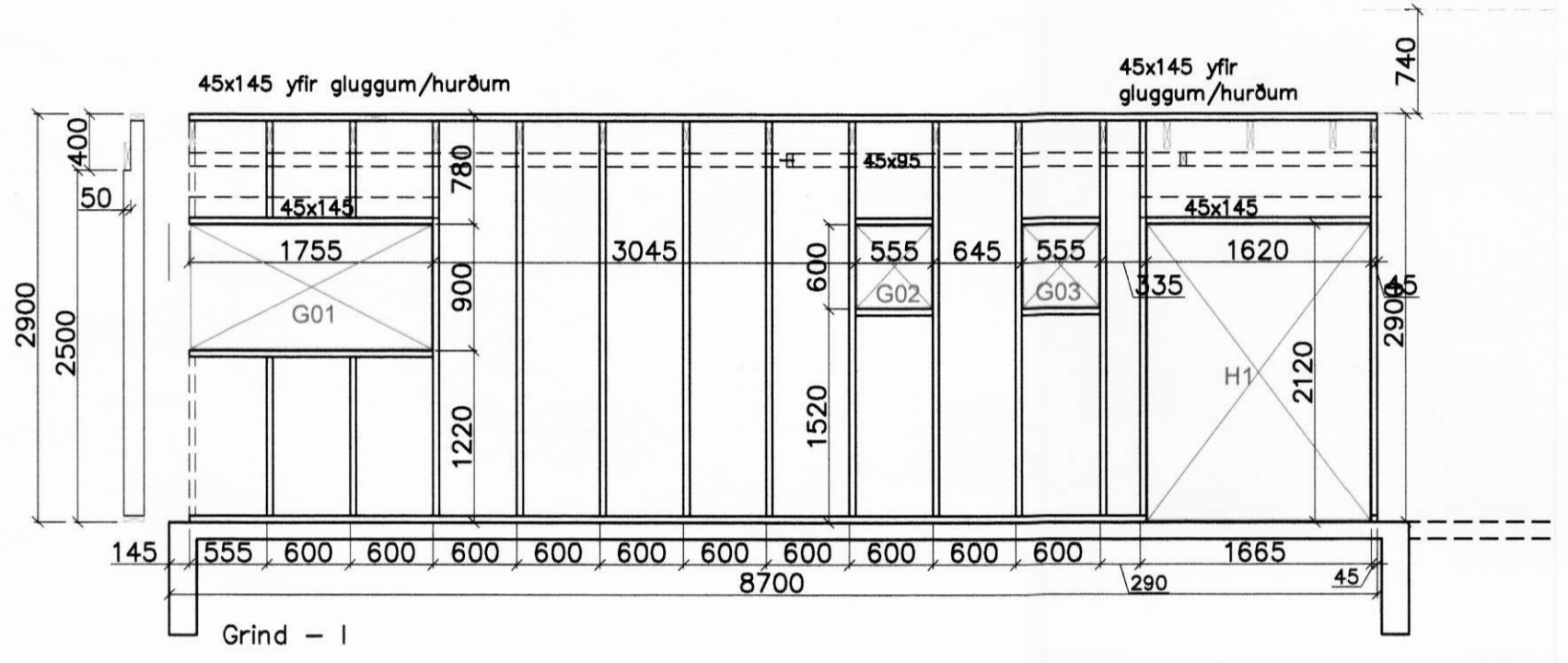
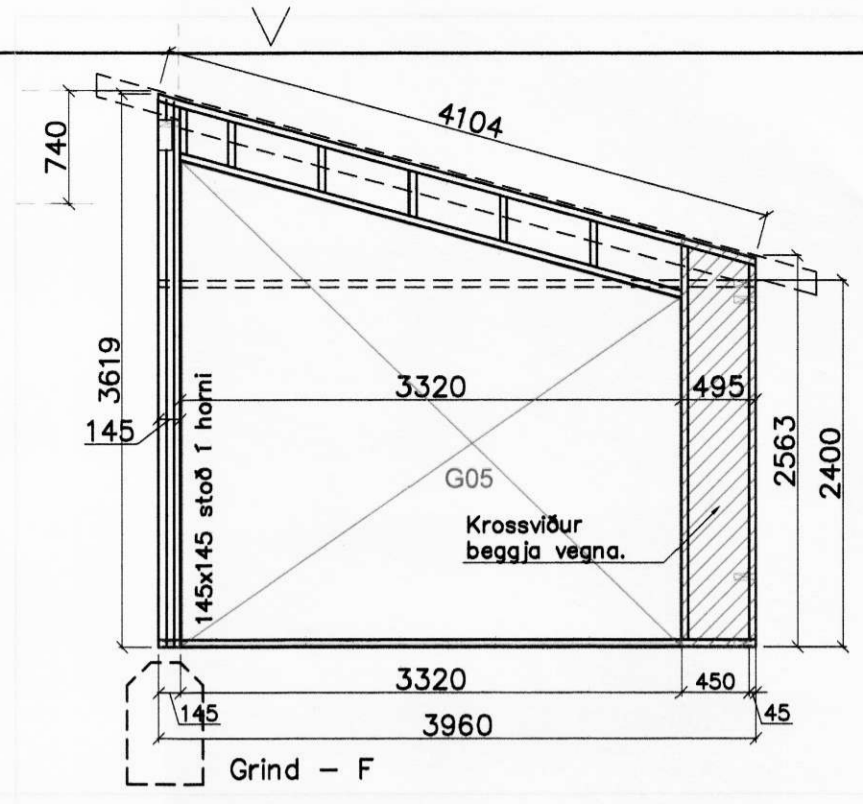
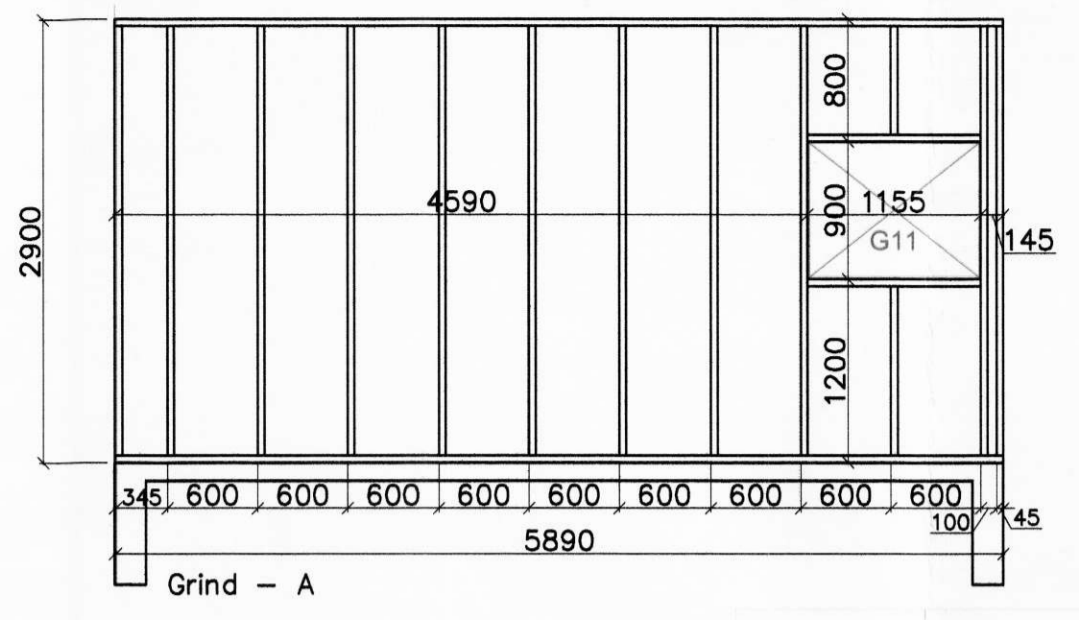
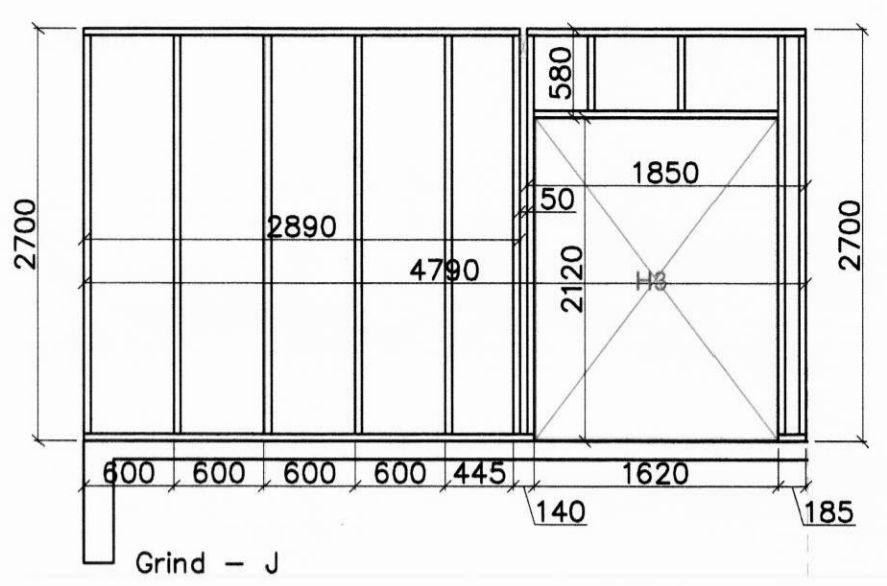

| Eðli breytingar | Af. | Sp. | Dags. | Br. |
|--|-----|-----|------------|-----|
| Geymsla, pak, hæð á veggjum og innra skipulag. | SMS | | 31.01.2008 | A |
| | | | | |
| | | | | |

| | | | | |
|--|--------------------|----------|--------|------------|
| Swavar M. Sigurjónsson ByggingartekniFræðingur kt. 180867-3419 | | | | |
| Verk: Íbúðarhús Hárlaugstöðum Ásahrepp | | | | |
| Burðarvirki | | | Mkv: | |
| Veggjagrindur | | | Mkv: | 1:50 |
| Skýringar | | | Mkv: | |
| Hannað: | S.M.S. | Teiknað: | S.M.S. | Yfirfarið: |
| Dags: | 16.09.2007 | Verknr: | 06-18 | Teikn.nr: |
| Sampykkt: | <i>Swavar M.S.</i> | | | |